

Section 19A

CLASSIC AND ANTIQUE 1929-on

Motor and Transmission

45-UL-Knuckle-Panhead-Pan/Shovel

Motor

Transmission

Cam Cover 33 to 36

Case Parts

BT 1940-57 12

BT 1958-on 14

BT Cam cover.....33-35

Connecting Rods.....11

Cylinders/Hardware9,30,44

Flywheels

BT 1940-57 13

BT 1958-on 15

45 Models 22-25

Knuckle 27-32

Oil Pump16-21

Pan Motor 2-10

Pistons 38

Pushrods 36-37

UL 26-27

Valve Train 37, 39

Clutch 50

45 Models 45-52

Shifter 40-43

For BT transmission see Section 2A



Preston Cycle's 1939 UH

Panhead Motor

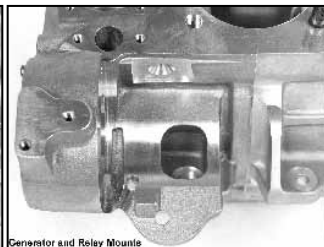

V-TWIN Replica Case Sets

Case sets feature original style fitments including, left side number boss, which is left blank for original numbers with manufacturer's numbers on the right underside. Sets have generator strap mount tab and relay boss as required. Main bearing races are line lapped. The following components are pre-installed: cam bushing or bearing, left case race or Timken assembly, idler gear std, circuit breaker stud, oil pump drive bushing, right case bushing, cylinder base studs, dowel pins, case bolt set.

PCP	Application	Bearings
58071	1941-47 Knuckle	Roller
58072	1948-52 Pan (solids)	Roller
58069	1953-54 Pan	Roller
58073	1956-57 Pan	Timken
58074	1958-62 Pan	Timken
58075	1963-64 Pan	Timken
58076	1965 Pan	Timken
58077	1966-67 Pan/Shovel	Timken
58096	1968-69 Shovel	Timken



V-Twin engines offered by Preston Cycle are on a special order basis only.



V-TWIN 74" Replica Pan Motors

Motors feature cases and replica style heads with stock exhaust ports. 1948-54 style features plumber intake manifold and 1955-64 style has an o-ring intake manifold.

PCP	Application	Finish
99102	1948-54	Chrome
99103	1948-54	Alloy
99104	1955-61	Chrome
99105	1955-61	Alloy



S&S 1936 to 1947 Knucklehead Equipped Engines

For 1936 to 1964 chassis with sheet metal primary chain cover requiring cast iron H-D oil pump mounted with 1/4-20 bolts or S&S oil pump #31-6250.

310006 Stock cylinder with stock dimension spigots

1955 to 1964 Panhead Equipped Engines

For 1948 to 1964 chassis with sheet metal primary chain cover requiring cast iron oil pump mounted with 1/4-20 bolts or S&S oil pump #31-6250.

310008 Stock cylinder with stock dimension spigots

1965 to 1969 Panhead/Shovelhead Equipped Engines

For 1965 to 1969 chassis with cast aluminum primary chain cover requiring cast iron oil pump mounted with 1/4-20 bolts or S&S oil pump #31-6250.

310010 Stock cylinder with stock dimension spigots

Panhead Motor

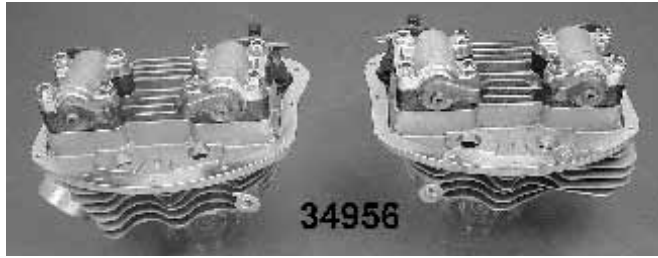

34956

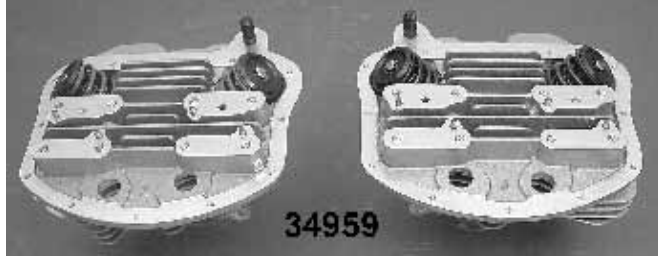

34959

Replica 1948-65 "Shop Ready" Panheads

Features original contour castings with the added detail of the stock intake and exhaust port areas and are assembled with cast iron guides, valve stem seals, oilers and nitrated valves Pan exhaust, Shovel intake in combination with a complete spring and collar set. Matched rocker arm assemblies installed with heat treated studs, nuts and oilers. Fully assembled and ready to install. Order original plumber style or o-ring type intake manifold style. PCP# 34956 accepts outside overhead oil line also available without rocker arm assemblies.

Full Asbly	Heads w/Valves	Year	Intake
34954	34957	1948-54	Plumber
34955	34958	1955-62	O-ring
34956	34959	1963-65 (OHO)	O-ring



1948-65 Panhead Rocker Arm Assembly Kit

Includes all pieces to completely assemble the rocker arms on both heads. Includes 4 rocker arm assemblies with matching fitted rocker arms, heat treated studs and lock nuts, intake oiler tubes and dowel pins. 30034



Cylinder Head Motor Brace Mounting Kit

Accurately reproduced studs, nuts, and washers used to mount motor brace to cylinder head.

PCP	Description
72368	1948-65 Pan, parkerized
72369	1948-65 Pan, cadmium
72370	1966-84 Shovelhead

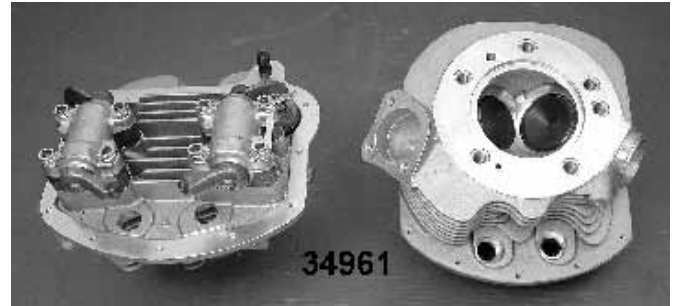

34961

V-T "Shop Ready" Panheads

Are assembled with STD heads, cast iron guides, valve stem seals, nitrated valves Pan exhaust, Shovel intake in combination with a complete spring and collar set. Matched rocker arm assemblies installed with heat treated studs, nuts and oilers. Ready to install. Available to accept late Shovel intake manifold and with stock or 3-bolt flange at exhaust area.

PCP	Year	Exhaust
34960	1948-65	Stock
34961	1948-65	3-bolt

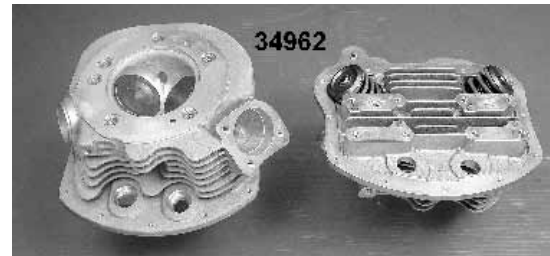

34962

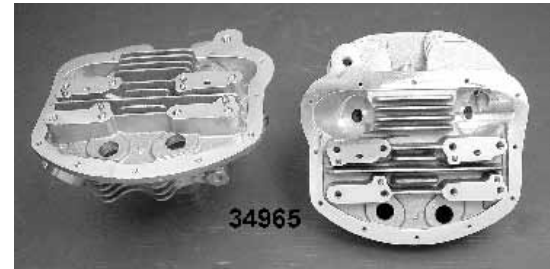

34965

VT Panheads

Pair accepts Pan or Shovel barrels and Shovel header pipes except PCP #34965 which accepts stock header clamps. Heads feature internal oiling, o-ring intake port to accept manifold as pictured, drilled for late external oilers, valve seats installed. Head bolts not included. Also available as complete assemblies that include valve job, valves, guides, springs, collars and guide seals cleared for cams up to .550 lift. When using panhead barrels use 2 short headbolts in positions by intake port.

Assembled Pair

PCP	Plug	Ex Port
34962	Single	3-bolt
34963	Single	Stock

Bare Heads

34964	Single	3-bolt
34965	Single	Stock

'74 OHV Motor Mount 1948-65

Chrome with Linkert Choke Bracket welded on.

4492	16853-48
------	----------



Panhead Motor

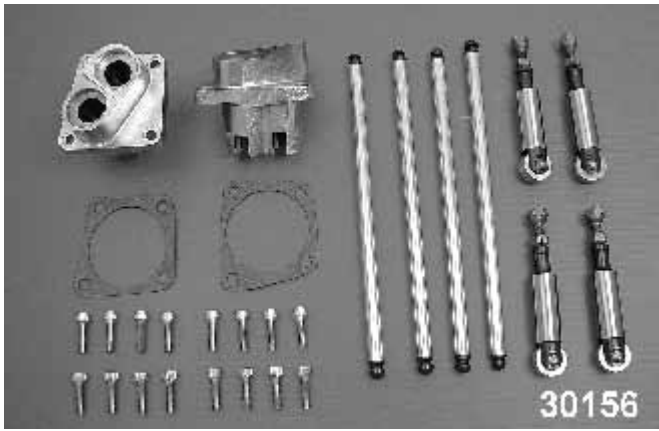

Panhead Stock Solid Lifter Kit

Includes lifters with adjuster screw, pushrods and lifter blocks.

PCP	Years	Finish
30155	1948-65	Chrome
30156	1948-65	Zinc



1948-53 Replica Solid BT Alloy Lifter Block Kit

Includes 4 solid tappets with adjuster screws and lock nuts.
59574 Natural finish



Motor Builder's Cam Chest Kits by Gary Bang

Kits include internal Big Twin replacement type parts. Cam bearings and bushing kit are not included.

PCP	Application
30025	Knuckle BT OHV 1936-47
30026	Panhead BT OHV 1948-53
30027	Pan-Shovel BT OHV 1954-69



Gary Bang Lifter and Pushrod Assembly

Complete assembly includes 4 hydraulic lifter tappets, 4 hydraulic lifter units, 4 pushrods and a lifter base. (Shovel blocks)

PCP	Application
30029	Panhead 1953-65, chrome
30030	Panhead 1953-65, zinc

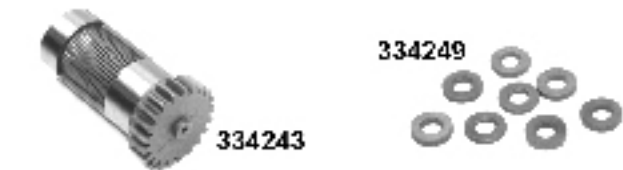

BT Steel Breather Gear and Valve Gear Kits

Machined breather valve and gear by S&S. Designed to replace the stock steel or plastic OEM parts. Offered in stock duration only in stock O.D. and +.030 oversize (for use in worn or damaged breather holes). Washers are also available separately in sets.

PCP	OEM	Description
334243	25300-36	Gear only, Std size 1936-47
334245		Gear only, +.030 1936-47
334249		Washer set, 8pc, 39-99



Left Bearing End Oil Slinger

PCP	Fits
11820	1940-54 BT (24776-40)



Motor Sprocket Nut Kit

Includes correct nut, key retaining ring and left bearing oil slinger.

PCP	Fits
12634	1930-54 BT

Panhead Motor



Chrome Panhead "D" Rings

Thick aluminum "D" rings and steel "D" rings to fit all original equipment pan covers as well as any of the aftermarket offerings.

PCP	Finish	Size	Material
3993	Chrome	Thick	Aluminum w/screws
16507	Chrome	Thin	Steel (17541-48)
19870	Zinc	Thin	Steel (17541-48)
19868	Chrome	Thin	Aluminum (17509-54A)
19867	Polished	Thick	Aluminum (17509-54A)
19877	Cast	Thick	Alloy



Replica Stainless Steel Panhead Valve Covers

Covers feature the original shape for exact fitment. Replaces 17500-48.

- 19796 Stainless steel
- 19797 Chrome



- 5324 Chrome Plated. Use with Steel "D" Rings
- 5325 Cad Plated. Use with Steel "D" rings



Panhead Valve Cover Screws

Exact duplicate of special screws used on all Harley Panhead valve covers 1948-1965.

- 5321 Chrome, use with aluminum "D" rings
- 5323 Cad, use with aluminum "D" rings
- 5326 Chrome allen screws for aluminum "D" rings
- 5327 Chrome allen screws for steel D rings
- 1755 Chrome acorn style
- 2874 Chrome cap style



Steel Panhead Valve Covers

Covers feature the original shape for exact fitment. Replaces 17500-48.

- 912 Chrome Pan cover (17500-48)
- 19871 Chrome Pan cover, Paughco (17500-48)
- 19872 Aluminum Pan covers (17500-48)
- 19869 Chrome ribbed cover, Paughco

Chrome Valve Cover Washers (not shown)

Duplicate of washers used under hold down screws on 1954-65 Panhead (6150W).

- 9984 Chrome
- 9985 Cad



Oversized Panhead Valve Cover Screws

Stock style screws with oversized 1/4-20 threads to be used for stripped heads on 1948-65 Panheads. 6 Screws per kit.

Chrome	Cad	Application
72013	72014	Use with aluminum D rings
72015	72016	Use with steel D rings

Panhead Top End

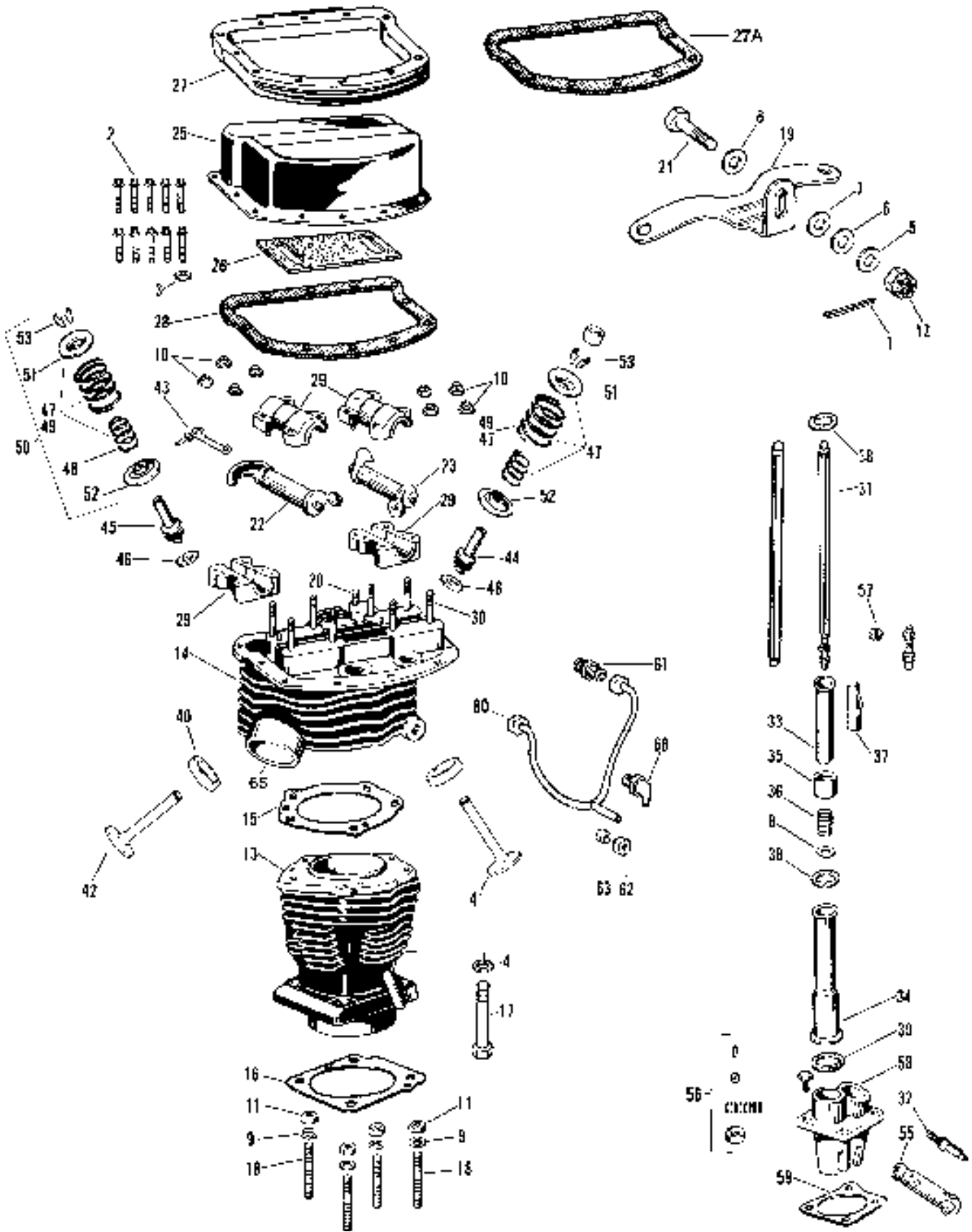

Panhead Top End 1948-65

#	PCP	OEM	Description				
1	20092	531	Cotter pin 3/32 x 7/8 (100 pk)	34	1818	17938-48B	Lower push rod cover (4 pc)
2	5323	3578W	Cad hex screw 10-24 x 1-1/4 (24 pc)	35	2002	17945-36B	Cup, cover spring (4 pc)
3	9985	6150W	Cad washer for above (24 pc)	36	13101	17947-36	Spring, push rod cover (10 pc)
4	5200	6469	Cad head bolt washers (10 pc)	37	2001	17950-48	Retainer, spring cap (4 pc)
8	13557	6762B	Push rod spring washer (10 pc)	38	25043	17955-36	Small push rod cork (10 pc)
9	5201	7055	Cad lockwasher (8 pc)		79268	17955-36	James, as above (100 pk)
10	12506	7727	Nut 5/16 x 24 flexloc (8 pk)	39	25044	17955-48	Large push rod cork (10 pc)
11	2154		Chrome as above		79104	17955-48	James, as above (100 pk)
13	177	16485-55	Front cylinder w/internal oil line	40	N/A	18057-48	Valve seat int & exh (no lead)
15	79210	16770-48	Gasket, cylinder head (10 pk)	41	353	18071-48	Intake valve
16	25023	16776-48	Gasket F/cylinder 48-62 (10 pk)	42	352	18082-52A	Exhaust valve
	79231		James as above (10 pk)	43	4102	18100-49	Oiler, front intake valve
	79232		Gasket, F/cylinder 63-84 (10 pk)		4106	18102-49	Oiler, rear intake valve
	25025	16777-48	Gasket, R/cylinder 48-62 (10 pk)	44	17616	18163-48	Valve guide, intake STD
	79233		James as above (10 pk)				(See guides for more options)
	79234	16777-63	Gasket, R/cylinder 63-84 (10 pk)	45	17660	18188-48A	Valve guide, exhaust STD
17	1820	16814-48	Cad headbolt/washers (20 pc)				(See guides for more options)
	5214		As above, chrome (20 pc)	46	79090	18196-51	J/gasket, valve guide (20 pk)
18	5472	16831-30	Studs, cylinder base (8 pk)	47	902053	18201-57B	S&S Spring set w/top collars
19	4492	16853-48	Bracket, motor mount	50	32015		Complete valve spring kit
20	10817	16864-48	Stud, cylinder head motor brace	51	30004	18221-36	Collar, upper valve spring (4 pk)
22	2333	17360-48	Rocker arm, R/exh., F/intake	52	30001	18222-48	Collar, lower valve spring lower (4 pk) 1948-79
23	2334	17375-48	Rocker arm, F/exh., R/intake	53	30012	18228-36	Valve key (8 pk)
25	912	17500-54	Chrome rocker arm cover set		30023		Valve key (8 pk)
26	25035	17507-48	Pad, rocker arm cover (pr)	55	1084	18522-53A	Hydraulic tappet with roller STD
27	3993	17509-54A	Chr/alloy "D" rings (no screws)	56	15614	18534-29A	Tappet roller kit (each)
27A	16507		Chr/steel "D" rings (no screws)		15622		As above, set of 4
28	79265	17541-48B	Thick gasket, cover (10 pk)	59	79270	18633-48A	Gasket, .031 tappet guide rear cylinder (10 pk)
	25042		Thin gasket, cover (10 pk)		79273	18634-48A	Gasket, .031 tappet guide front cylinder (10 pk)
	79266		James as above (10 pk)	60	3845	62780-63	Chrome rocker feed oil line 1963-65
29	3379	17611-48A	Rocker block assembly R/exh. and F/intake		21008		As above, raw finish
	3381	17611-48A	Rocker block assembly F/exh. and R/intake	61	10572	63526-57	Fitting, oil line 1963-65 (5 pk)
30	10906	17647-48	Stud, rocker arm block (8 pk)	62	20110	63527-57	Nut, oil line 1963-84 (4 pk)
31	1701	17905-53B	Push rods 1948-52 solid (set)	63	14073	63529-57	Rubber seal 1963-84 (10 pk)
	1766	17905-53B	Push rods 1953-65 (set)		79459		James as above (25 pk)
32	29003	17920-53	Push rod, hydraulic unit	64	10593	63542-63	Elbow, oil line 1963-65
	34511		As above, Crane	65	16505		Exhaust manifold repair 48-65 (weld-on) (pr)
33	1808	17935-48B	Upper push rod cover (4 pc)				

Stock O.E.M. Style

PCP	Application
2160	BT 1936-69 chrome
5192	BT 1936-69 cad
9621	BT 1936-69 parkerized
9794*	BT 1936-69 chrome 1/4-20
9795*	BT 1936-69 cad 1/4-20
9796*	BT 1936-69 parker. 1/4-20
9305	Shovel 1970-80 chrome
9306	Shovel 1970-80 cad

*Note: Special thread for aftermarket 1/4-20 cases

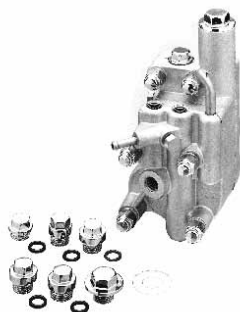

12 Point Head Bolt Kits

These are chrome plated and include washers. The big bore types allows wrench clearance on 1948-84 Pan & Shovels.

PC #	OEM #	Model	Years
5305*	16814-48	BT 74-80	1948-84
3582*	Black Oxide	BT 74-80	1948-84

* Install these bolts with a 7/16" 12 pt. box Wrench.



Panhead 1948-65



Cylinder and Piston Kits

Cylinders are honed and pre-fitted with stock compression cast pistons and Hastings rings. They are ready to run and will require break-in as suggested in the appropriate shop manual. Sold in pairs for stock stroke only. Order gasket set separately.

PCP	Application	Compression
53059	1948-65 Panhead	8.5:1
53060	1966-78 74" Shovelhead	8.5:1

AV&V Stainless Steel Valves

These valves are heat treated and nitride processed for excellent wear resistance. These valves feature a 45 degree angle, cut below the lock groove to reduce stress in this area, as well as making valve seal installation easier.



Panhead Valves 1948-65

PCP	Valve	Head Diam.
31664	Exhaust	1.750"
31664	Intake	1.750"

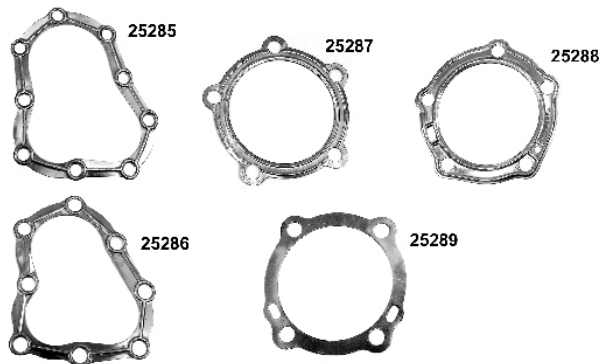

Copper Gaskets

PCP	Application
25285	Head gasket F/H 1936-48 (16769-36) (pair)
25286	Head gasket 45" (16769-39) (pair)
25287	Head gasket EL 1936-48 (16770-36C) (pair)
25288	Head gasket Pan 1948-65 (16770-48C) (pair)
25289	.022 Head gasket XL L1973-85 (16769-73) (pair)



Panhead Finned Accessories

These are cast replicas. Panhead fins are to be used with thin D-rings, Glide drum fins on FL 1948-66 front drums, and oil filter fins for canister type filter 1948-on, (you must supply the original parts).

45075	Panhead fins (pair)
45076	Drum cooler ring
45077	Oil filter body fins

Big Twin Engine Stand

Perfect for Harley Engine repair. This bench stand works on all Big Twin engine cases 1936-up.

2831	Big Twin pre EVO
31432	Sportster 57-on

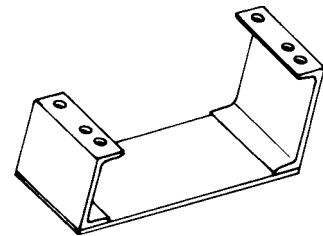

AV&V Valve Seats

These valve seats are made from heat and wear resistant high quality alloy steel, and are manufactured with clear identification markings and radius edges for easy installation. These seats will resist intense valve pounding and effectively dissipate heat for constant valve sealing. These valve seats will increase in hardness during engine break-in period.

Panhead Oversized Valve Seats

Machining required.

PCP	Valve	O.D.	I.D.	Thickness
31784	Exhaust	1.944"	1.570"	.400"
31785	Intake	2.135"	1.750"	.400"

Panhead 1200cc Oversized Valve Seats

Machining required.

PCP	Valve	O.D.	I.D.	Thickness
31782	Exhaust	2.021"	1.590"	.420"
31786	Intake	2.163"	1.750"	.455"

Flywheels



Complete Flywheel Assembly By V-Twin

Flywheel is fully assembled trued and includes shafts.

PCP	OEM	Application
58009		45" 1929-73
58042		BT 80" SV 41-48
58000	23906-41	BT 74" OHV 41-53
58044	23907-54A	BT 74" 1954
58047	23907-55A	BT 74" 1955-57
58001	23906-58	BT 74" 1956-64
58004	23906-65A	BT 74" 1965-69

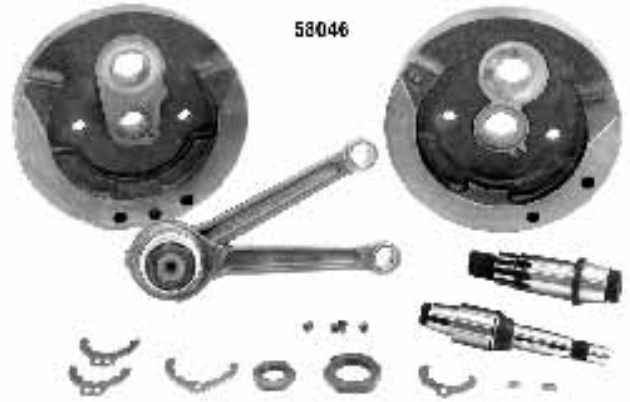

BT 4-1/4" Stroker Kit

Top quality stroker kit made in Japan

58045	1958-64
58046	1965-69



Upper and Lower Motor Mount Kit 1936-69

Complete stock motor mount kit for Harley O.H.V.'s 1936-1969 features special length, heat treated bolts, castle nuts and cotter pins, and heavy duty washers. Offered in choice of chrome or cad plating.

2156	Chrome plated
5199	Cad plated
5415	Lower motor mount kit Big Twins 1930-1936 and all 45's, cad plated

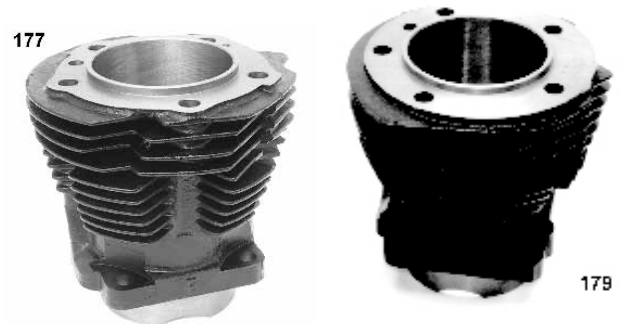

Cast Alloy Iron Replacement Cylinders

PCP	OEM	Model	Type	Year
4835	16483-36	61"Knuckle	Front	1936-47
4837	16490-36	61"Knuckle	Rear	1936-47
4833	16483-41	74"Knuckle	Front	1941-47
4841	16491-41	74"Knuckle	Rear	1941-47
177	16485-55	74"Panhead	Front	1948-65
176	16492-55	74"Panhead	Rear	1948-65
179	16484-66	74"Shovelhead	Front	1966-78
178	16492-66	74"Shovelhead	Rear	1966-78



Motor Mount Kit BT 1936-64

This custom top motor mount kit features chrome plated, flanged nuts and heavy chrome plated washers.

1777	Top Kit
1776	Lower Kit

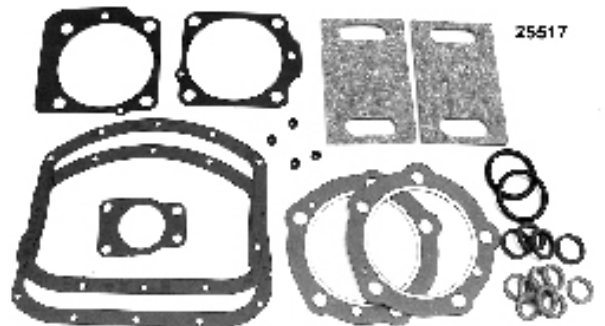

Preston Pan-Shovel Motor Gasket Kits

PCP	Application
25517	Top end gasket set Pan 61", 74" 1948-65
25518	Top end gasket set Shovel 1966-84
25500	Engine set Pan 61", 74" 1948-65
25501	Engine set BT Shovel 74" 1966-69

Gaskets

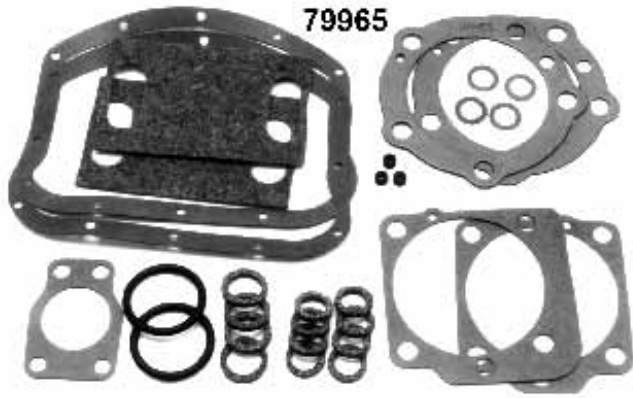

James Top End Gasket Kits (Pre-Shovel)

PCP	OEM	Description
79959	17031-40	45" Flathead 1940-73 w/copper
79960	17033-36	74 & 80 Flathead 1936-48 w/blue teflon
79964	17034-38	E, EL 1941-47 w/blue teflon
79965	17034-48	FL 1948-65 w/blue teflon
79966	17034-48-X	FL 1948-65 w/fire ring

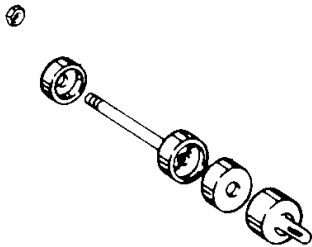
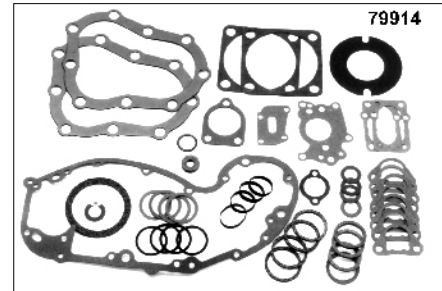
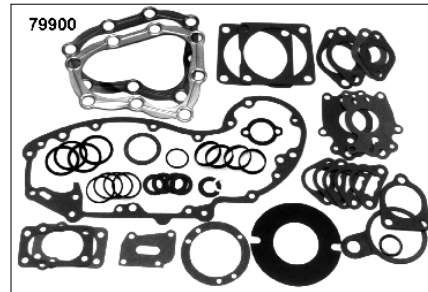
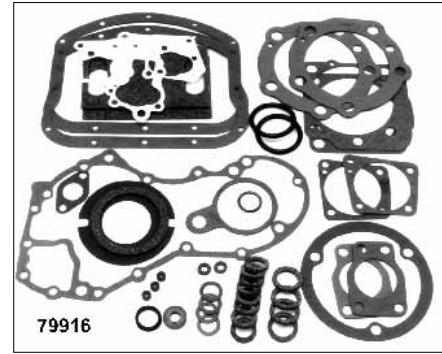

AUTHENTIC

Primary Breather Tubes and Stud Kits

Kit includes all parts pictured: 24925-58 spacer, 24914-58 stud, 24922-58 collar, 24923-58 cap and 24918-58 rubber nipple, for 1958-63 Big Twin.

PCP	OEM	Application
19309	24912-48	Tube 1948-57
19308	24918-64	Snoot 1936-57
17500	Shown above	Complete Kit BT 1958-64
1379	24918-58	Oil Nipple ONLY BT 1958-64

James Motor Gasket Kits

PCP	OEM	Description
79900	17026-40	45" Flathead 1940-73 w/copper head
79901	17026-52	K model 1952-1956
79914	17027-36	74 & 80 Flatheads 1937-48 w/blue teflon
79915	17028-36	61 & 74 1936-47 w/blue teflon
79916	17028-48	FL 74" 1948-65 w/blue teflon



Timing Plugs

Quality reproduction of stock timing plug. Offered in choice of polished and chrome plated or cad plated.

1481	FL1952-69 chrome 3/4 hex (704)
8115	As above, cad
9502	BT 1939-51 chrome 7/8 hex (2326-38)
9503	As above, cad

New functional and custom design plug fits all models Harley Big Twin and Sportster timing plug holes and oil tanks with 5/18-18 drain hole. Oil fill on 45's to 1940.

3591	Chrome Plated
5282	Cad Plated
5283	Black Oxide



Panhead 1/8" Fibre Paper Gaskets

Sold in pairs for BT 1948-65.

25245

Rod Components



Wrist Pin Bushings

Sold in pairs. Bronze OEM type

PCP	Jims	Size	Fits
18507	31354	STD	BT 36-99 (24334-36)
18597		.002	BT 36-99
18508	31355	.005	BT 36-99
18509		.010	BT 36-99 (24335-36)
18504	31352	STD	45's 36-on (24331-36)
18598		.002	45's 36-on
18505	31353	.005	45's 36-on
18599		.010	45's 36-on (24332-36)



Preston Stock Replacement Rod Sets

Include new rods, crank pin nuts cages and standard rollers. Piston pin bushings are installed and honed for stock wrist pin.

PCP	OEM	Year	Model
34000*	24277-36	36-51	61" Pan-Knuckle (Step pin)
34001*	24281-41A	41-73	74" Pan-Shovel
34007*	24275-32	32-73	45 Model

*Note: Rod sets includes steel rod roller cages



Connecting Rod Race Sets

Rod Races are designed for extreme pressure. Made from 52100 steel and hardened.

PCP	Model	Year
977	Big Twin	1936-99
1048	Flathead 45"	1929-73



Crank Pins

Crank Pins available from U.S.A. makers, Eastern, Jims, OEM and Taiwan. American pins are made of 8620 steel, with .062 heat treat penetration.

Note: All crank pins have one or three oil holes.

PC#	OEM	Model	Holes/Brand
976	23962-40	61-80 1940-52	3 Eastern
31136	23961-41	BT 1941-E81	1 Jims
31137	23961-41	BT 1941-E81	3 Jims
975	23961-41	BT 1941-E81	3 Eastern
1049	23960-29	45 1936-73	1 Eastern



Connecting Rod Roller Sets

Each set supplies enough rollers for that application only.

Early	Big Twins	Flathead	Size
	1941-72	1929-54	
	2744	15130	STD
	2745	--	0002 OS
	2746	--	0004 OS
	2747	15131	0006 OS
	2748	--	0008 OS
	2749	15132	001 OS
	5269	--	002 OS
	3529	--	003 OS

Connecting Rod Cage Set

Constructed of iron and made to fit BT 74" & 80" OHV 41-81.

344010	S&S
31047	Jims
10721	Preston



Rod Bearing Sets with Cages

Set of cages fitted with standard size Torrington rollers for connecting rods. Cage material noted!

PCP	OEM	Cage	Model	Year
15850	24385-40B	Alloy	74 & 80	1941-86
15840	24370-52B	Alloy	Sportster	1952-E86
15030	24370-29	Steel	45 STD	1929-73
15031	24371-29	Steel	45 .0002	
15034	24374-29	Steel	45 .0008	

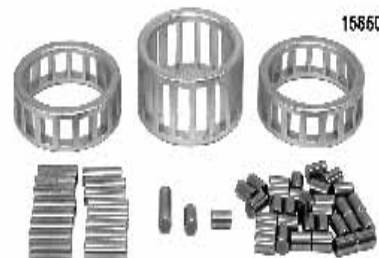

1940-57 Big Twin

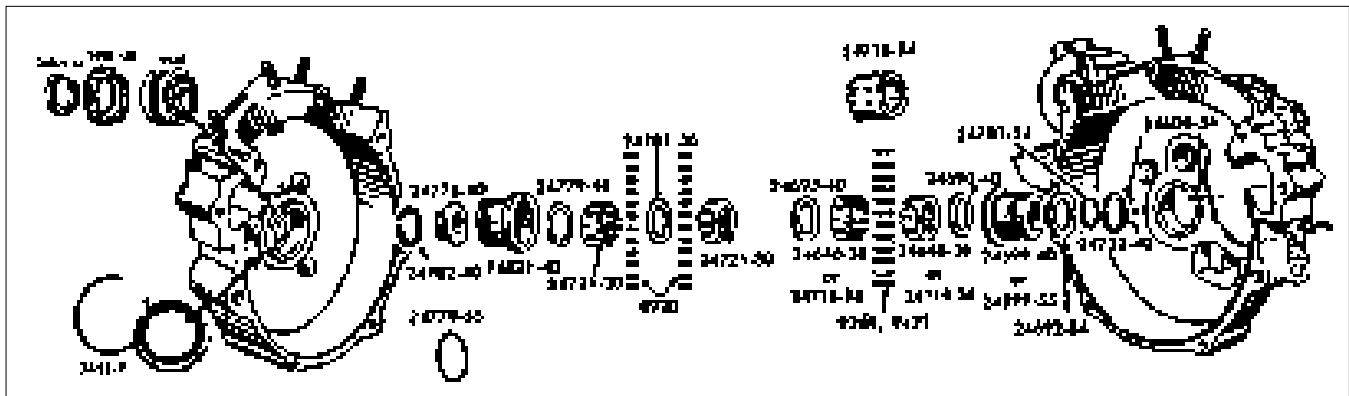

PCP	OEM	Description	Years	U/M	PCP	OEM	Description	Years	U/M
1754		Seal & Ring	36-54	Each	2732	24595-40	R/Bushing S/V STD	40-48	Each
2734	413-30	R/Case Bush	30-36	Each	2733	--	R/Bushing S/V .005	40-48	Each
2735		As above +.005	30-36	Each	954	24599-40	R/Bushing STD	40-54	Each
18500	-	R/Case Bush .005	30-36	Each	955	24601-40	R/Bushing .005	40-54	Each
2736	416-30	R/Case Bush	30-36	Each	1006	24599-55	R/Bushing STD	55-57	Each
2737	416-30	L/Case Bush .005	30-36	Each	1007	24601-55	R/Case Bushing .005	55-57	Each
15516	9029	L/Case Bearing	55-68	Each	1008	--	R/Case Bushing .010	55-57	Each
957	9220	L/Rollers STD (24)	30-54	Set	24505	24608-54	Screw, Bushing	54-78	10 Pack
958	9221	L/Rollers .0002	30-54	Set	946	24621-40	L/Case Bushing STD	36-54	Each
959	9222	L/Rollers .0004	30-54	Set	947	24623-40	L/Case Bushing .005	36-54	Each
960	9223	L/Rollers .0006	30-54	Set	10726	24646-36	R/Roller Retainer	37-53	Each
961	9224	L/Rollers .0008	30-54	Set	11817	24690-40	R/Bearing Washer	40-53	Each
962	9225	L/Rollers .001	30-54	Set	11818	24692-54	R/Bearing Washer	54-57	Each
963	9261	R/Rollers STD (12)	37-54	Set	11819	24695-40	R/Bearing Spacer	40-54	Each
964	9262	R/Rollers .0002	37-54	Set	11054	24701-54	R/Bearing Ret. Ring	54-56	10 Pack
965	9263	R/Rollers .0004	37-54	Set	11055	24702-40	Crank Bearing Ring	40-52	5 Pack
966	9264	R/Rollers .0006	37-54	Set	10728	24718-54	R/Roller Retainer	54-57	Each
967	9265	R/Rollers .0008	37-54	Set	10729	24721-30	L/Roller Retainer	30-54	Each
968	9266	R/Rollers .001	37-54	Set	11820	24776-40	L/Bearing End	40-54	Each
1012	9421	R/Rollers STD (13)	55-57	Set	11821	24779-40	L/Bearing Washer	40-54	Each
1013	9422	R/Rollers .0002	55-57	Set	11057	24779-55	L/Bearing Ring	55-68	Each
1014	9423	R/Rollers .0004	55-57	Set	11822	24781-36	L/Bearing Spacer	37-54	Each
1015	9424	R/Rollers .0006	55-57	Set	10904	24912-48A	Stud & Oiler	48-57	Each
1016	9425	R/Rollers .0008	55-57	Set					
1017	9426	R/Rollers .001	55-57	Set					
11801	24029-55	Spacer .336	55-64	Each					
1753	24031-55	Seal and Nut	55-68	Each					

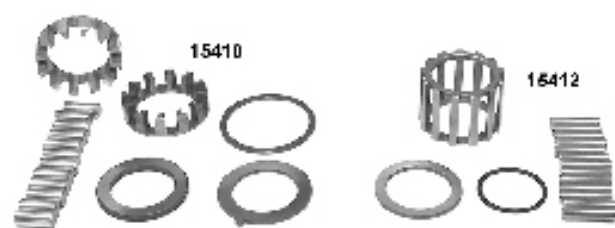

These Steel Bushings are Jims-USA

PCP	OEM	Description	Years	U/M
31058	24595-40	R/Bushing S/V STD	40-48	Each
31062	24599-40	R/Bushing STD	40-54	Each
31063	24601-40	R/Bushing .005	40-54	Each
31066	24599-55	R/Bushing STD	55-57	Each
31067	24601-55	R/Case Bushing .005	55-57	Each
31078	24621-40	L/Case Bushing STD	40-54	Each
31079	24623-40	L/Case Bushing .005	40-54	Each

Pinion Bearing Sets

Bearing set for right side that includes rollers and cages. Snap rings and washers when required except for 45 models.

PCP	Application
15410	BT 74" & 80" 1936-54
15411	BT 74" & 80" 1958-86
15412	XL 1954-76
15415	45 STD (rings and washers not included)
15416	45 .0002 (rings and washers not included)
15417	BT 61" & 74" 1955-57
Sprocket Shaft Cage/Bearing and hardware kit	
15414	BT 1941-54

Flywheels BT 1940-57

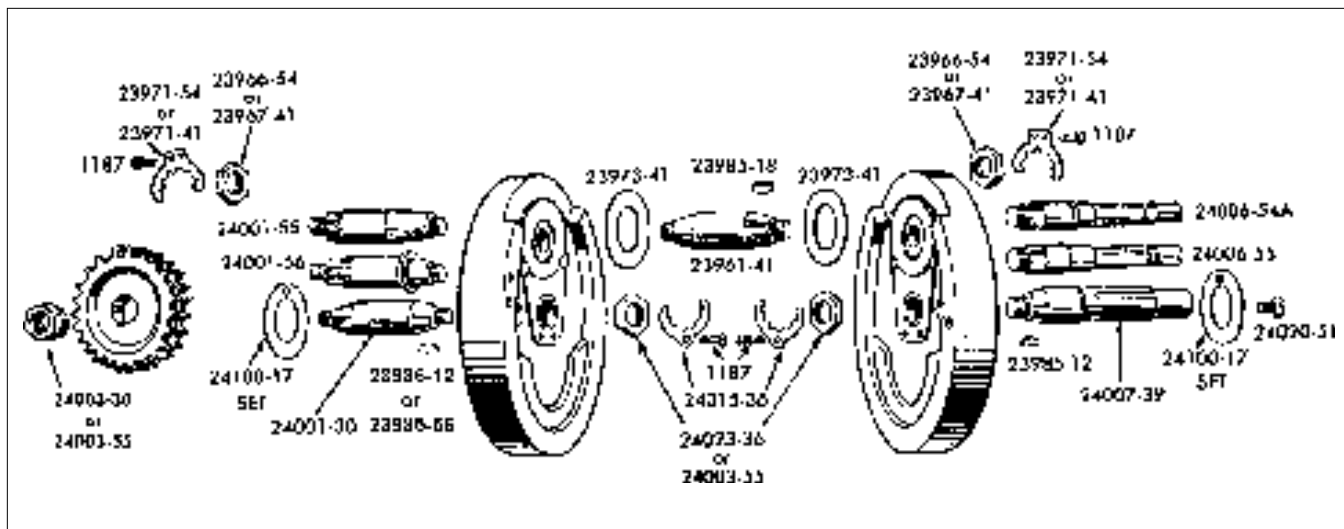

PC #	OEM #	Description	Years	U/M	PC #	OEM #	Description	Years	U/M
24500	1187	Screw Lock Washer	40-on	10 Pk	970	24001-30	Sprocket Shaft	30-54	Each
975	23961-41A	Crank Pin 3 Hole	41-E81	Each	1024	24001-55	Sprocket Shaft	1955	Each
976	23962-50	Step C/Pin 61-80 OHV	40-52	Each	1025	24001-56	Sprocket Shaft	56-64	Each
12532	23966-36	Crank Pin Nut 61"	36-52	Pair	12537	24003-30	Nuts Motor Sprocket	30-54	Each
12599	23966-54A	Crank Pin Nut (2)	54-81	Pair	12538	24003-55	Nuts Motor Sprocket	55-69	Each
13703	23971-41	Crank Pin Lock Tab (2)	41-53	Pair	30142	24006-37	Pinion Shaft BT S/V	37-48	Each
13704	23971-54	Crank Pin Lock Tab (2)	54-80	Pair	1032	24006-54A	Pinion Shaft	55-57	Each
19570*	23972-36	Washer .055 (steel)	36-52	Pair	1030	24007-39	Pinion Shaft	39-54	Each
19571*		Washer .060 (steel)	36-52	Pair	13706	24015-36A	Lockwasher (2)	36-52	5 Pk
11526	23973-41	Washer, Steel STD (2)	41-69	Pair	24504	24020-51	Pinion Screw L.H.	51-53	Each
11527	-	Washer, Bronze +.005	41-69	Pair	12543	24023-36	Pin/Sprocket Nut (2)	36-E81	Each
10304	23985-12	Key, Pin/Sprocket (2)	41-E81	10 Pk	11530	24100-17	Thrust Washers .066 to .102	29-54	11 Pcs
10305	23985-18	Crank Pin Key (2)	41-E81	10 Pk					
10307	23985-56	Sprocket Key	56-71	10 Pk					

*Note: Rod thrust washer BT 36-52 & S/V 37-48



Jim's Machining Motor Nuts

PCP	OEM	Description	Model
31003	23966-36	Crank pin nuts (pair)	BT 1936-52
31004	23966-54A	Crank pin nuts (pair)	BT 1954-E81
31008	24017-80	Sprocket shaft nut (each)	BT 1972-85
31009	24023-36	Pinion shaft nut (each)	BT 1930-E81



Motor Sprocket Nut

Original replacement style for 1930-54 Big Twins.
12537



Jims Machining-Made in USA

PCP	OEM	Description	Years	U/M
31136	23961-41	Crank Pin 1 Hole	41-E81	Each
31137	-	Crank Pin 3 Hole	41-E81	Each
31146	23962-40	Step C/Pin 61 OHV	40-52	Each
31205	24001-30	Sprocket Shaft	30-54	Each
31206	24001-55	Sprocket Shaft	1955	Each
31207	24001-56	Sprocket Shaft	56-64	Each
31243	24006-37	Pinion Shaft BT S/V	37-48	Each
31244	24006-54A	Pinion Shaft	54-57	Each
31249	24007-39	Pinion Shaft	39-53	Each

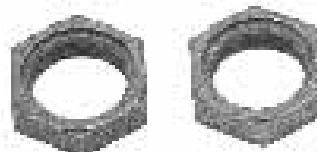

Crank Pin Nuts

Fits 1936-40 61" & 80".
12532 (pair)



BT Motor Sprocket Nut Set 1930-54

Kit includes correct nut, key, retaining ring, and left bearing oil slinger.
12634

Crankcase Big Twin 1958-on

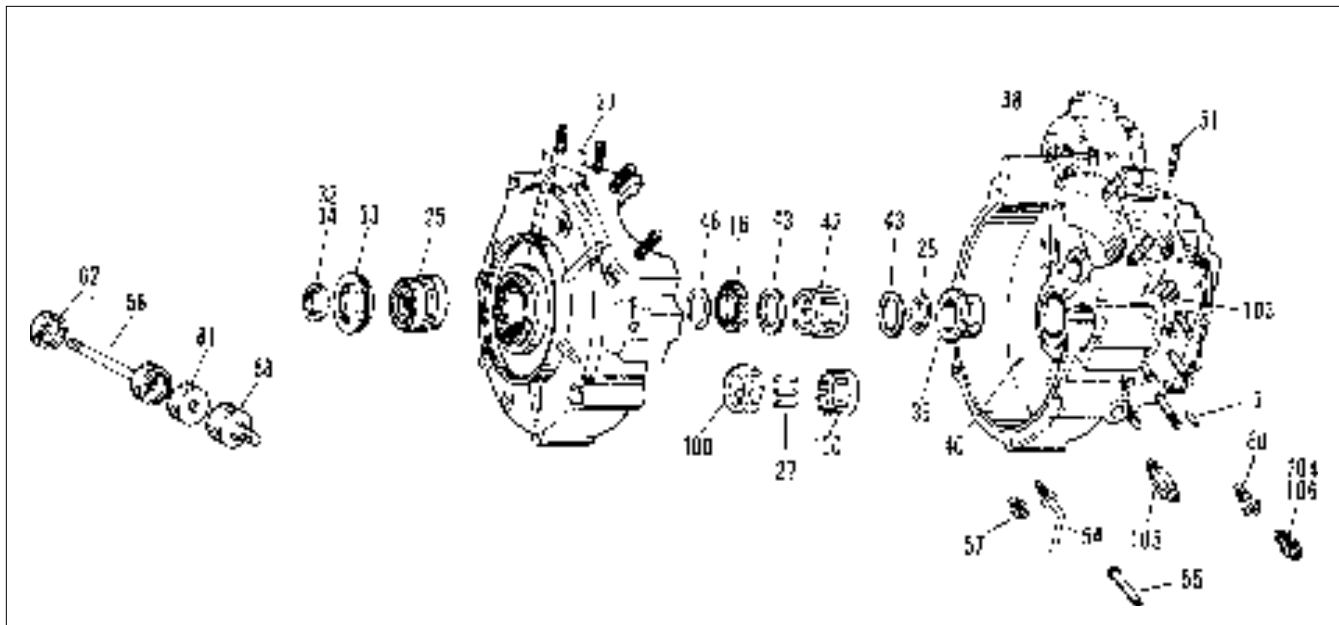

FL Engine Case 1958-69

#	PCP	OEM	Application
3	N/A	341	Dowel pin, oil pump mounting 41-* (10 pk)
25	15516	9029	Bearing, left crankcase 55-68
	15500	9028	As above, 1969-on
27	15050	9220A	Roller, r/s bearing std 58-86 (28pk)
	15051	9221A	As above +.0002
	15052	9222A	As above +.0004
	15053	9223A	As above +.0006
	15054	9224A	As above +.0008
	15055	9225A	As above +.001
	15056	-	As above +.002
28	14507	11007	Retaining ring, right bearing 58-* (10pk)
4A	5472	16831-30	Cylinder studs 41-77 (8 pk)
4B	13564	23741-55	Bearing shim .003 55-84 (10 pk)
32	11801	24029-55	Spacer, sprocket shaft .336 thick 55-64, 66-*
	11802	24029-65	Spacer, sprocket shaft .621 thick 1965
33	1753	24031-55	Case nut with seal 55-*
34	11803	24032-66	Spacer, sprocket shaft .516 66-69
	11804	24033-66	Spacer, sprocket shaft .546 66-69
	11805	24034-66	Spacer, sprocket shaft .576 66-69
	11806	24035-66	Spacer, sprocket shaft .606 66-69
	11807	24036-66	Spacer, sprocket shaft .636 66-69
	11808	24037-66	Spacer, sprocket shaft .666 66-69
	11809		6 Piece assortment of above 66-69
36	58074	24519-58A	Crankcase set 1958-62
	58075	24519-63	Crankcase set 1963-64
	58076	24519-65	Crankcase set 1965
	58077	24519-66A	Crankcase set 1966-*
39	1009	24599-58	Bushing, right crankcase std. 58-99
	31070	24599-58	Jims, as above
	1171	24600-58	Bushing, right crankcase +.002
	1010	24601-58	Bushing, as above +.005
	1011		Bushing, right crankcase +.010
	31071		Jims, as above
40	24505	24608-54	Screw, crankcase gear side bushing 54-78 (10 pk)
42	15920	24650-58	Right bearing std. 58-85 (kit)
43	11816	24692-58	Washer, right bearing 58-86 (pr)
46	11057	24779-55	Snap ring, L/S bearing 55-68 (ea)
51	10822	24811-63	Stud, circuit breaker mounting clamp 66-69 (ea)
54	17506	24912-65	Breather pipe 1965-66
55	17507	24913-67	Breather pipe 1967
56	10840	24914-58	Breather stud 58-64
58	1379	24918-58	Breather nipple 58-64
100	10732	43578-35	Retainer, right roller bearing 58-86 (ea)
103	10574	63533-15	Nipple, vent pipe tubing 15-64 (ea)
104	10575	63533-41	Nipple, vent hose L66-* (5 pk)
105	10576	63533-65	Nipple, oiler return line hose 1965 (ea)

Sprocket Shaft Seal and Snap Ring

Bearing retainer fits BT 1955-68.
1753

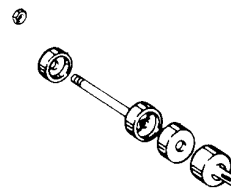

Breather Stud Kit

Kit includes all parts pictures 24925-58 spacer, 24914-58 stud, 24922-58 collar, 24923-58 cap and 24918-58 rubber nipple, for 1958-64 Big Twin.

17500 Complete kit
1379 Oil nipple only

AUTHENTIC

FL Flywheels 1958-69

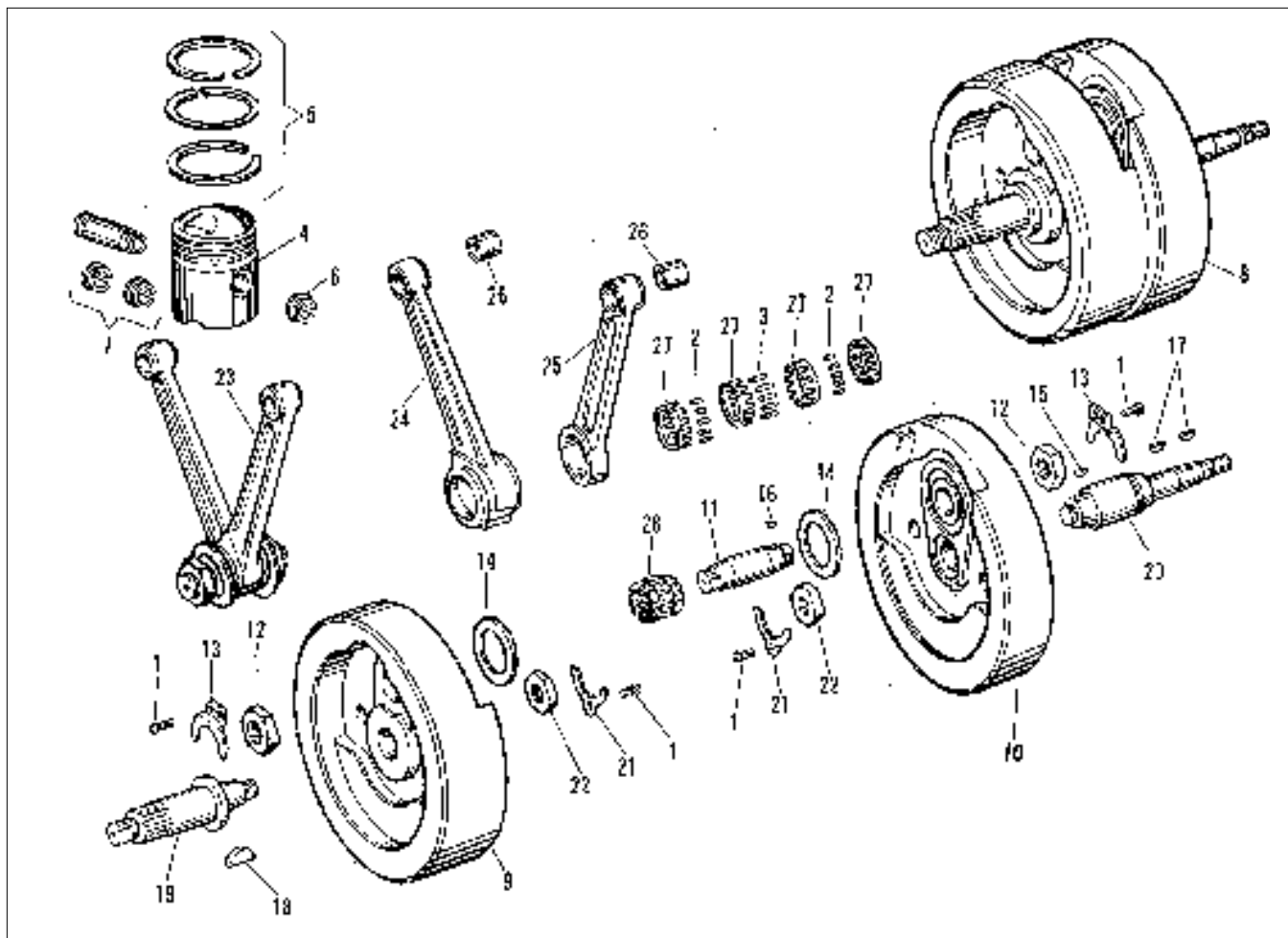

FL Flywheels 1958-69

#	PCP	OEM	Application	#	PCP	OEM	Application
1	24502	2660	Screw 1948-* 10-24 x 3/8 (10 pack)	26	18507	24334-36	Bushing, piston pin 1936-99 (pr)
6	11048	22581-32	Lock ring, old "L" style 1941-72 (pr)		31354		Jims, as above
	11049	22582-52	Lock ring, spiral style 73-E77 10pk		18597		Bushing +.002 piston pin 36-99 (pr)
8	58001	23906-58	74" Flywheel assembly 1958-64		18508		as above +.005 (pr)
	58004	23906-65A	74" Flywheel assembly 1965-69		31355		Jims as above (pr)
11	975	23961-41	Crank pin 1941-E81 3 hole		18509	24335-36	Bushing, piston pin +.010 (pr)
12	12599	23966-54A	Nut, crank pin 1954-81 (pr)	27	10721	24366-51	Retainer, c/pin roller 51-* (4 pc)
	31004		Jims As above	28	2744	24385-40A	Rollers & retainers std. 41-* (set)
13	13704	23971-54	Lockplate, crank pin nut 54-80 (pr)		2745	24386-40A	As above, +.0002
14	11526	23973-41	Washer, std flywheel 1941-70 (pr)		2746	24387-40A	As above, +.0004
	11527		As above, +.005 (.060)		2747	24388-40A	As above, +.0006
15	10304	23985-12	Key, gear shaft to f/w 41-E81 (10)		2748	24389-40A	As above, +.0008
16	10305	23985-18	Key, crank pin 1941-81 (10 pk)		2749	24390-40A	As above, +.001
17	10306	23985-54	Key, gear shaft pinion 1954-89 (10)				
18	10307	23985-56	Key, sprocket shaft 1956-71 (10 pk)				
19	1025	24001-56	Sprocket shaft 1956-64				
	31207		Jims, as above				
	1026	24001-65	Sprocket shaft 1965-69				
	31210		Jims, as above				
20	1033	24006-58	Gear shaft 1958-72				
	31245		Jims, as above				
21	13709	24015-36	Lockplate, shaft nut 1941-* (pr)				
	13706		As above, (5 pk)				
22	12543	24023-36	Nut, gear/sprock/shafts 36-E81(ea)	32510			Special shaft for installing pre-1981 80" flywheels in all 1956-64 Big Twins
	31009		Jims, as above (each)	32512			Special shaft for installing 1981-86 (6 degree mainshaft) 80" flywheels in all 1956-64 Big Twins
	12538	24003-55	Sprocket nut 1955-69	32513			Special shaft for installing 1981-86 (6 degree mainshaft) 80" flywheels in all 1965-69 Big Twins
23	34001	24281-41A	Connecting rod assembly 1941-73 (includes bearings and crank pin)				

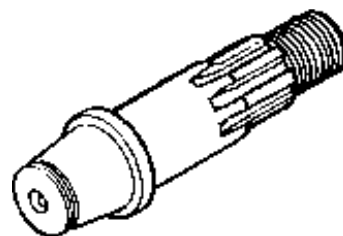

Oil Pump

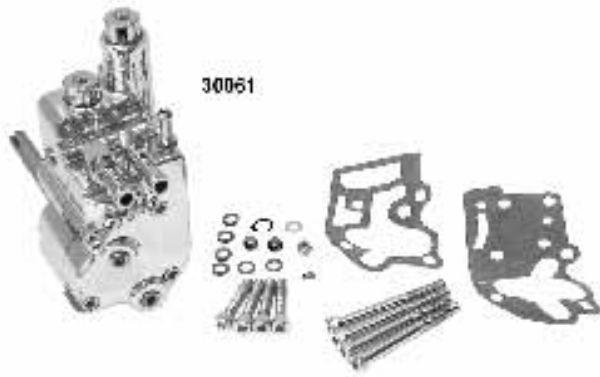

V-Twin Oil Pump Assembly

Pump features improved oil pump pressure regulation that will ensure correct oiling to all areas of V-Twin engines 1936-on. Kit includes all necessary fittings, snap rings, keys, gaskets and mounting bolts. Can be used with either chain drive or belt drive models. **Note:** On 1970-80 models a drilling operation is required. Use PCP #530013 drill.

Pump	Breather	Year	Finish
30061	59560	1936-53	Polish
30062	59561	1936-53	Chrome
30061	59562	1954-72	Polish
30062	59563	1954-72	Chrome

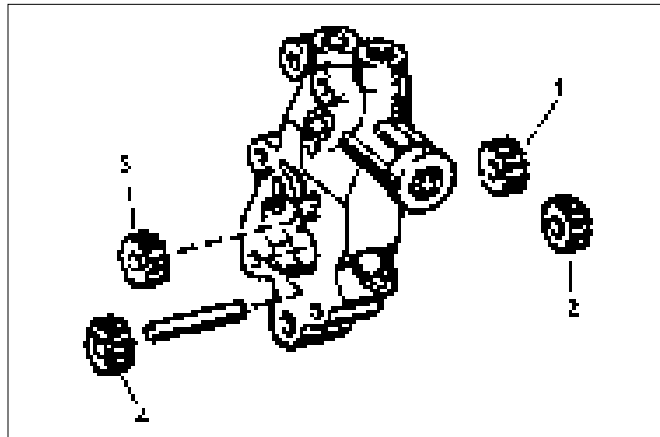

BT Oil Pump Gears 1950-67

#	PCP	OEM	Application
1	30095	26315-48	Feed 1948-61
2	30096	26317-48	Idler feed 1948-61
	30097	26317-62	Idler feed 1962-67
3	30098	26320-36	Scavenger 1936-62
4	30099	26325-49	Scavenger idler 1949-62
	30102	26326-62A	Scavenger idler 1962-99

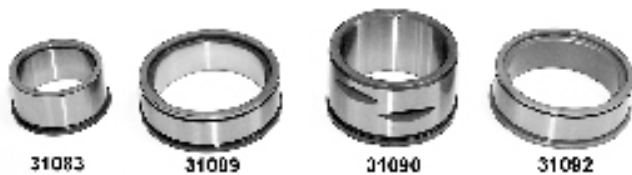

Jims Mainshaft Bearing Races

PCP	Application
31083	.005 XL 54-83 trans main race
31092	.008 BT 1937-E77 trans main race
31089	.032 BT 37-E77 trans main race
31090	.032 BT 1958-99 R/S motor race

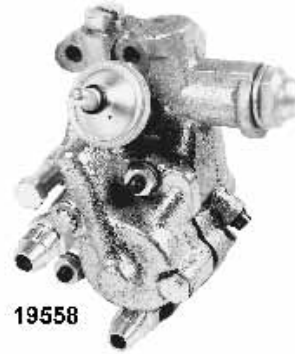

V-Twin Replica Style BT Oil Pump 1941-49

Includes cast outer cover without rotator.
19558

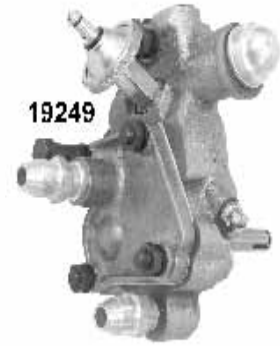

BT Complete Cast Iron Oil Pump Assembly

Fits 1950-67 BT and replaces 26201-48D.
19249

Jims BT Cam Cover Bushings

PCP	Description (Each)
31357	BT 1936-69 (25581-36)



Jims Sprocket Shaft Nuts

PCP	Description
31013	BT 1930-54 (24003-30)
31014	BT 1955-69 (24003-55)



Jims Pinion Shaft Nuts

31016	BT 1954-89 (24023-54)
-------	-----------------------

Jims Trans Sprocket Nut

31017	BT 1936-on (35211-91)
-------	-----------------------



Jims Pinion Shaft Spacer

31043	24703-54B
-------	-----------

Oil Pump

BIG TWIN OIL PUMP

1967 & EARLIER

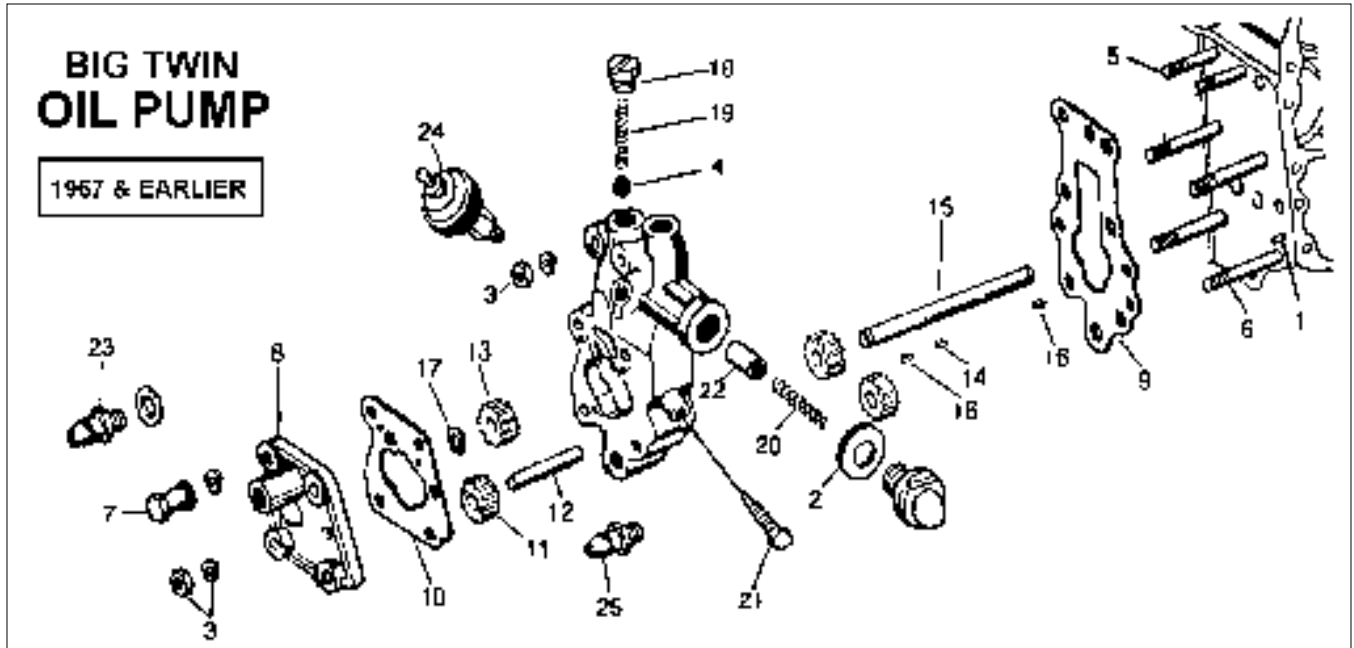

PC #	OEM #	Description	Year	U/M	PC #	OEM #	Description	Year	U/M
1	N/A	341 Dowel mount (2)	41-73	10Pk	14	10308	26340-36 Key Pump Gear	36-67	10Pk
2	11700	6581 Washer .025	54-78	5 Pk	15	1406	26346-36 Pump Shaft	41-67	Each
3	5170	7691W 5 Nut Kit w/washers 1/4-24 (2) 68-79	50-79	Each	16	10310	26348-15 Key Drive Shaft	36-99	10Pk
4	15574	8873 Ball Chk Vlv 3/8"	41-*	10Pk	17	11060	26348-36 Snap Ring Shaft	36-69	10Pk
5	10832	24819-36 Stud (2) 1-11/16"	41-67	Each	18	30107	26362-36 Cap, Valve Spring	41-80	Each
6	10834	24820-36 Stud (4) 2-1/4"	41-67	Each	19	13135	26363-36 Spring, Check Valve	41-55 & 66-80	10Pk
7	2150	24831-41 Nut 1/4-24 Chrome	41-67	Each		13136	26363-56 Spring, Check Valve	56-65	10Pk
8	17501	26237-50 Outer Pump Cover	50-64	Each	20	13141	26374-54 Spring Relief Valve	L54-72	10Pk
9	79123	26245-41 Gasket Pump Body	41-67	10Pk	21	24508	26383-32 Screw Chain Oiler	32-67	Each
10	79115	26257-50A Gasket Pump Cover	50-67	10Pk	22	30108	26400-54 Valve Oil Pump	L54-E82	Each
11	30102	26326-62A Drive, Idler Gear	L62-99	Each	23	10592	26424-50 Fitting Pump Cover	50-64	Each
12	30103	26327-52 Idler Gear Shaft	L62-67	Each	24	5670	26552-72 Pressure Switch	41-67	Each
	30105	26328-41 Idler Gear Shaft	41-E62	Each	25	10574	63533-15 Fitting Short Line	36-64	Each
13	30106	26328-74 Drive Gear	41-99	Each					

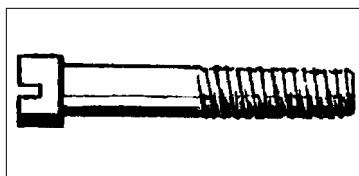

Oil Pump Mounting Screw

Replaces OEM #1397. Use on all Big Twins 1936-47. 24511

Oil Passage Drilling Jig

Allows builder to update early Crankcase to fit S&S Oil Pumps, made of heat treated steel.

530013



BIG TWIN OIL PUMP AND FILTER FITTINGS

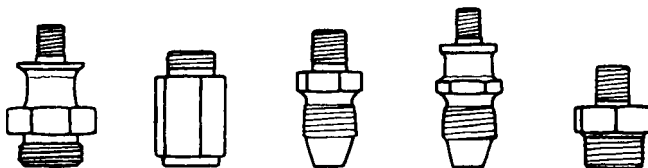

PC #	OEM #	Application (Cad)	Years
10574	63533-15	Oil pump to line (ea)	36-64
10592	26424-50	Oil pump cover to line (ea)	50-64
10571	63526-50	Oil pump cover to filter line (pr)	58-64
10568	63524-50	Oil filter line connector (ea)	51-64
10569	63525-50	Oil filter line connector (pr)	40-64
10573	63527-50	Oil filter line nut (pr)	50-64
10591	63871-50	Oil filter cap adapter (ea)	41-64

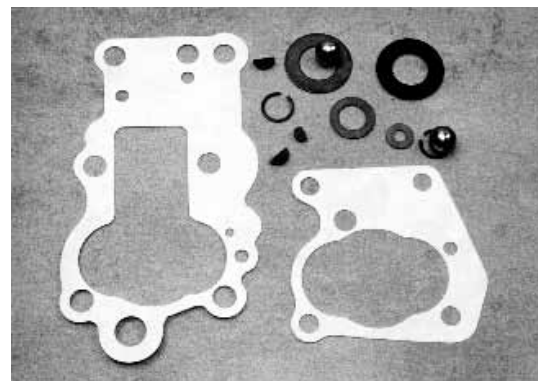

Oil Pump Gasket Kit (James)

79815 1948-67

Oil Pump Plugs

Oil Pump Relief Valve Plug
Fits 1968-1980 Big Twins.
Replaces OEM P/N 26377-68
3577

Tappet Oil Screen Plug
Fits 1970-1980 Big Twins.
Replaces OEM P/N 657
3579

Oil Pump Check Valve Plug
Fits 1936-1980 Big Twins.
Replaces OEM P/N 26362-36
3581

Tappet Oil Screen Plug
Fits 1952-1965 Big Twins.
Replaces OEM P/N 24987-22
3585

Tappet Oil Screen Plug
Fits 1966-1969 Big Twins.
Replaces OEM P/N 655.
3587



Stock O.E.M. Style

PCP	Application
2160	BT 1936-69 chrome
5192	BT 1936-69 cad
9621	BT 1936-69 parkerized
9794*	BT 1936-69 chrome 1/4-20
9795*	BT 1936-69 cad 1/4-20
9796*	BT 1936-69 parkerized 1/4-20
*Note:	Special thread for aftermarket 1/4-20 cases

Oil Pump Mounting Hardware

OEM-Style

Custom

Custom



Stock OEM Style

5331 OHV BT 1936-1967 Cad
5332 BT 1968-1977 Chrome
5333 BT 1968-1977 Cad

Chrome Allen

5336 BT 68-77

Chrome Acorn Style

1757 Big Twin 1968-1977

OEM-Style

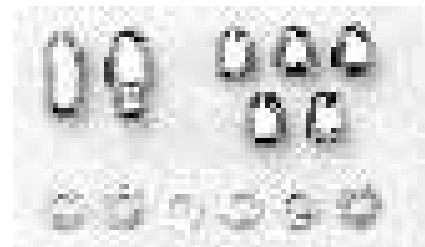

Oil Pump Nuts Only BT '36-67

1685 Acorn

Oil Pump Nut

Exact reproduction of the long oil pump nut with 1/4-24 thread used on pre-1968 Harley Davidson.

2150 Chrome, long 1936-1967 OHV
8109 As above, cad
5309 Chrome 1941-1948 74 & 80 S.V., 1941-54 45's
5310 As above, cad, short
9631 As above, parkerized

Oil Pump Nut Kit

This 6-pack of hard to find 1/4-24 hex nuts will fit the oil pump on pre-1968 Harleys. This special size nut also has many miscellaneous applications throughout the early models.

2149 Chrome Plated
5170 Cad Plated
9673 Parkerized

BT Oil Pump Hardware

Colony Oil Pump Plugs



A. Oil Pump Bypass Valve

Fits OHV BT 1937-52, UL, and 45's 1937-on. (26367-36)

9527 Cad

B. Oil Pump Check Valve Plug

Fits OHV BT 1937-80, UL and 45's 1937-on. (26362-36)

9524 Cad

9525 Parkerized

C. Oil Screen Plug

BT 1952-65. Plug (24987-52) and copper gasket (24994).

9603 Chrome

9604 Cad

BT 1966-69. Plug (655) and brass gasket (62702-52).

9875 Cad

D. Oil Pump Relief Valve Plug

Fits BT 1954-67. Plug (26377-54) and brass washer (6581).

9605 Chrome

9606 Cad

E. Oil Pump Relief Valve Plug

Fits BT 1968-80. Plug (26377-68) and brass washer (6581).

9607 Chrome

30134 Cad

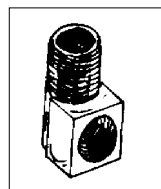

Oil Pump Fitting

Chrome 90 degree fitting for all 1968-92 Big Twins. Will also work on many custom applications. (26338-68)

10520 5 Pack

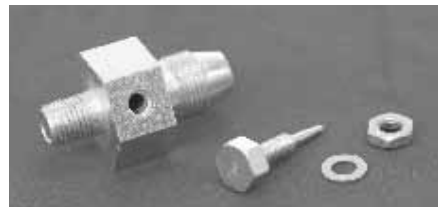

Chain Oil Kit

Cad plated oiler body (63607-54), oiler adjusting screw (63610-53), nut and brass washer used on 1954-62 Pan-heads.

72321

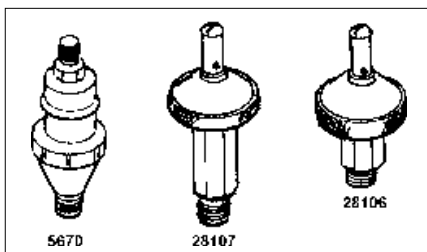

Oil Pressure Switches

Oil pressure switches with precision calibrated heavy duty contacts, plastic insulator and a bright finish.

PCP Fits

5670 XL-K 1954-76, BT 1972-83

28106 45" 1939-68 (26550-38A)

28107 BT 74 & 80 '39-68 (26551-39)

4447 Fitting XL 1957-76 (26420-57)



Oil Screen Kit

Includes proper plug screen, O-Ring and spring for '66-84 Shovel tappet screen.

PCP Description

16266 1963-65

2989 1966-69

Tappet Oil Screens (each)

PCP Description

16267 1952-62 (24975-52)

16268 1963-65 (24975-63)

13402 1966-69 (24981-66)

Oil Screen Springs for Tappet Oil Screen

16269 1952-62 (24992-52) (10 pk)

13125 1963-65 (24979-63) (ea)

13126 1966-69 (24982-66) (ea)

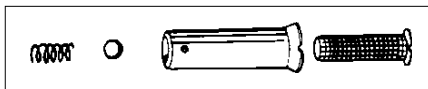

Oil Screen Parts 1952-57

Complete kit includes all parts pictured. (24975-52 Screen), (24985-52 body) (8856 ball), (24992-52 spring).

2961

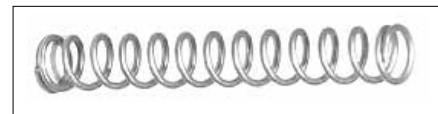

Crane Oil Pump Relief Valve Spring FL 1936-99

Increases engine oil pressure by 2-3 psi. Highly desirable for extended engine life.

34548



1690

Timing Plugs

Acorn style plug fits all models Harley Big Twin and Sportster timing plug holes and oil tanks with 5/18-18 drain holes.

1690

Acorn style plug with an oversize thread and one tap for rethreading the stripped out timing hole. Fits all Harley timing holes.

1758 Plug and Tap

1759 Plug ONLY .O.S 11/16x16

Cap style plug fits all models for Harley Big Twin and Sportster timing plug holes and oil tanks with 5/18-18 drain holes.

2896 With 5/8 - 18" Drain Hole

5258 BT 81-Up 1/2-20 Thread

Quality reproduction of stock timing plug. Offered in choice of polished and chrome plated or cad plated.

1481 FL1952-69 chrome 3/4 hex (704)

8115 As above, cad

9502 BT 1939-51 chrome 7/8 hex (2326-38)

9503 As above, cad

New functional and custom design plug fits all models Harley Big Twin and Sportster timing plug holes and oil tanks with 5/18-18 drain hole. Oil fill on 45's to 1940.'

3591 Chrome Plated

5282 Cad Plated

5283 Black Oxide

S/V Oil Pump

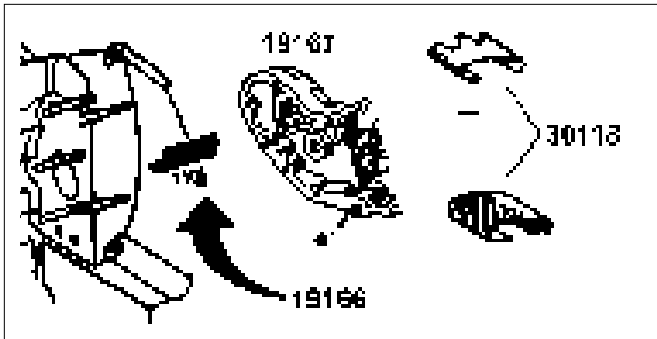

Breather Screens and Separator

PCP	OEM	Description
30118	25275-36 25279-36	Screen and separator BT 1936-69
19166	26343-39	Scavenger screen 45, VL 1937-73
4428	26276-52	Scavenger screen XL 1952-73
19167	25350-37	Breather valve 45" 1937-73

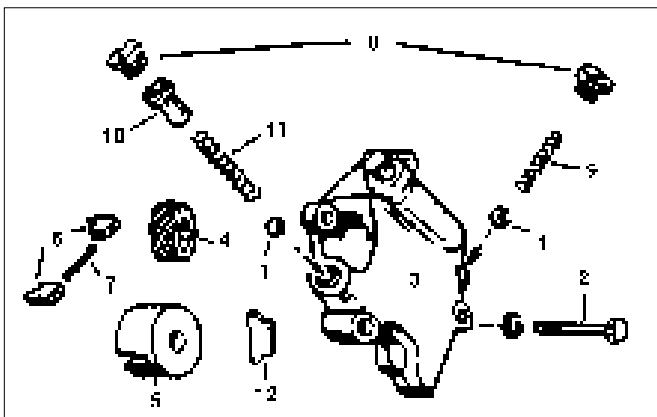
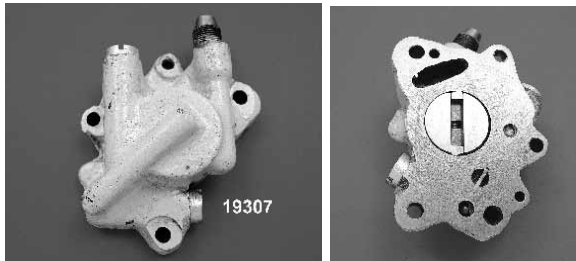

45 Feed Oil Pump 1937-73

PCP	Description
19307	Complete oil pump assembly
19020	S/V Oil pump feed body
19030	Kit including items 1,8,9,10,11,12

45 Feed Pump Parts 1937-73

PCP	OEM	Description
1	15574 8873	Balls (10 pk)
2	9409 9663	Cad 45 bolt & nut kit As above, parkerized
3	N/A	Pump body
4	19291	26203-37 26318-37 Oil pump drive gear
5	19031	26270-37 Holder, pump vane 1937-73
	19292	26270-41 Holder, pump vane 1941-73
6	19293	28284-37 Vane (pair)
7	13134	26286-37 Spring, vane (10 pk)
8	9524	26362-36 Check valve plug, cad
	9525	26362-36 Check valve plug, parkerized
	30107	26362-36 Check valve plug
9	13136	26363-56 Check valve spring (10 pk)
10	19294	26369-41 Adjust screw
11	13139	26373-41 By-pass spring (10 pk)
12	19295	26381-37 Retainer (pr)
NA	79836	Gasket kit

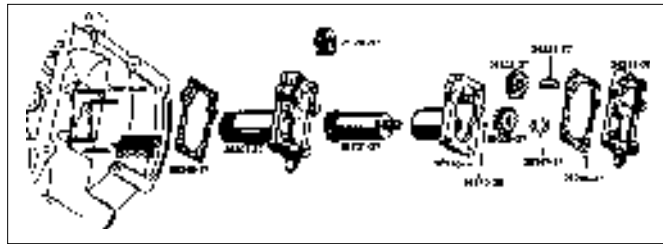

Side Valve Scavenger Pump Parts

PCP	OEM	Description
10832	24819-36	Stud
19469	25302-37	Breather spiral gear
25297	26246-37	Gasket
19300	26320-37	Gear
19301	26326-37	Idler gear
19390	26331-37	Scavenger gear
10308	26340-36	Key (10 pk)
11059	26341-37	Key halves (5 pk)
19166	26343-39	Screen
19089	Kit	Oil pump adjusting screw kit w/shims and washers
19220		Complete pump assembly
9409		Cadium bolt kit
9663		Parkerized bolt kit

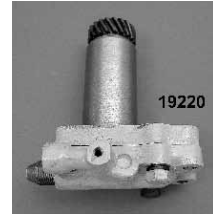

Oil Pump Adjusting Screw Kit

Fits BT and Side Valve. Includes screw, shims and washer.
19089



S/V Oil Pump Fitting

Replaces stripped or broken fitting in cast iron SV feed or scavenge pumps. Has 7/16" UNF thread w/internal hex.
10528

BT Oil Pumps Pre 1973

Note:

Stock 1965-72 engines equipped with H-D oil pumps use different primary chain oiling methods than 1973-on engines. To convert an engine from this year group to 1973-on primary chain oiling method, an S&S oil pump kit #316202 or #316203 can be used in conjunction with a 1973-on breather gear.

Oil Pump Kits

Oil Pump Assembly Only

316200 1936-72 requires 1973-77 breather gear

Oil Pump Assembly with Drive Gear, Breather Gear, Shims

316292 1948-53

316293 1954-69

Oil Pump w/Custom Cover and Gears

316245 1948-53

316246 1965-69

Oil Pump w/Improved Primary Oiling and Gears

316248 1965-69



S&S BT Billet Oil Pump Gasket Kits

S&S Oil Pump Gasket Kit

316271 1936-91 with paper gaskets

316275 1936-91 master rebuild kit



S&S Standard Billet Oil Pump Kits

Note that some kits include a breather gear and shim kit with an oil pump assembly. The 1965-69 kits with gears are designed specifically to improve primary chain oiling in engines from these year groups. Improved primary chain oiling is done by using positive crankcase pressure to provide an oil mist from the flywheel cavity through a metering hole in the breather valve gear in the same manner as 1973-84 stock systems do. Primary chain oiling is automatic and precise eliminating potential damage to the primary chain or dry clutch because of too little or too much oil.

Oil pump only kit includes supply gears, return gears, drive shaft, drive shaft keys, drive shaft snap rings, check ball, check ball spring, pressure valve, pressure valve spring, cover screws with o-rings, miscellaneous hose fittings, plugs, screws, paper gaskets, and mounting hardware with both early style 1/4"-24 and late style 1/4"-20 mounting bolts.

Caution:

Incorrect gear fit causes binding and premature wear or damage to gears which may also result in damage to other engine components.

Note: Standard covers are like OEM and Universal Custom covers feature top and bottom feeds.



Complete Oil Pump Kits for Big Twin

S&S "Ultimate Oiling" Oil Pump Kits are designed to improve and upgrade the oiling systems in engines prior to 1981. These kits solve the problem of inadequate oil volume to operate the hydraulic lifters by changing the cranks to the later method of delivery and by converting the engine to pump RPM ratio from 5 to 1 to 4 to 1. Detailed instructions to perform the crankcase modifications required in most installations are included.

316263 1948-53

316293 1954-69

316271 S&S Oil Pump Gasket Kit to 1991

"45" Flywheel / Case

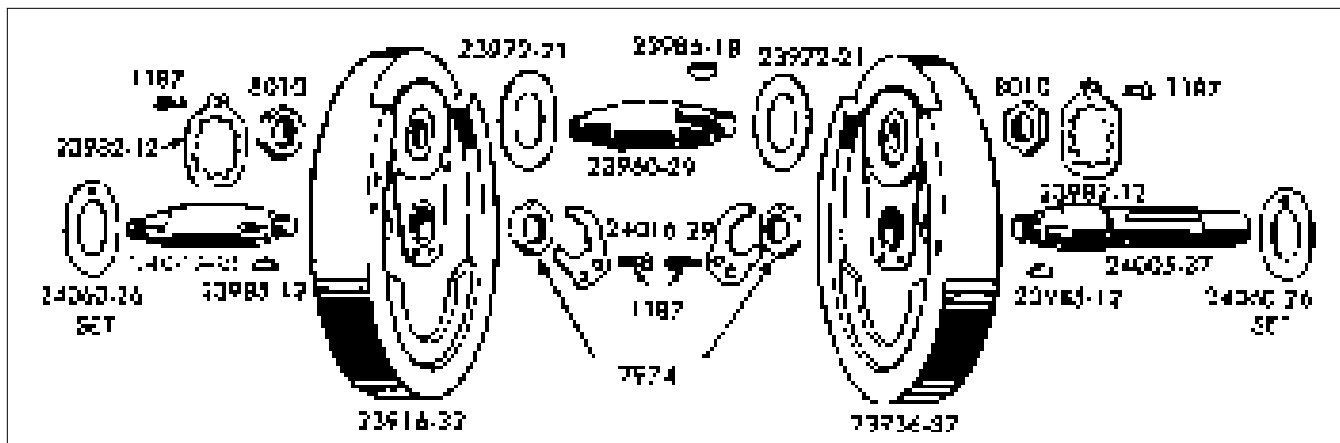

45 Flywheel

PCP	OEM	Description	PCP	OEM	Description
24500	1187	Lock screw (10 pk)	2328	24005-37	Eastern 45 Pinion shaft 1929-on
12517	7974	Nut pinion/sprocket 1937-73 (ea)	31240		Jims, as above
31019		Jims, as above	11827	24060-26	Washer set 9 pcs. 1929-73
12522	8010	Nut, crank pin 1937-73 (pr)	3397	24063-26	Thrust washer .066 thick 1929-54 (ea)
13705	23982-12	Locktab, crankpin (pr)	3398	24068-26	Thrust washer .074 thick 1929-54 (ea)
10304	23985-12	Key, pinion/sprocket (10 pk)	3399	24070-26	Thrust washer .078 thick 1929-54 (ea)
10305	23985-18	Key, crank pin (10 pk)	3400	24073-26	Thrust washer .082 thick 1929-54 (ea)
13707	24016-29	Locktab, pinion/sprocket (pr)	3401	24075-26	Thrust washer .086 thick 1929-54 (ea)
1049	23960-29	Crank Pin 1936-73	3402	24077-26	Thrust washer .090 thick 1929-54 (ea)
31131	23960-29	As above, Jims	3403	24079-26	Thrust washer .094 thick 1929-54 (ea)
3406	23972-21	Rod thrust washers.060 1936-73 (pr)	3404	24082-26	Thrust washer .098 thick 1929-54 (ea)
18011		As above, +.005 .065 (pr)	3405	24084-26	Thrust washer .102 thick 1929-54 (ea)
31201	24000-29	Jims 45 Sprocket shaft 1929-73			
19572		Eastern, as above			

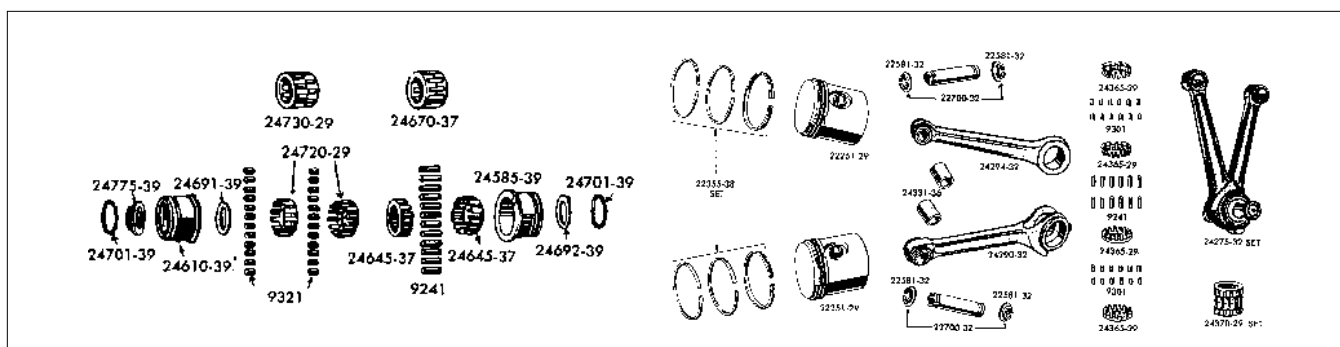

45 Models 1929-73

PCP	OEM	Description	PCP	OEM	Description
2690	9241	Rt. engine case roller (12) Std 1930-52 Solo, 1953-54 Servi Car	1048		Set of 3 Rod Races 1929-73
2691	9244	Rt. engine case roller (12) +.0006 1930-52 Solo, 1953-54 Servi Car	15830	24370-29	Set of rod rollers and 6 cages 1936-67
2692	9246	Rt. engine case roller (12) +.001 1930-52 Solo, 1953-54 Servi Car	15835		As above +.001
2685	9246-9306	Rod roller set +.001 to fit 34007	2324	24586-39	Right side case race +.002 OS 1939-on
2687	9321	Left engine case roller (24) Std 1930-52 Solo, 1953-54 Servi Car	4127	24587-39	Right side case race +.005 OS 1939-54
2688	9324	Left engine case roller (24) +.0006, 1930-52 Solo, 1953-54 Servi Car	2325	24610-39	Left case race STD 1939-on
2689	9326	Left engine case roller (24) +.001 1930-52 Solo, 1953-54 Servi Car	31074		Jims as above
34007	24275-32	Complete set of 45 rods with crank pin and bearings, prefitted	2326	24610-39	Left case race +.002 O.S. 1939-on
34010		As above, requires fitting	4123	24612-39	Left side case race +.005 OS 1939-54
18504	24331-36	Piston pin bushing 1936-67 (pr)	15415	24670-37	Pinion bearing set, STD
18505	24331-36	Piston pin bushing 1936-67 +.005 (pr)	15425		As above .001
			15416		As above, .0002
			11825	24691-39	Washer left side bearing race (5 pk)
			11826	24692-39	Washer right side bearing race (5 pk)
			11110	24701-39	Retaining ring right side bushing (10pk)
			2686	24775-39	Left bearing end oil slinger 1939-54
			2323	24585-39	Right side case race STD 1939-73
			31050		Jims as above STD
			31055		Jims as above +.005
			2351		Sprocket shaft oil seal/snap ring 39-73

45 Cam Hardware

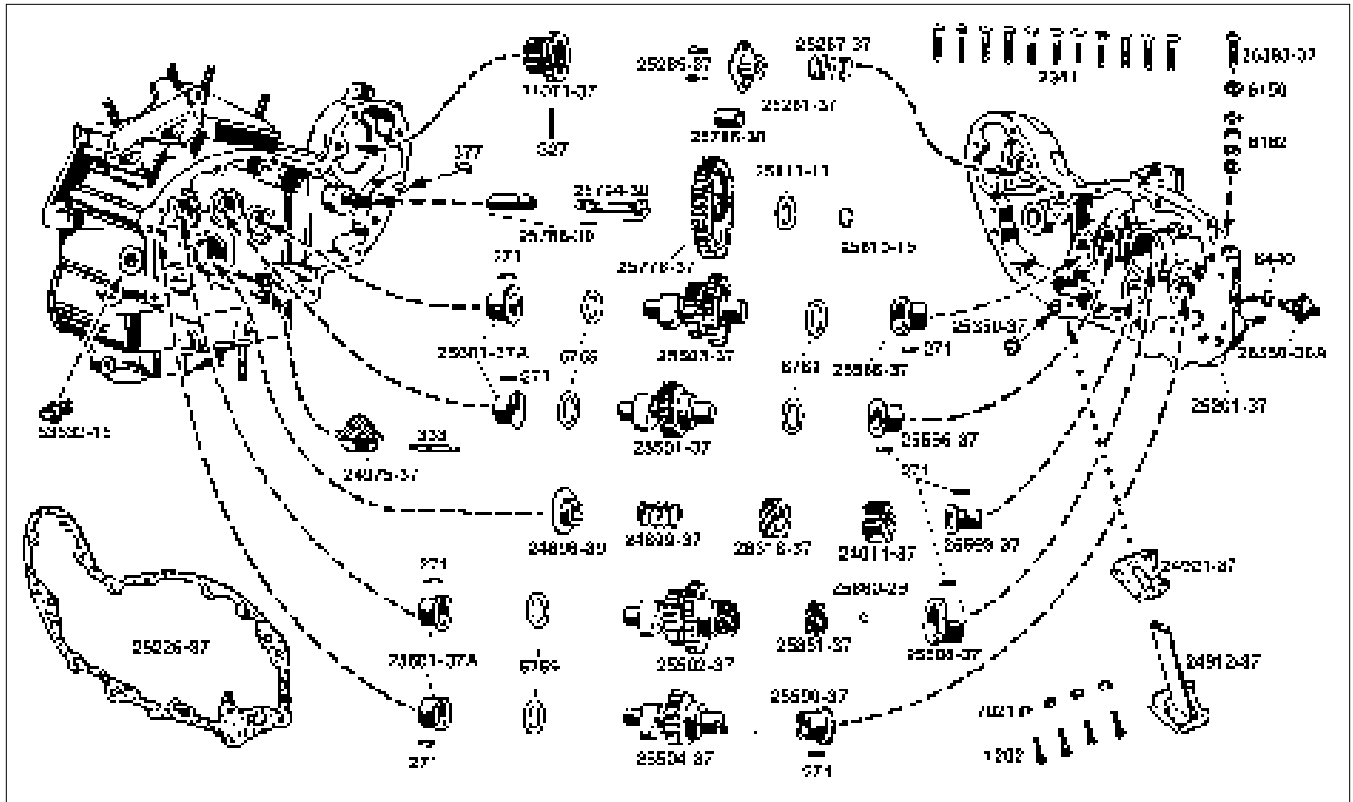

45 Cam Hardware

PCP	OEM	Description	PCP	OEM	Description
9412		Cam cover screw set, chrome 1937-73	18523	25590-37	Cam cover bushing 1937-73
9413		As above, cadmium	18525	25593-37	Cam cov. gear shaft bushing 1937-73
9668		As above, parkerized	18605		As above, +.005
10128	271	Bushing pin 1931-73 (10 pk)	18528	25595-37	Cam cover bushing 1937-73
10139	333	Oil strainer pin 1937-73 (5 pk)	18607		As above, +.005
10196	377	Cam cover pin 1937-73 (pr)	18533	25601-37A	Crankcase cam gear bushing 37-73
13561	6769	Cam washer .007 1937-73 (10 pk)	19471	25776-37	Idler gear 1937-73
29020	24011-37	Pinion gear 1937-73	19472	25788-30	Idler gear stud 1930-73
19466	24696-39	Bearing seal ring 1939-73	18534	25785-30A	Idler gear bushing 1930-73 (pr)
13123	24699-37	Pinion spring 1937-73 (5 pk)	24506	25794-30	Idler gear stud screw 1930-73
19468	24912-37	Relief pipe 1937-73	11058	25810-15	Stud spring ring 1930-73 (10 pk)
25068	24921-37	Pipe gasket 1937-73 (10 pk)	79116	25811-11	Stud fibre washer 1930-73 (20 pk)
2671	24975-37	Oil strainer 1937-73	19473	25851-37	Circuit breaker drive gear 1937-73
19363	Kit	Oil strainer kit for 1937-73 Flatheads	19291	26318-37	Drive gear 1937-73
79286	25226-37	Cam cover gasket 1937-73 (10 pk)	24508	26383-32	Adjusting screw 1937-73
13051	25287-37	Pinion gear spring 1937-73 (10 pk)	28106	26550-38A	Oil pressure switch 1938-73
19167	25350-37	Breather valve 1937-73	10574	62533-15	Vent pipe nipple, cad 1938-73
18519	25586-37	Cam cover bushing 1937-73	1722		Chrome oil line fittings (3 pc)
31369		Jims STD	3408	25788-30	Idler stud and bushing kit
18557		As above, +.005		25785-30	
18520	25588-37	Cam cover bushing 1937-73			

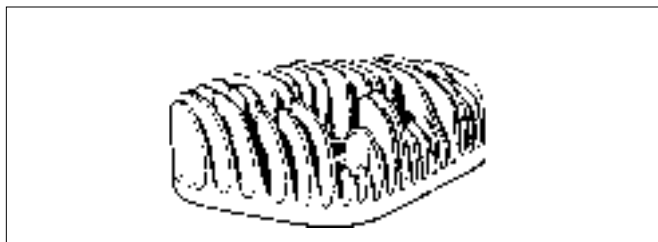

45 Aluminum Head Set

Replaces front and rear on 1941-73 motors. Order bolts and washers separately. Replaces 16683-39 and 16681-39.

- 19841 Low compression
- 19842 High compression 6:1



45 Tappets 1929-73 & K models 1952-56

2693	STD	Flathead (18490-29)
31600		As above, Jims big axle
31107		As above, Jims std (not big axle)
2694	.005	Flathead
31601		As above, Jims big axle
31108		As above, Jims std (not big axle)
2695		Tappet screw only (each)



Motor Case Kit

Stock type fit "45" models, 1937 up to 1952. Chrome or cadmium plated finish.

- 5288 Chrome
- 5289 Cadmium

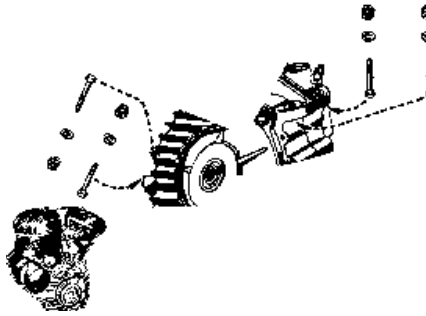

Lower Motor Mount Kit

Cad plated duplicate of stock hardware used to mount motor in frame on VL Big Twins 1930-36, all 45's.

5415

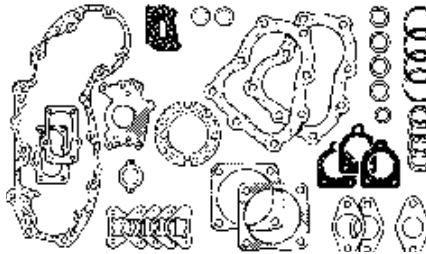

Complete Motor Overhaul Gasket Kit

Replaces OEM #17028-40. Use on all 1935-73 45's.

79900 (James)



Breather / Scavenger Gear

Fits Side Valves 1937-48.

19390 26331-37



Grease Fitting/Flat Top Alemite

Exact reproduction nickle plated brass flat top alemite grease fitting used on pre-1938 Harleys.

5361 6 pieces



TOP MOTOR MOUNT SPACERS - HARLEY 45

Nice reproduction of original Harley 45 part. This part spaces out the two longest headbolts on 1937-1974 45's.

- 8229 Chrome Plated
- 8230 Cad Plated



Colony Cam Cover Screws

- | PCP | Application |
|------|------------------|
| 9413 | 45's 1937-73 cad |



45 MOTOR SPROCKET

Use on 1929-73 all models.

- | PCP | ITEM |
|-------|----------------------|
| 19523 | 22 Tooth (40230-29) |
| 5526 | 27 Tooth (40235-29) |
| 3758 | 30 Tooth (40238-29) |
| 19100 | 31 Tooth |
| 10304 | Key (23985-12) 10 Pk |
| 12521 | Nut (7991) ea. |



Adaptor Set

Allows 14mm plugs to be used in earlier heads with 18mm spark plug threads.

19104



45 Sprocket Shaft Bearing Kit

Includes hardware to fit 1939-73.

15429

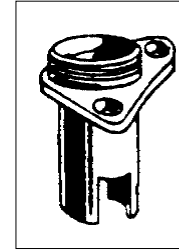

45" Steel Lifter Base

- | PCP | Application |
|-------|-----------------------------------|
| 19304 | Rear base |
| 19305 | Front base |
| 19667 | FR&R set w/out threads 1939-48 UL |
| 19306 | Rear base without threads |
| 8103 | Cadmium screw set |
| 2158 | Chrome screw set |



Sprocket Shaft Seal & Snap Ring

Replaces OEM slingers.

- 1754 BT 1936-54
- 2351 All 45 1939-73



Side Valve Pinion Kit

- 19298 45 1937-73
- 19299 BT 74 & 80 1940-48



45 Cylinder Sets

Include front and rear cylinder sets. PCP # 34815 also includes pistons and rings.

PCP	Type	Guides
34807	WLDR	No
34808	WR	No
34815	WL	Yes



45 and K Model Valve Cover Sets

For 45" 1929-73, KH and K models 1952-56. Replaces OEM 18239-54 and 18255-52A.

PCP	OEM	Description
19263		K-model, zinc 8 pieces
19265	18239-41 18225-31	45 Complete kit, chrome 8 pieces
19675		As above, zinc
19266	8630-26	Washer (10 pack)
14026	18260-29	Flat seal ring (5 pack)
14514	11123	O-ring (10 pack)
79091	18198-38	Guide seal (20 pack)



Replica Cam Sets by Sifton

PCP	Type	Year
19671	45"	1936-73
19672	45" WLDR	1936-73
19673*	WR	1936-73
19674	BT UL-ULH	1936-48

*Note: Requires #19668 lifter tappet kit

WR Valve Lower Cover

19676 8 Piece set

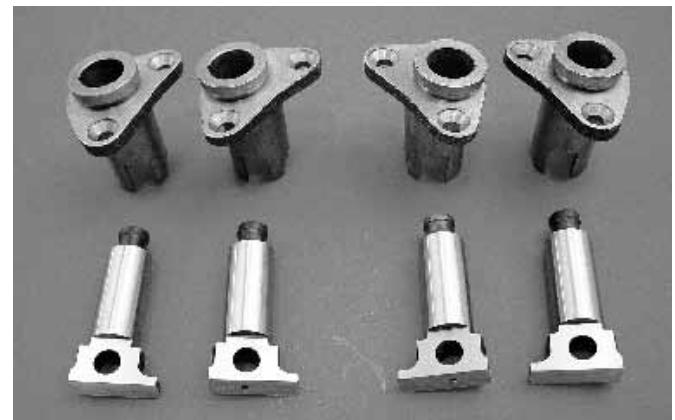

WR Tappet/Lifter Kit

Features flat shoe tappet design and matching lifter block. 19668



45 L/S Bearing Race Washer 39-73

11825 24691-39 (5 pack)



Left Bearing End Oil Slinger

PCP Fits
15427 1939-73 45" (24775-39)



Motor Sprocket Nut Kit

Includes correct nut, key retaining ring and left bearing oil slinger. 15426 1929-73 45



Colony Cylinder Head Nuts and Studs

OEM duplicate nuts, washers and studs used on 45's with cast iron heads and 3/8-16 head studs.

PCP	Application
72183	1929-50 Parkerized studs only (16802-29) (16 pack)
72152	1929-41 Parkerized kit for 45's and 1926-32 singles (12-long nuts, 6-short nuts, 18-washers)
7709	1942-50 Cad kit (16-long nuts, 16 washers)

UL Cam Hardware

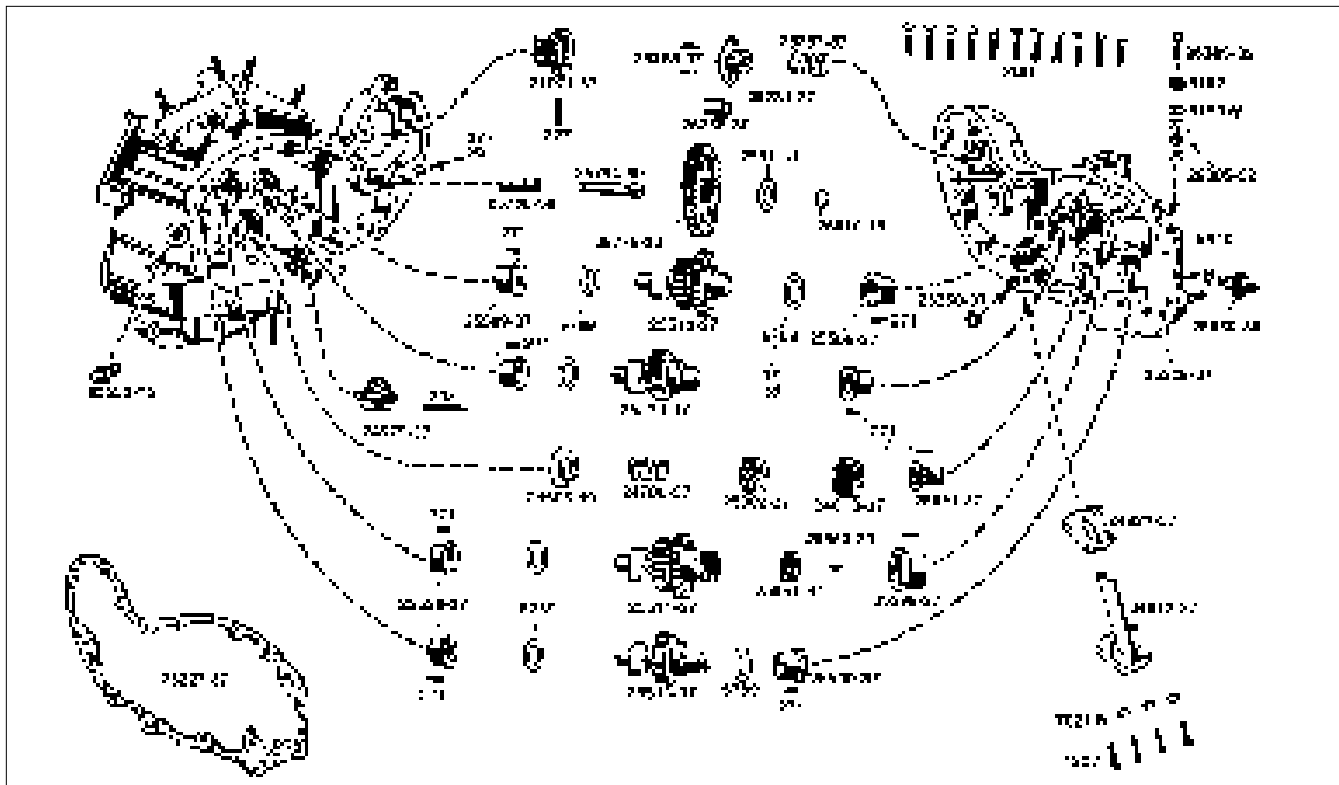

UL-ULH Cam Hardware 1937-48

PCP	OEM	Description	PCP	OEM	Description
10128	271	Bushing pin (10 pk)	18519	25586-37	Cam bushing cover side
10195	327	Gen gear pin (10 pk)	31369		Jims as above
10139	333	Strainer pin (5 pk)	18557		As above .005 oversize
10196	377	Dowl pin (pr)	18520	25588-37	#2 cam bushing
9668	2341	Cam cover screws, parkerized	18523	25590-37	#1 cam bushing
9984	6150W	Adjuster washer	18524	25591-37	Pinion bushing in cam cover
12008	6182	Adjuster washer	18532	25599-37	Pinion bushing
14007	6440	Oil switch washer (5 pk)	19470	25775-30	Idler gear
13561	6769	Shim (10 pk)	18534	25785-30A	Idler gear bushing (pr)
19465	24010-37	Pinion gear	24506	25794-30	Idler gear stud screw
19467	24696-40	Seal ring	11058	25810-15	Idler gear retaining ring (10 pk)
13050	24700-37	Pinion spring (10 pk)	79116	25811-11	Idler gasket 1911-73 (20 pack)
19468	24912-37	Relief pipe	19472	25788-30	Idler gear stud
25068	24921-37	Relief pipe gasket (10 pk)	19473	25851-37	Circuit breaker drive gear
2671	24975-37	Oil strainer	24508	26383-32	Adjuster screw
79287	25227-37	Cam cover gasket (10 pk)	28106	26550-38A	Oil pressure switch
13051	25287-37	Breather spring (10 pk)	19474	31071-37	Generator drive gear
19469	25302-37	Oil pump drive gear	10574	63533-15	BT pump fittings 1915-64
19167	25350-37	Breather valve			

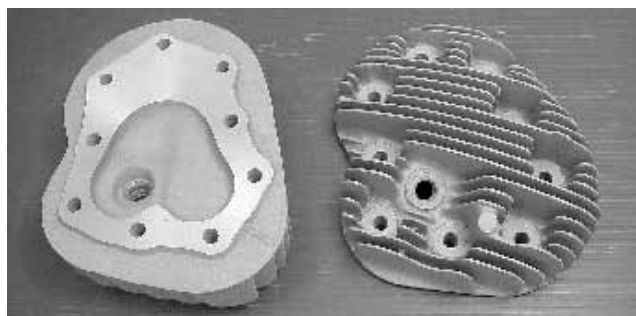

Aluminum Head Set

For all 1937-48 74 & 80 SV motors. Features a deep fin and medium compression. Replaces front and rear and sold in pairs.

19839	Head set (16670-36F, 16673-36R)
19271	Copper gasket set

UL Pinion Gear 1937-48

19465 24010-37



UL Complete Rod Assembly

34011 24279-37



Late ULH Valve Cover Set

Set includes 4 sets of all parts shown, for 1939-48 UL-ULH models.

PCP	OEM	Description
19824	18236-39	Chrome 4 complete
19823	18236-39	As above, zinc.
19260	18254-39	Chrome clips (4 pack)
19261	18254-39	As above, zinc
19262	18248-39	Zinc retainer (4 pack)
19274	18258-39	Retainers, zinc (4 pack)
13130	18247-39	Springs (4 pack)
79092	18245-39	Cork gasket, upper (10 pack)
19677	18246-39	Cork retainer, upper (4 pack)
25298	18257-39	Cork gasket, mid (10 pack)
25299	18259-39	Gasket, lower (10 pack)



Valve Spring Cover Set (Screw Type)

For use on all 1930-38 Flatheads. Set of four.

PCP	Application	Description
19258	1930-36 VL	Cadmium set
19259	1930-36 VL	Chrome set
19669	1937-38 UL	Cadmium set
19670	1937-38 UL	Chrome set
14105	1930-38 VL, UL	Seal for above (10 pk)

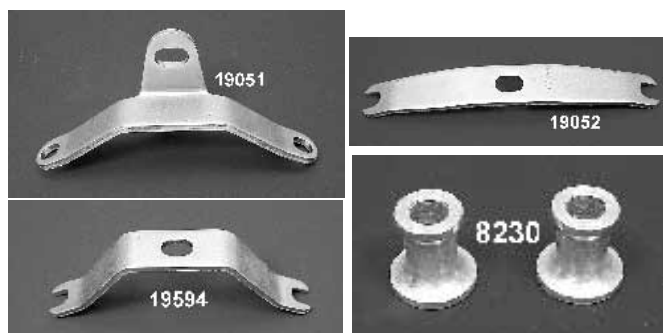

Side Valve Motor Mounts

Mounts fit motors by the head type, cast iron or aluminum.

PCP	Type	Application	Description
19051	Both	1936-48 BT	Zinc (16851-37)
19591			As above, chrome
19052	Alum.	1936-73 45	Zinc (2806-40)
19592			As above, chrome
19593	Iron	1936-73 45	Chrome (16855-51)
19594			As above, zinc
9779	Both		Chrome centre bolt kit
9780	Both		Cadmium centre bolt kit
9781	Both		Parkerized centre bolt kit

45 Top Motor Mount Spacers 1941-73

Use to space out the two longest head bolts on aluminum head models. Pairs.

8229	Chrome
8230	Cadmium
9721	Parkerized



Complete Colony Motor Case Kits

Kits contain all the necessary hardware to bolt together the Harley motor cases. Each kit is packaged for the specific application. There are no universal "fits all" kits.

PCP	APPLICATION	STYLE
1671	Flathead 1936-39	Stock chrome
5175	Flathead 1936-39	Stock cad
5288	45's 1937-52	Stock chrome
5289	45's 1937-52	Stock cad
9697	45's 1937-52	Parkerized
1672	Flathead 1940-48	Stock chrome
5177	Flathead 1940-48	Stock cad
5178	O.H.V. Big Twins 1936-39	Acorn chrome
1673	O.H.V. Big Twins 1936-39	Stock chrome
5179	O.H.V. Big Twins 1936-39	Stock cad
5180	O.H.V. Big Twins 1940-47	Acorn chrome
1715	O.H.V. Big Twins 1940-47	Stock chrome
5181	O.H.V. Big Twins 1940-47	Stock cad
1716	Big Twins 1948-64	Stock chrome
5183	Big Twins 1948-64	Stock cad

Tech Tip:

Adjust tappets so that there is .004" to .005" clearance between intake valve stems and tappets, and .007" to .008" clearance between exhaust valve stems and tappets.

Knuckle Parts

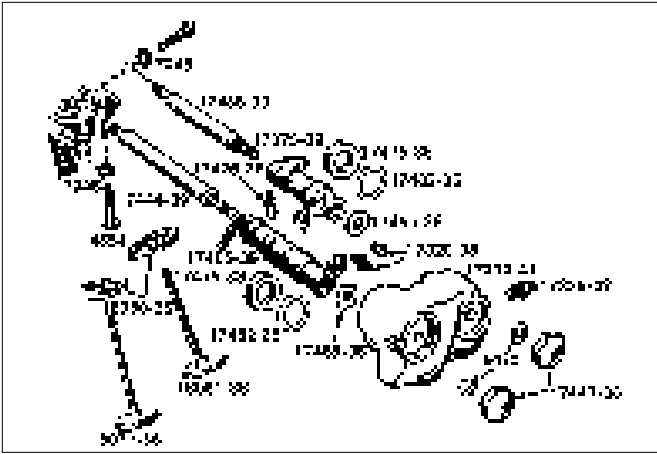

Knuckle Top End Parts

Chrome nuts are sold in a set of 4. Thrustwasher sets include 4 packing washers (17482-36) and 4 thrustwashers (17465-36).

PCP	OEM	Description
12008	469-15	Washer (469-15)
12007	6475	Brass nut washer (6475)
19321	17300-36 17310-41	Rocker box set, natural finish
1797	17320-38	Drain tube fitting
8941	17325-42	Oil feed fitting
5113	17465-36 17482-36	Thrustwasher and seal washer set
14025	17475-38	Oil seal (5 pk)
79087		James, as above
19199	18050-36	Valve seat
25252	18256-37	Rocker cover base gasket
19475	18600-36 18610-36	Tappet block set
9622	2329	Tappet block screw, parkerized, (set)
8103	2329	Tappet block screw, cad, (set)
2158	2329	Tappet block screw, chrome, (set)
1692		Chrome nuts without o-rings
19476	17425-36	Rocker arm ball stud

Knucklehead Rocker Arm Shafts

1939-47 (17435-39, 17438-39, 17441-39, 17444-39)
2676 Set of 4

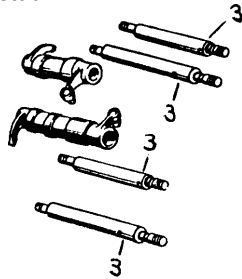

1936-47 Knucklehead Cam Followers

Eastern Size	Type
1078	STD Intake (18491-36)
1079	.005 Intake
1080	STD Exhaust (18493-36)
1081	.005 Exhaust, Eastern

Jims Machining

31607	STD Intake, Jims big axle
31110	STD Intake, Jims std
31608	.005 Intake, Jims big axle
31111	.005 Intake, Jims pin
31605	STD Exhaust Jims big axle
31116	STD Exhaust, Jims pin
31606	.005 Exhaust, Jims big axle
31117	.005 Exhaust, Jims pin

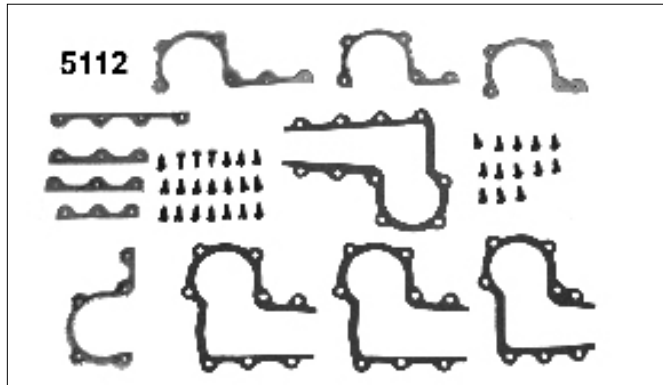
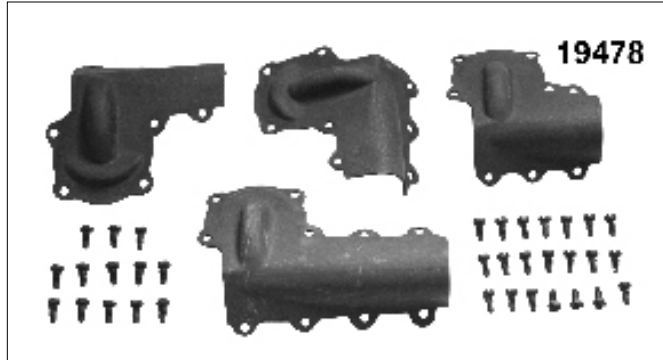

Knucklehead Rocker Parts

PCP	Description
19477	Chrome replica rocker cover set
19478	Parkerized rocker cover set
5112	Zinc rocker cover strip and gasket set
19479	Parkerized rocker cover strip and gasket set
19359	Chrome cover strip and gasket kit
25253	Rocker cover gaskets only
24555	Parkerized rocker cover screws (3477) (34 pk)

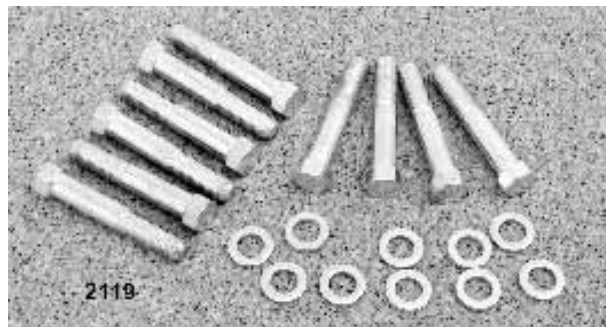

OHV Knuckle Head Bolts and Washers 1936-47

1936-39 Knucklehead with washers	PCP	Finish
	2118	Cad
	5212	Chrome
	9725	Parkerized
1940-47 Knucklehead with washers		
	2119	Cad
	9726	Parkerized
Washers only 1936-47 OHV		
	2009	Cad
	2008	Chrome
	2010	Parkerized



Knuckle Parts



Rocker Box Mounting Kit

Stock replacement hex head bolts machined from solid bar as original in choice of cad or chrome plating. Fits Knucklehead 1936-47.

5369	Chrome Plated
5370	Cad Plated
9699	Parkerized



Replica Knucklehead Parts 1936-47

PCP	Description
30208	Cam cover (25216-36)
212965	Andrews stock cam



Knucklehead Rocker Cover Set 1936-47

Authentically reproduced steel covers with screws. Set of 4.

19477	Chrome replica
19478	Parkerized



Knucklehead Top Motor Mount Kit

Fits 1936-47, 61 & 74 Model OHV

19053	Black (1938-47)
19055	Chrome (1938-47)
19330	Black (1936-37)



Rocker Box and Cam Cover Oil Feed Line Fitting Kit

Duplicate of oil feed line fittings used on Knucklehead 1942-47. Replaces OEM 17330-42 and 17325-42.

PCP	Description
1741	Chrome (shown)
8941	Cad



Rocker Feed Line Nipple

Fits feed oil line 1936-41 OHV, vent line 1937-64 45's. (33615-36)

5297	Cad
-------------	-----



Knucklehead Rocker Box Drain Tube Fittings

Fits all Knucklehead motors 1938-47.

1797	Set of 4
-------------	----------



Banjo Style Oil Feed Line Fitting Kit

OEM 3572-36B banjo bolt, 95-36 threaded bushings, 3615-36 cam cover fitting and 3572-36C brass washers fit Knucklehead 1936-41.

PCP	Description
9847	Chrome
9848	Cad

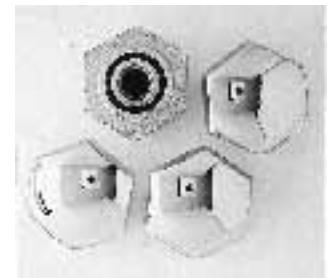

Knuckle Nut Set

Duplicate of original part except the addition of a positive O-ring seal to prevent oil leakage. Contains 4 nuts and 4 seals. Fits all Knucklehead engines 1936-47.

1692	
-------------	--

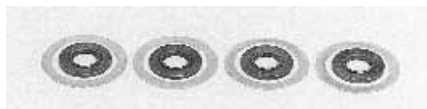

Knucklehead Rocker Arm Thrust Washer

Precision-machined, heat-treated replacements for Knucklehead 1936-47.

5113	Replaces OEM 17465-36
-------------	-----------------------

Rocker Shaft End Nut Kit

OEM 7831 nuts and lockwashers fit Knucklehead 1936-47.

PCP	Description
9840	Chrome
9841	Cad
9842	Parkerized

Knuckle Parts



Replica Knuckle Cylinder Sets

Cylinders feature cast iron construction, original markings with black painted surfaces and are pre-fitted with cast pistons and Hastings rings.

PCP	Application	Compression
53062	1936-47 61"	7.5:1
53063	1941-47 74"	8.5:1

Cylinder and Piston Kits

Cylinders are honed and pre-fitted with stock compression cast pistons and Hastings rings. They are ready to run and will require break-in as suggested in the appropriate shop manual. Sold in pairs for stock stroke only. Order gasket set separately.

PCP	Application	Compression
53057	1936-47 61" Knuckle	7.5:1
53058	1941-47 74" Knuckle	8.5:1
53059	1948-65 Panhead	8.5:1

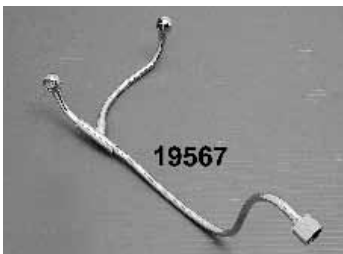
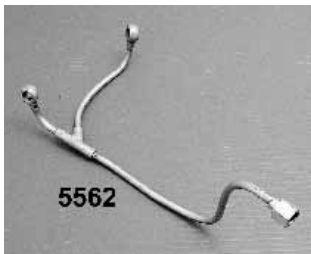

Top Oiler Knucklehead 1936-47

1936-41 is banjo type. 1942-47 is flared nut type

PCP	Year	Item	Finish
5562	1936-41	Banjo line	Tin (3573-36)
19567	1936-41	Banjo line	Chrome (3573-36)
19438	1936-41	Banjo bolt	Cad (63578-36) (ea)
9848	1936-41	Banjo nipple kit (banjo bolt & washer)	Cad
9847	1936-41	As above	Chrome
14007	1936-41	Washer for above	(6440) brass (5 Pk)
21009*	1942-47	Oil line	Chrome (63480-42)
3843*	1942-47	Oil line	Cad (63480-42)
8941	1941-47	Line fittings	Cad (17330-42, 17325-42) (3 pk)
1741	1941-47	As above	Chrome
5297	1936-41	Line fitting for timing cover	Cad (33615-36)
9701	1936-41	As above	Parkerized

*Note: Nut type ends



Knucklehead Cylinders

4835	61 cu. in. front 36-47 (6-36)
4837	61 cu. in. rear 36-47 (7-36)
4833	74 cu. in. front 41-47 (16483-41)
4841	74 cu. in. rear 41-47 (16491-41)



Banjo Style Oil Feed Line Fitting Kit

Kit to fit 1936-41 Knucklehead includes banjo bolt (3572-36B), threaded bushings (95-36), cam cover fitting (3615-36), and brass washers (3572-36C).

PCP	Finish
9847	Chrome
9848	Cad

Knuckle Parts

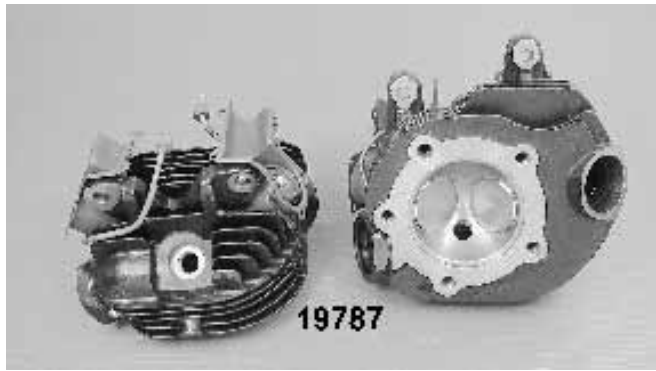

Replica Knucklehead Head Set 1937-47

Feature original cast iron with black finish. Head sets include valves, springs, collars, guides with parkerized upper and lower valve cover sets installed.

PCP Type of Head Set

- 19787 With valves
- 19788 With rocker assembly
- 19789 With rocker assembly and chrome covers



Knucklehead Lower Valve Spring Cups 39-47

Parkerized set includes 4 piece lower cover set with oil lines and nuts attached. Also includes rocker cover strip set with parkerized screws and chrome or parkerized cover set with gaskets.

- 19517 Kit with parkerized covers
- 19518 Kit with chrome covers



Knucklehead Rocker Arm and Shaft Kit

Includes 4 forged steel rocker arms with ball studs installed and 4 matching shafts.

19791



Knucklehead Rocker Box Set 1938-47

PCP Finish

- 19321 Natural
- 19790 Polished

Rocker Mounting Bolt and Washer Kit 1936-47

- 5369 Chrome
- 5370 Cad
- 9699 Parkerized



Tappet Block Kit 1936-47

Includes 4 standard size lifters with adjusters and raw finish tappet blocks.

19792



Circuit Breaker Drive and Idler Gear

Fits 1936-69 BT. Order shims separately to fit. Available as lightening with holes or solid. *Note: for high lift cams.

- | PCP | Type | Style |
|-------|-------|------------------------|
| 30121 | Idler | Solid (25775-36) |
| 19661 | Idler | Lightening (25775-36) |
| 30120 | Drive | Solid (25850-36A) |
| 19664 | Drive | Lightening (25850-36A) |
| 19663 | Drive | Solid (25850-36B) |

Hardware

MOTOR CASE NUT, BOLT AND STUD KIT

These complete motor case kits from Colony contain all the necessary hardware to bolt together the Harley motor cases. Each kit is packaged for the specific application. There are no universal "fits all" kits. We know that a rebuild job can be only as good as the nuts and bolts that hold it together. Available 3 ways: Stock W/cad plating; Stock W/chrome plating; Acorn W/chrome plating.



Acorn	Stock	Stock	
Chrome	Chrome	Cad	Application
	1671	5175	Motor case kit Flathead 1936-39
	1672	5177	Motor case kit Flathead 1940-48
5178	1673	5179	Motor case kit O.H.V. BT 1936-39
5180	1715	5181	Motor case kit O.H.V. BT 1940-47
	1716	5183	Motor case kit Big Twin 1948-64
5184	1752	5185	Motor case kit Big Twin 1965-69

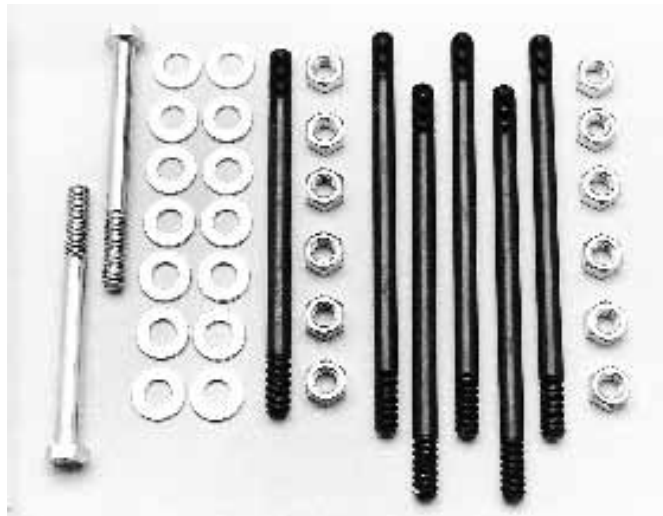

MOTOR CASE NUT BOLT & STUD KIT

Reproduction motor case kit duplicates original equipment on Harley '45' 1937-1952. Kit contains case alignment studs, plain studs, nuts and bolts. Available in chrome or cad plating.

5288	Chrome Plated
5289	Cad Plated



HEAD BOLTS

They are accurately machined from high strength steel and hardened to original Harley specifications to prevent stretching. All bolts feature rolled threads for superior strength and fit. All bolts, nuts, and washers are plated for corrosion resistance and clean appearance.

HEAD BOLT KITS

Cad	Chrome	Description
2116	5210	Harley '74' and '80" with aluminum heads
2120		Harley '45' with aluminum heads
2117		Harley '45', '74', '80' with cast iron heads
2118	5212	Knucklehead 1936-39 includes washers
2119		Knucklehead 1940-47 includes washers
9726		As above, parkerized
1820	5214	Panhead/Shovelhead 1948-up includes washers

HEAD BOLT WASHER KITS

Cad	Chrome	Description
2121	5209	Harley aluminum flathead washer kit
5200	8488	All Harley with 7/16 bolts
2010		As above parkerized



Cam Cover BT 1936-69

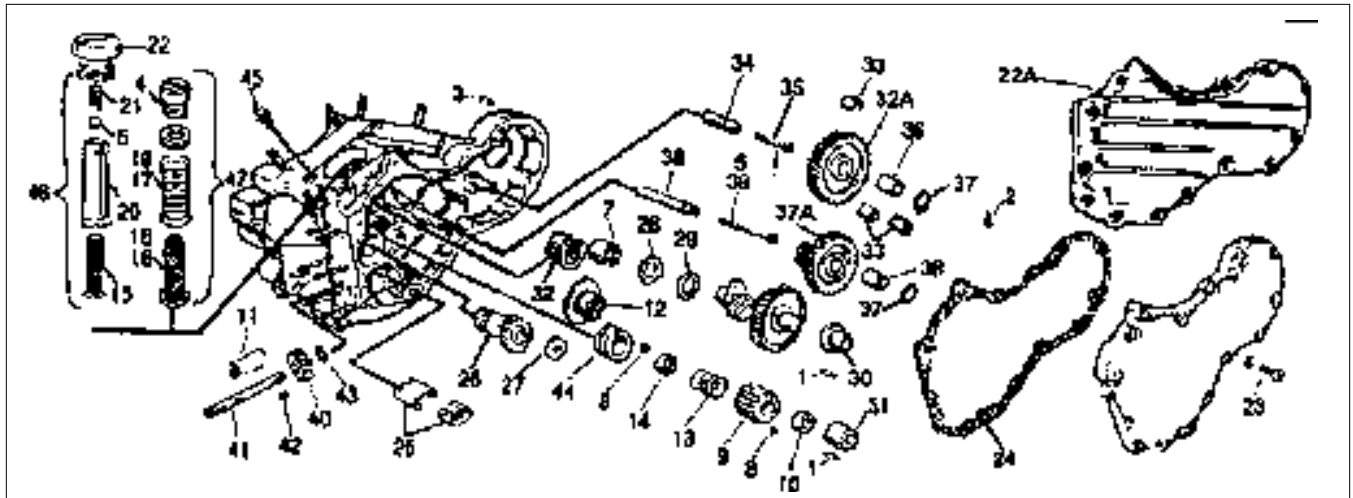

	PCP	OEM	Description	Year	U/M		PCP	OEM	Description	Year	U/M
1	10155	275	Dowel/Pin (2) 1/8x1/4	41-69	10 Pk	29	13526	25554-36	" " .070	41-*	5 Pk
2	10195	327	Dowel Pin 1/8x3/4	41-69	10 Pk		13527	25555-36	" " .075	41-*	5 Pk
3	10196	377	Dowel Pin Gear Cov (2)	41-64	Pair		13528	25556-79	" " .080	41-*	5 Pk
	10114	378	Dowel Pin Gear Cov	65-69	Pair		13529	25557-79	" " .085	41-*	5 Pk
4	10580	655	Plug Oil Screen	66-69	Each		13530	25558-79	" " .090	41-*	5 Pk
5	24501	1430	Screw Circuit L/H	L59-69	Each		13531	25559-79	" " .095	41-*	5 Pk
6	15570	8856	Ball, Oil Screen	52-57	10 Pk		13532	-	" " .100	41-*	5 Pk
7	15607	9058	Bearing Cam	58-*	Each		13520	-	Asst. of sizes .050-.095		10Pk
8	10306	23985-54	Key Pinion (2)	54-89	10 Pk	30	18511	25581-36	Bush Cam Cov STD	41-69	Each
9	30114	24010-39	Pinion Gear	39-53	Each	31	18512	-	Bush Cam Cov +.005	41-69	Each
	334124	24010-54	Pinion Gear	54-77	Each		18515	25582-36	Bush Pinion STD	36-53	Each
10	12544	24023-54	Nut, Pinion	54-*	Each		31362	-	As above, Jims		
11	18510	24641-36	Bushing, Pump	36-*	Each		18516	--	Bush Pinion +.005	36-53	Each
12	3387	24697-40	Pinion Seal Ring	40-53	Each		31363	-	As above, Jims		
13	13123	24699-37	Spring Pinion	39-69	5 Pk		18517	25582-54	Bush Pinion STD	54-E73	Each
14	2781	24703-40	Spacer, Pinion	40-53	Each		31364	-	As above, Jims		
	1193	24703-54	Spacer, Pinion	54-*	Each		18610	--	Bush Pinion +.005	54-E73	Each
15	13400	24975-52	Oil Screen	L52-62	Each		31365	-	As above, Jims		
16	N/A	24975-63	Oil Screen	63-E66	Each	32	18529	25597-36	Bush Inner Cam STD	36-57	Each
17	13125	24979-63	Oil Screen Spring	63-E66	Each		31378	-	As above, Jims		
18	13402	24981-66	Oil Screen	66-69	Each		18530	--	Bush Inner Cam .005	36-57	Each
19	13126	24982-66	Oil Screen Spring	66-69	Each		31379	-	As above, Jims		
20	30116	24985-52	Check Valve Body	L52-62	Each	32A	30121	25775-36	Idler Gear	36-69	Each
21	13128	24992-52	Spring Oil Screen	52-62	Each	33	18534	25785-30A	Bush Idler Gear (3)	41-69	Pair
22	3585	24987-52	Cap Check Valve	L52-65	Each	34	1088	25791-36	Idler Gear Stud	36-69	Each
22A	30210	25216-48	Cast cam cover	36-53	Each	35	24506	25794-36	Idler Gear Stud Screw	36-69	Each
	30211	25216-58	Cast cam cover	54-62	Each	36	1199	25800-36	Space/Idle/Circuit (2)	41-69	Each
23	5362	25218-63	Bolt, Oil Passage	63-69	Each	37	11058	25810-15	Snap Ring/Idler (2)	32-69	10 Pk
24	79278	25225-36C	Gasket Cam Cover	41-69	10 Pk	37A	30120	25850-36A	Circuit Drive Gear	36-69	Each
25	30118	25275-36	Breather Screen	36-69	Kit	38	1089	25856-36	Stud/Circuit Gear	36-69	Each
		25279-36	Seperator Breather	41-69		39	24507	25859-36	Screw/Drive Gear	41-58	Each
26	30128	25300-36	Steel Breather	48-77	Each	40	650	26345-39	Drive Gear Pump 25T	39-72	Each
	30135	25313-73	Steel Breather Valve	41-77	Each	41	1406	26346-36	Shaft, Oil Pump	41-67	Each
27	11540	25313-50	Thrust Washer .115	50-E79	5 Pk		1408	26346-68	Shaft, Oil Pump	68-*	Each
	11541	25314-50	" " .120	50-E79	5 Pk	42	10310	26348-15	Key Pump	36-69	10 Pk
	11542	25315-50	" " .125	50-E79	5 Pk	43	11060	26348-36	Snap ring	36-69	10 Pk
	11543	25316-50	" " .110	50-E79	5 Pk	44	30110	26349-39	Gear, Oil Pump	39-53	Each
	11544		Set of above	50-E79	4 Pk		781	26349-54	Gear, Oil Pump	54-72	Each
28	11529	25550-57	Lock Washer	58-*	5 Pk	45	10572	63526-57	Fitting Oil Line	57-*	5 Pk
29	13521	25555-84	Cam Washer .045	41-*	5 Pk	46	2961	-	Tappet Screen Kit	52-57	Kit
	13522	25550-36	" " .050	41-*	5 Pk	47	2989	--	Tappet Screen Kit	66-69	Kit
	13523	25551-36	" " .055	41-*	5 Pk						
	13524	25552-36	" " .060	41-*	5 Pk						
	13525	25553-36	" " .065	41-*	5 Pk						

* Must use 1979-82 Steel Thrust Washer

Cam Cover BT 1936-69



S&S Circuit Breaker Drive Gear BT 36-69
334215 Std clockwise rotation (25850-36A)

S&S Idler Gear Assembly BT 36-69
334216 Replaces 25775-36

S&S Circuit Breaker Gear
 Gear with roll pin fits BT 1936-69 and features std clockwise rotation. Replaces OEM 32531-36.
334217

S&S Generator Crankcase Gear Kit BT 36-69
 Includes circuit breaker drive gear and idler gear assemblies, circuit breaker gear and two shims. Features std clockwise rotation.
334226

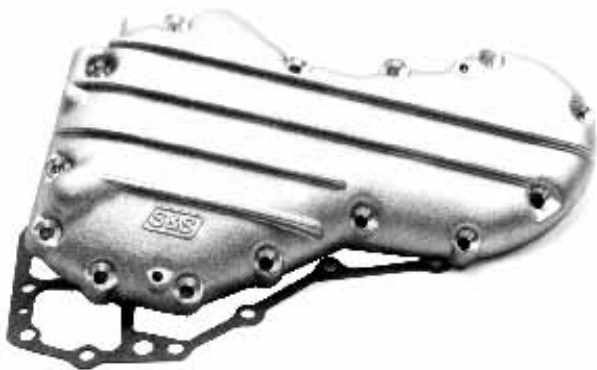

S&S Gear Cover Kit 1954-62
 Kit includes installed bushings, gasket, and extraction screws. Requires 1954-69 pinion shaft and mounting screws with countersunk heads.
 Replaces OEM 25216-54,65,66.
310200 Allen head bolts included for 1958-69 pinion shaft
310240 1954-62 Requires counter sunk screws 1/4-20 on cover and 5/16-24 for generator
310201 1936-53 requires 1936-53 pinion shaft and countersunk screws (not included)



S&S Shafts
312037 Intermediate shaft 1936-69
312038 Idler gear shaft 1936-69



BT Steel Breather Valve 41-47
30135 BT 1941-47 (25313-73)



Cam Bushing Kit
 BT kits include cam and gear shaft bushings/bearings with lock pins and thrust plate.

BT Kits
15403 1958-69
15404 1954-57
15405 1936-53



BT Pinion Parts 1937-69
 Kit is complete with all parts necessary for the application.
PCP Application
19296 BT OHV only 1936-53 (5 pcs)
19297 BT 1955-69 (4 pcs)
19298 45 Side Valves 1937-73 (2)
19299 74 & 80 Side Valves 1940-48 (2 pcs)



BT Circuit Breaker Stud & Bushing Kit
PCP Application
30145 BT 1959-69
30144 BT 1936-58
30143 BT 1936-69 (kit does not include screw)

Cast Cam Covers



Flatside Style Cam Cover

Cover features natural finish aluminum with bushings installed. PCP #30214 accepts oil passage bolt.

- 30214** 1963-65 stock (25216-65)
- 30218** 1963-65 chromed
- 30215** 1966-69 stock (25216-66)
- 30219** 1966-69 chromed

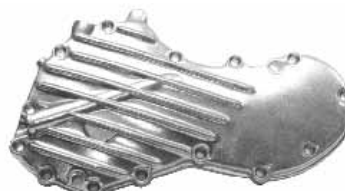

30209



30210



30211



334243



334249

BT Steel Breather Gear and Valve Gear Kits

Machined breather valve and gear by S&S. Designed to replace the stock steel or plastic OEM parts. Offered in stock duration only in stock O.D. and +.030 oversize (for use in worn or damaged breather holes). Washers are also available separately in sets

- | PCP | Description |
|-----------------|--|
| 334243 | Gear only, Std size 1936-47 (25300-36) |
| 334245 | Gear only, +.030 1936-47 |
| 334246** | Gear only, Std size 1948-77 (25313-73) |
| 334247** | Gear only, +.030 1948-77 |
| 334249 | Washer set, 8pc, 1939-99 |

****NOTE:** Must be used with 1954-77 pinion & cam gears, and steel spacing shims

Big Twin Gear Cover 1936-69 (Natural Finish)

Covers are available in finned stock finish with bushings and breather pipe included. Sputhe version fits 1941-69, less bushings and allows the use of a nose cone style cam and ignition unit. Features an improved oil separator and can be used with side or end pinion shaft oiling. Covers must be reamed for final fit.

PCP	OEM	Description	Year
30207	584-37	Stock, smooth	1937-39
30208	25216-36	Stock with 8 fins	1940-47
30209	25216-48	Stock with 8 fins	1948-53
30210	25216-48	Stock with 4 fins	1948-53
30211	25216-58	Stock with 4 fins	1954-62
2160	Screws	Chrome, 1/4 x 24	1936-69
5192	Screws	Cad, 1/4 x 24	1936-69
9621	Screws	Parkerized, 1/4 x 24	1936-69
9794	Screws	Chrome, 1/4 x 20	1936-69
9795	Screws	Cad, 1/4 x 20	1936-69
9796	Screws	Parkerized, 1/4 x 20	1936-69
5362	Screw	Chr oil passage bolt	1963-69
8772	Screw	Cad oil passage bolt	1963-69

Colony Cam Cover Screws

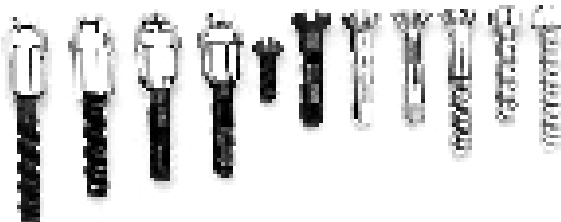

Stock O.E.M. Style

- | PCP | Application |
|--------------|---------------------------|
| 2160 | BT 1936-70 chrome |
| 5192 | BT 1936-70 cad |
| 9621 | BT 1936-69 parkerized |
| 9794* | BT 1936-69 chrome 1/4-20 |
| 9795* | BT 1936-69 cad 1/4-20 |
| 9796* | BT 1936-69 parker. 1/4-20 |
| 8895 | XL 1954-70 cad (9 pack) |

*Note: Special thread for aftermarket 1/4-20 cases



Chrome Allen Style

- | PCP | Application |
|-------------|--------------------------------|
| 5347 | BT 1936-69 |
| 9827 | BT 1936-69, aftermarket 1/4-20 |



Chrome Forged Alloy Cam Cover BT 1948-62

- 30216** 1948-53 with 4 fins
- 30217** 1954-62 with 4 fins



Chrome Acorn Style

- | PCP | Application |
|-------------|-------------|
| 1703 | BT 1936-70 |

Cylinders & Hardware



Chrome Pushrod Cover Kits

These chrome plated pushrod covers have a decorative grooved pattern that will add a custom look.

5105 Panhead/Shovel 1948-84



Complete Pushrod Cover Kit

All parts from top to bottom fit all V-Twin engines. Visible parts are all chrome and includes upper covers, inner cover, and lower covers.

PCP	Fits
1954	BT Knuckle 1936-39
1953	BT 74" Knuckle 1940-47
1952	BT Panhead 1948-65



ORIGINAL STYLE

Cylinder Base Nut Kits

These cylinder base nuts are exact duplicates of the stock Harley part. Each kit contains 8 nuts and 8 lockwashers and is available in chrome or cad plating for the following:

2154 Sportster and '45's Chrome
5168 Sportster and '45's Cad



BT Timing Cover Screw Kit 1950-52

PCP	Finish
72101	Chrome
72102	Cad



HEAD BOLT KITS

Cad	Chrome	Description
2116	5210	Harley '74' and '80" with aluminum heads
2120		Harley '45' with aluminum heads
2117		Harley '45', '74', '80' with cast iron heads
2118	5212	Knucklehead 1936-39 includes washers
2119		Knucklehead 1940-47 includes washers
9726		As above, parkerized
1820	5214	Panhead/Shovelhead 1948-up includes washers



Lifter Base Screw Kit 1950-53 BT Models

PCP	Finish
72099	Chrome
72100	Cad

HEAD BOLT WASHER KITS

Cad	Chrome	Description
2121	5209	Harley aluminum flathead washer kit
5200	8488	All Harley with 7/16 bolts
2010		As above parkerized

Push Rods

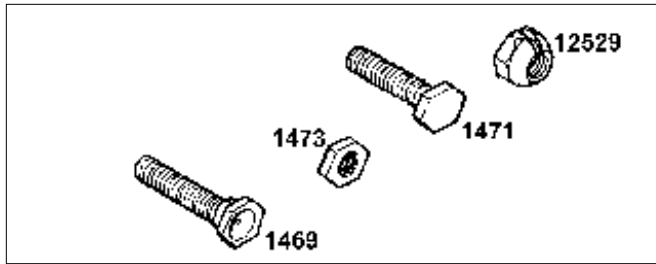

Tappet Adj. Screws & Nuts

PC # Fits

- 1469** Screw BT (18555-36) (4 pk)
- 1470** Screw XL (18554-57) (4 pk)
- 1471** Screw. Flathead (18556-40) (4)
- 12529** Split Nuts XL, BT (18570-38)(4 pk) 9/32x32 1915-84 p/rods
- 1473** Flat Nut. 5/16-24 aftermarket tappets(4 pk)

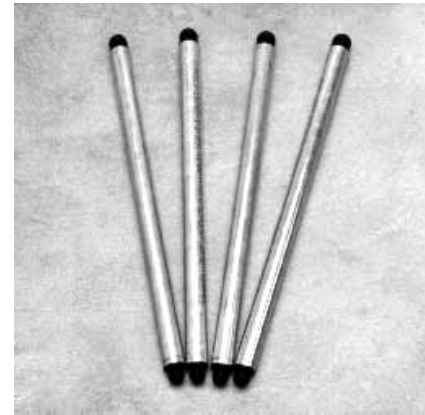

Aluminum Alloy Pushrod Kits

Lightweight pushrods are made from aircraft grade aluminum tubing and have heat treated steel ends providing maximum durability and expectancy.

PCP Description

- 1701** 74 1948-52
- 1770** 61 1948-52
- 1763** Knucklehead 74 1936-47
- 1769** Knucklehead 61 1936-47
- 1764** Panhead with Shovels 48-52
- 1702** Sportster 1957-85

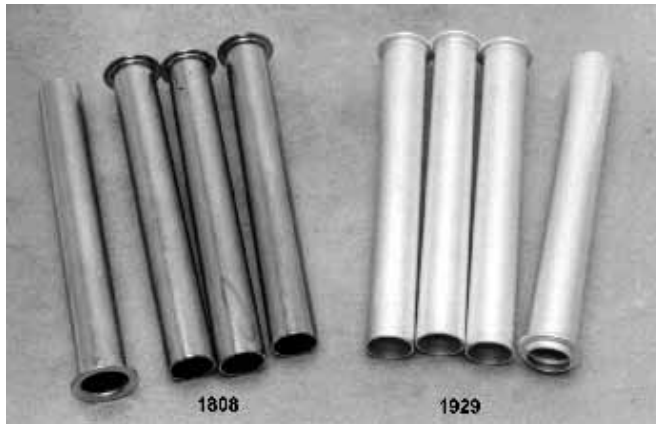

Upper, Inner Pushrod Covers

Shovelhead (Longest Length) inner pushrod covers fit Sportster 1957-1984 and O.H.V. Harley 1936-up.

- 1808** Cork Seal Style
- 1929** Quad Seal Style



Stock Valve Spring Kits

Each valve spring kit is manufactured from top quality materials. Heat treated with machined ground end for a perfect fit. Available for all 1948-83 BT and 57-Up XL's. Made in USA.

Valve Springs

PCP	OEM	Year	Model
32006	18203-57A	57-80	Sportster
32002	18201-41	29-73	45" Side Valves
32000	18200-30	30-48	74 & 80 Side Valve



Pushrod Tappet Adjuster Locknuts

Split locknuts with 9/32-32 thread fit 1915-1984 Singles, Flatheads, O.H.V. BT, 45's, XL and K models (18570-38).

- 12529** Stock lock nuts 9/32-32 thread (4 pack)
- 12623** Replacement locknuts 5/16-24 thread (10 pack)



Valve Spring Kits (Eastern)

Includes all springs, collars and keepers necessary for each application.

PCP	Model	Year	Replaces
32010	45"	32-40	18201-32, 18222-30, 18228-30
32011	45"	41-73	18201-41, 18222-30, 18228-30
32012	74-VL	30-36	18200-30, 18221-30, 18222-30, 18228-30
32013	74 & 80 UL-ULH	37-48	18200-30, 18221-30, 18222-30, 18223-37, 18228-30
32014	61 & 74	36-47	18201-57B, 18204-36A, 18221-36, 18222-36, 18228-36



45 Lower Valve Spring Collars 1932-73

- 30011** 4 Piece set (18220-30)

Pistons



Piston Kits

Each piston kit includes 2 pistons, 2 pins, 4 clips, and a cast ring set.

EL Models = 3-5/16" 61" O.H.V. 1936-52

Flathead 74 = 3-5/16" 74 UL model

Flathead 80 = 3-7/16" 80 UL model

Size	EL Models	Flathead 74	Flathead 80
STD	35510	35520	35530
.010	35511	35521	35531
.020	35512	35522	35532
.030	35513	35523	35533
.040	35514	35524	35534
.050	35515	35525	35535
.060	35516	35526	35536
.070	35517	35527	35537
.080	35518	35528	35538



45 Models 1919-73 (2.745 OD) Sold EACH

Standard compression pistons with pins. Cast ring sets sold separately and packed for 2 pistons are available in 1/16" compression and 3/32" compression.

Size	Piston	Cast Rings (for 2 pistons)	
		1/16"	3/32" old style
STD	35800	35000	35008
.010	2710	35001	35009
.020	652	35002	35010
.030	653	35003	35011
.040	654	35004	35012
.050	655	35005	35013
.060	656	35006	35014
.070	657	35007	35015

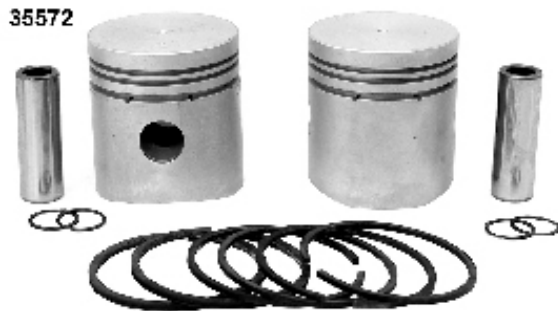

Sportster K Model Piston Kits

Kits include 2 cast alloy flat pistons, complete cast ring set, 2 wrist pins, and 4 circlips. All BT and Flathead pistons have a steel expansion control strut cast as original.

K Model SV 2.745 Bore

PCP	Size
35570	STD
35571	.010
35572	.020
35573	.030
35574	.040
35575	.050



45 Models 1919-73 (2.745 OD)

Standard compression piston kits with complete ring sets.



Size	Piston		Ring Sets (2 pistons)	
	1/16" Top	3/32" Top	1/16"	3/32"
STD	35580	35500	35000	35008
.010	35581	35501	35001	35009
.020	35582	35502	35002	35010
.030	35583		35003	35011
.040	35584		35004	35012
.050	N/A		35005	35013
.060	35586		35006	35014
.070	35587	35507	35007	35015



Piston Pin Locks

PC #	OEM #	Type	Year	U/M
11048	22581-32	Old "L"	41-52	Pair
11049	22582-52	Spiral	52-78	10 Pk

Guides & Valves

Model	STD	Rowe Cast Iron			
	OD	Size	Intake	Exhaust	
45"	.5645	STD	17600	17600	
		+ .001	17601	17601	
		+ .002	17602	17602	
		+ .004	17603	17603	
		+ .006	17604	17604	
Side Valve 1930-48	.5950	STD	17605	17605	
		+ .001	17606	17606	
		+ .002	17607	17607	
		+ .004	17608	17608	
		+ .006	17609	17609	
Knucklehead 1936-47	.6438	STD	17610	17651	
		+ .001	17611	17652	
		+ .002	17612	17653	
		+ .003	17613	17654	
		+ .004	17614	17655	
		+ .006	17615	17656	

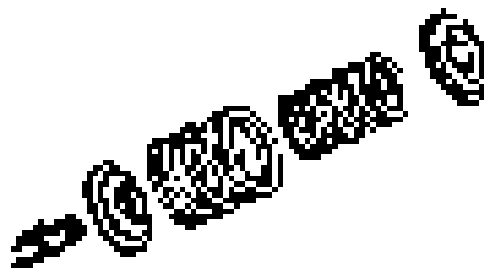

Valve Collars 61-74-80 OHV

PC #	OEM #	Use	Years	Model
30000	18222-36	Lwr	36-47	61 & 74 OHV
30001	18222-48	Lwr	48-79	61 & 74 & 80
30004	18221-36	Upr	36-80	61 & 74 & 80



Rowe Knuckle Valves with Machined Heads

Head	Standard		Black Nitride	
	Intake	Exhaust	Intake	Exhaust
STD	32200	32201	32202	32203

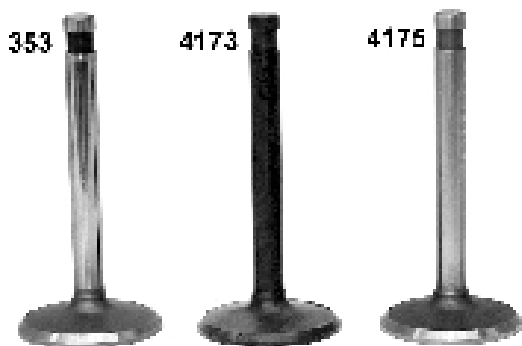

Panhead Valves with Forged Stems 1948-65

Head	Standard		Black Nitride		Hard Chrome	
	Intake	Exhaust	Intake	Exhaust	Intake	Exhaust
STD	353	352	4173	2706	4175	2707
OS			32143	-	-	-



Preston Valves with Forged Stems

Model	Head	Standard	
		Intake	Exhaust
45 Flathead	STD	32140*	32140*
VL '30-36 S/V	STD	4161*	4163*
74-80 UL 1937-48	STD	4165	4167
As above Rowe	STD	32135*	32135*
As above, Burnished	STD	32136*	32136*
1937-48 SV UL	STD	30015	30016
1937-48 SV	OS 1/8	4384	4386
1936-47 Knuckle	STD	30017*	30018*
1936-47 Knuckle	OS 1/8	4187	4185

* Rowe black nitride



K-Model Valves

32132	18070-52	Intake 1952-53
32134	18070-34	Intake 1954-56
32133	18080-52	Exhaust 1952-56

Shifter Kits



Rocker Type Clutch Pedal Assembly

Late type rocker clutch designed for use on all FL's 65-up with a aluminum type inner primary and handshift. Will work on BT 36-51. When installed on any 1965-up FL, PCPspecial #4336 clutch release arm must be used. Replaces OEM 36810-65A.

90100 Chrome Complete

On late Alloy Primary Application 65-Up use the Alloy Spacer Block.

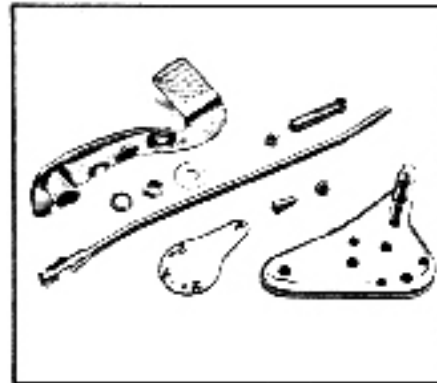
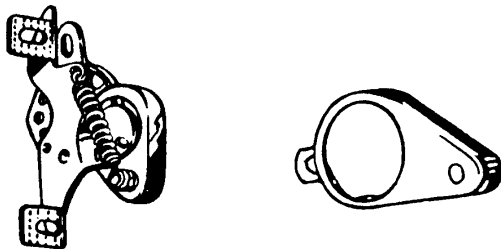

Competition Reverse Foot Shift Kit

Allows one up and all down shifting pattern for positive shifts. Available for 4 speed ratchet top units. Primarily designed for street or Sunday drag racing.

215 4-speed Ratchet

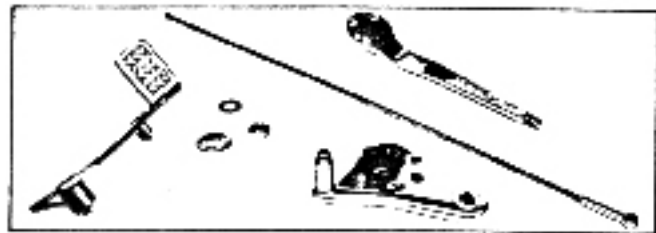

Jockey Shift Conversion Kit

Converts late model 74" foot shift and hand clutch to Jockey Shift with foot operated clutch. Fits all Big Twins 1952-64.

208 Complete Kit

213 Shift lever only 1952-78 (each)

Rocker Clutch Kit and Components

PCP	Application
90100	Chrome complete kit
59063	Black complete kit
9617	Colony chrome mounting kit
9618	Colony cadmium mounting kit
9619	Colony parkerized mounting kit
12643	Parkerized nut
4045	Chrome cover (36830-36)
19613	Black cover (36830-36)
13103	Black spring (36880-36)
4335	Chrome spring (36880-36)
19614	Black pedal (36811-65)
19615	Chrome pedal
19616	Black bracket (36841-41)
19617	Chrome bracket (36841-41)
19618	Friction parts kit
19619	Chrome rod lever (36816-65A)
16216	Spacer block (1.250 thick) (36869-70)
11670	Spring washer (5 pack) (36906-36)
11671	Shaft washer (5 pack) (36913-41)
11672	Friction disc (5 pack) (36899-41)
18712	Bushing (36857-36)
10845	Spring Stud (each) (36871-40)



Chrome Clutch Lever Rods

PCP	Application	Length"
211	Suicide Clutch 36-64 (36917-36)	18-3/8"
1259	Rocker Clutch 65-78 (36917-65)	16-7/8"
210	Mousetrap 1952-67 (36918-52)	22-3/8"
82015	Mousetrap 1965-67 (36918-65)	19-3/4"
212	Rod End 1936-E78 (36916-36)	Sm. Hold
1430	Rod End 1952-67 (foot shift) (36916-52)	Lg. Hole

Shifter Kits



Police Style Jockey Shift Kit

This kit fits all Big Twin 4-speed Hand Shifts 1936-79.
4511

Black Shifter Ball ONLY

1-1/2" diameter. Fits Big Twin 1941-65.
4334 33745-31

Spacer for Foot Clutch Assembly

Cast alloy replaces 36869-70. Necessary for foot clutch installation on 74 & 80's with cast alloy primaries.

16216 FL models 1965-78 (1.250)
16245 Custom use (1.750)

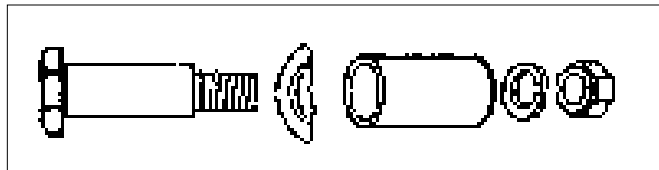

Shifter Lever Stud and Bushing Kit

Colony kit includes necessary hardware required to mount shifter lever on 1936-54 BT with handshift. Spring steel wave washer is furnished to help prevent rattles.

PCP Description
9711 Parkerized kit
9018 Chrome kit

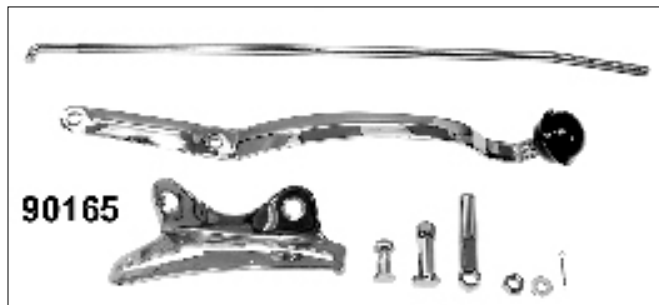
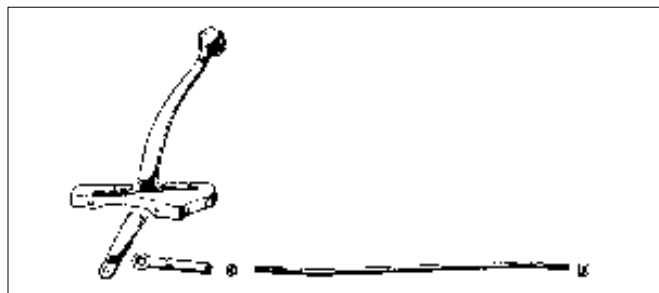

90165

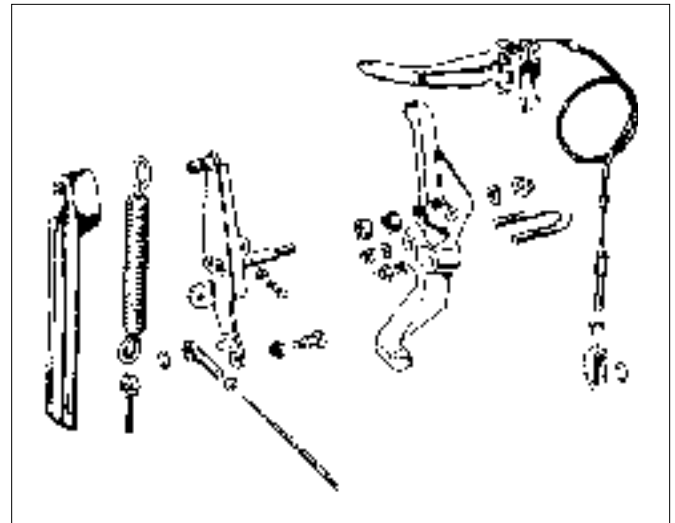

Mousetrap Clutch Booster Assembly

Fits Big Twin with Foot Shift 1952-67.
4508 Complete kit as shown

Component List For PCP #4508.

PCP	Application	Finish
1430	Rod end (36916-52)	Chrome
210	Pull rod (36918-52)	Chrome
9203	Rod end bolt (36921-52)	Chrome
9204	Rod end bolt (36921-52)	Cadmium
19620	Booster bracket (38456-52)	Aluminum
19282	U clamp (each) (38460-52)	Zinc
19621	Bell crank (38472-52)	Zinc
2428	Spring cover (38495-52)	Chrome
13196	Booster spring (38498-52)	Chrome
13104	Booster spring (38498-52)	Black
24100	Eye bolt (38502-52)	Black
15620	Needle bearing (each)(38505-52)	
539	Complete cable (38618-52)	
1417	Handle assembly (45002-65)	Polished alloy

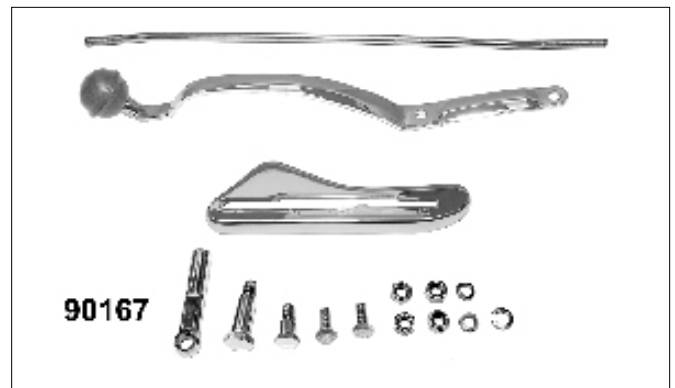

90167

Hand Shifter Lever Kit

Kit includes correct gate, rod, end, pivot bolt and shift lever in chrome for left hand mounting.

PCP	Application
90165	1936-46 BT 4 speed
90166	1947-50 BT 4 speed with hook
4510	1951-65 BT 4 speed
90167	1947-65 BT 3 speed & reverse
90168	1947-64 Ratchet top 4 speed
90195	1936-46 Ratchet top 4 speed
19799	1938-73 Chrome lever (33675-37A)
19612	1938-73 Painted lever (33675-37A)

Shifter Kits

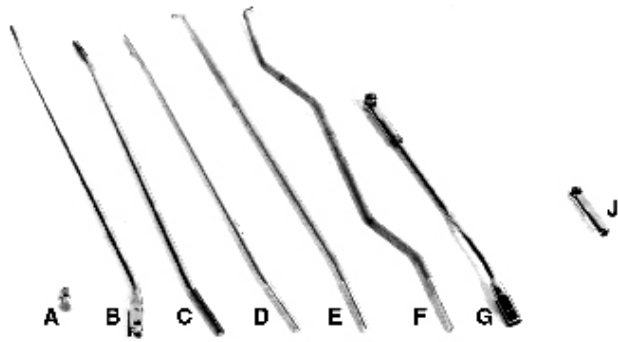

Jockey Shifter

Fits all Twins with Jockey Shift. One piece bolt-on, threaded for standard HD or custom ball. Replaces OEM 33675-37. 207

Shift Rod Applications

PCP	OEM	Application
221	33879-36	(A) Chrome shoulder bolt 1936-54 (ea)
2123	33879-36	As above, cadmium
9706	33879-36	As above, parkerized
82035		(B) Chrome hand shift with ratchet top, clevis end
82043	33857-51	(C) Cad hand shift 1951-65
82044	33857-66	(C) Chrome hand shift 1966-79
82037	33857-66	(D) As above, cadmium
82038	33857-36	(E) Cad hand shift, hook end 1936-50
82039		As above, chrome
82040	33859-41	(F) Cad 45" only hook end 1947-52
82041		As above, chrome
82042		As above, parkerized
37214		(G) Chrome complete FL 4 spd 52-84
220	33870-51	(J) Chrome rod end all models



Inner Shifter Arms

Fits 3 and 4 speed hand shift transmission tops.

PCP	Application
19275	1937-50 (34448-36)
19278	1951-65 with a 5/16x24 threaded hole (34448-51)
19564	1936-50 adapter arm to reverse shifting



Shifter Rod End Bolt Kit

Another quality reproduction from Colony. This end bolt will tighten a "sloppy" shifter assembly with the addition of the spring steel wave washer supplied in the kit. Fits Harley Davidson 1936-1954 with handshift, 1951-1964 with foot-shift.

2123 Cad (33879-36)

9706 Parkerized

Mousetrap Rod End Bolt

9204 Cad (36921-52)



BT Replica Foot Shift Kit 1952-69

Kit includes black bracket, cadmium rod assembly, zinc inner arm, chrome cover and shift lever.

90223 FL 1952-69

90224 FL 1970-84

BT Transmission

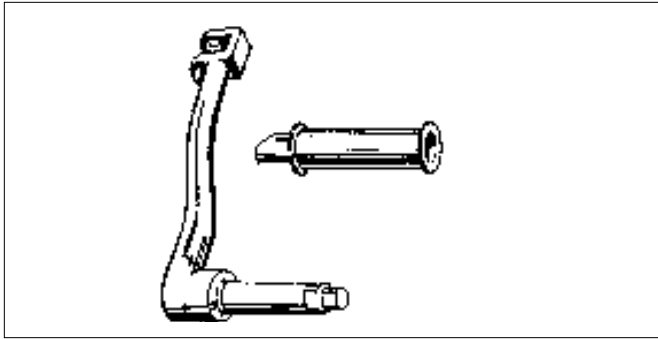

Replica One Piece FL Kicker Arm

Constructed of forged steel to fit BT 1936-53.

PCP Application

- 19625** Chrome arm 1936-53 (33063-36A)
- 19626** As above, black
- 19627** Black arm 1936-40 (33063-36)
- 19628** As above, chrome
- 19629** Black pedal 1936-40 (2091-16)



Clutch Lever Rod Bolt BT 1952-64

Reproduction shoulder bolt, nut & lockwasher

- 9204** Cad Plated (36921-52)



BT Transmission Top Cover Screw Kit

- 9620** Parkerized 1936-55 with box vent nipple

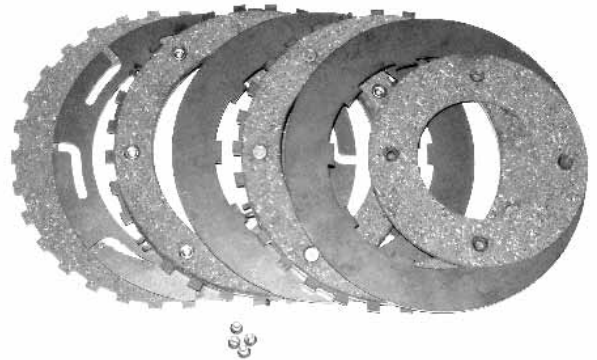

BT Clutch Plate Set 1936-40

Plate set with steel plates and fibers with clutch hub liner.
19595

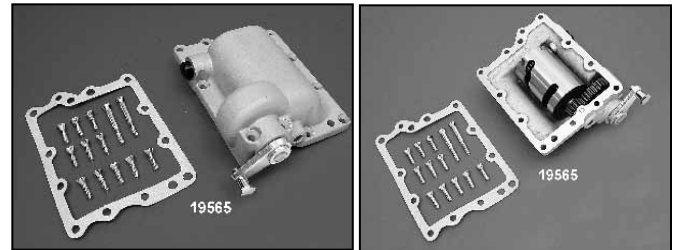

BT Hand Shift Jockey Top

4 Speed type with alloy finish. With or without neutral switch.

- 19565** Without switch
- 19623** With switch



BT Ratchet Top Shift Cam Follower Kit 1952-78

Kit includes bolt, follower, spring and lock tab.
12635



BT Transmission Top Cover Screw Kit 1950-53

- PCP** Finish
- 72103** Chrome
- 72104** Cad

O.E.M. STYLE HARDWARE KITS

Each kit contains all the stock engine nuts, bolts, washers and studs for your engine in choice of chrome or cad plating. The kit includes primary cover screws, lifter base screws, circuit breaker screws, case studs and nuts, timing plug, cam cover screws, cylinder base nuts and washers, oil pump nuts and bolts, transmission side cover nuts and washers, transmission top screws, transmission fill plug, generator screws, head bolts and washers. All hardware meets or exceeds original Harley specifications.



PCP Application

130	Panhead 1948-57	Chrome
131	Panhead 1958-65	Chrome
132	Shovelhead 1966-69	Chrome
5236	45 Alumin Heads 1937-73	Chrome
5226	Knucklehead 1940-47	Cad
5227	Panhead 1948-57	Cad
5228	Panhead 1958-65	Cad
5230	74" & 80" SV with cast iron heads 1936-39	Cad
5231	74" & 80" SV with cast iron heads 1940-48	Cad
5232	74" & 80" SV with aluminum heads 1940-48	Cad
5233	Shovelhead 1966-69	Cad
5235	45 with cast iron heads 1937-73	Cad
5237	45 with aluminum heads 1937-73	Cad

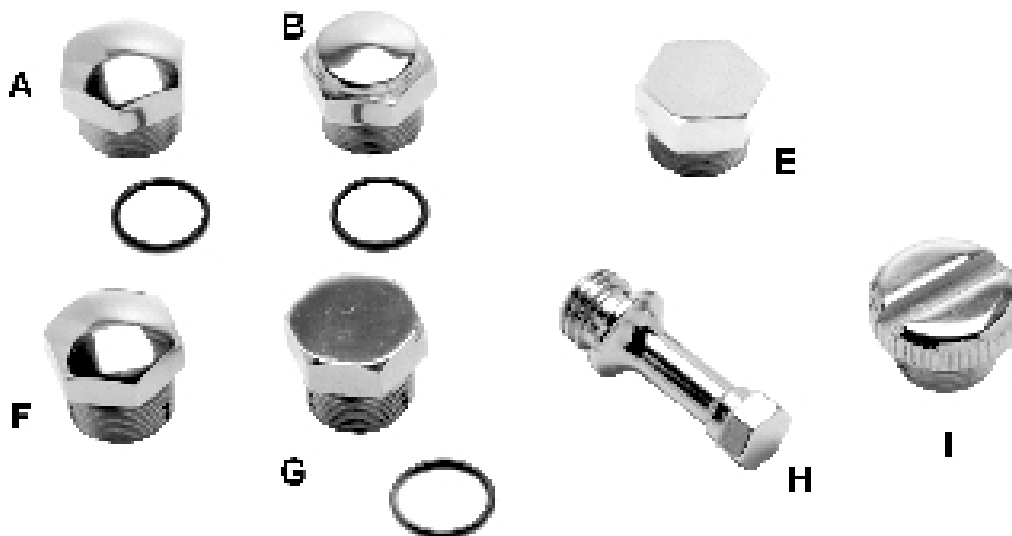
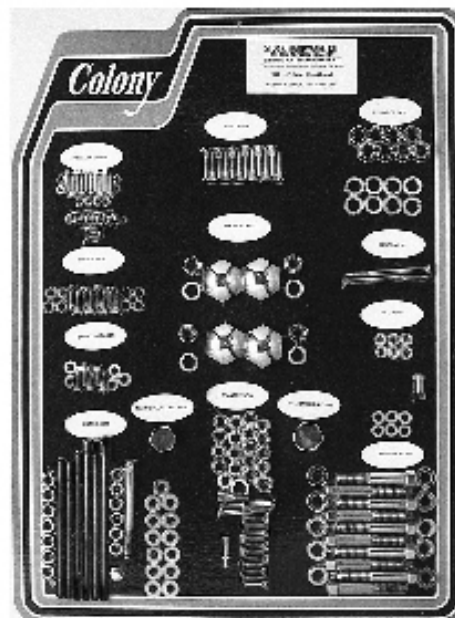

Transmission Plugs

- A. Custom fill plug for all BT 1940-up with 4 speed trans.
1743 Chrome Plated
- B. Custom cap style plug BT 1940-up with 4 speed trans.
5392 Chrome Plated
- E-G. Stock reproduction is available in standard or oversize self tapping for BT 1940-up with 4 speed transmission.
1482 Standard Chrome (E)
1780 Standard Cad (E)
- G. **5240** Oversize Chrome
5241 Oversize Cad
- F. Chrome plated custom fill plug is designed to restore

"pulled" threads in the Harley transmission side cover. Fits all Big Twins 1940-up with 4 speed transmission.
5240

- H. Stock reproduction for 45's 1941-up.
5298 Chrome Plated
5284 Cad Plated
9719 Parkerized
- I. Knurled transmission filler plug for BT 1958-80
9400 Chrome plated steel
9401 Brushed aluminum

45 Transmission

Transmission Filler/Timing Plug

Dual purpose fits all HD 1930 up to 1938. Adds custom look to Panhead, XL's and Shovelheads. Oil fill application on "45" models up to 1940. Dimension w/5/8-18 threaded.

- 3591** Chrome
- 5282** Cad
- 5283** Black Oxide

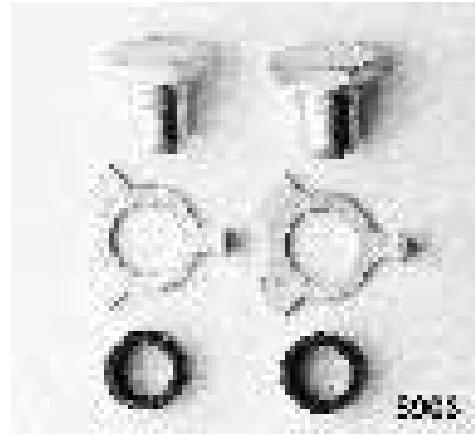

Clutch Arm Rebuilding Kit

Includes bearings, pivot bolts and locks to rebuild 45 clutch arm and sprocket cover.

- 8903** 45 Solo 1941-43, Servi-car 1941-73, chrome
- 19061** As above, cad
- 3584** 45 Solo 1944-52, chrome
- 5243** As above, cad



45 Jockey Shifter

Fits all 45 solo & trike 1941-73. Mounts to rear frame tube, linkage rod must be fabricated.

- 19065** Jockey Handle

45 Kicker Arm 1941-52 Solo

Replaces 33059-41.

- 19062** Black Solo
- 19063** Chrome Solo
- 19117** Black Servi Car



Clutch Arm Fulcrum Rebuild Kit

Reproduction of stamping to renew clutch arm to throwout bearing surface. OEM# 37052-44. Harley 45 1941-1973

8920

45 TRANSMISSION ROLLERS 1939-52 SOLO & 1953-54 SERVI CAR

2696	45 M/S Right Side Roller STD	(Set of 21) (9090)
2697	45 M/S Right Side roller +.0004	(Set of 21) (9091)
2698	45 M/S Right Side Roller +.0008	(Set of 21) (9092)
2696	45 C/S Left Side Roller STD	(Set of 21) (9090)
2697	45 C/S Left Side Roller +.0004	(Set of 21) (9091)
2698	45 C/S Left Side Roller +.0008	(Set of 21) (9092)
2699	45 C/S Right Side Rollers STD	(Set of 24) (9075)
2700	45 C/S Right Side Rollers +.0004	(Set of 24) (9076)
2701	45 C/S Right Side Rollers +.0008	(Set of 24) (9077)
1119	45 M/S Left Side Rollers STD	(40 used) (9084)
1120	45 M/S Left Side Rollers +.0004	(40 used) (9085)
1121	45 M/S Left Side Rollers +.0008	(40 used) (9086)



Shifter Lever Stud and Bushing Kit

This kit contains all hardware required to mount the shifter lever on 1936-54 Twins with hand-shift. A spring steel wave washer is furnished to help prevent rattles.

- 2124** Cad

45 Transmission

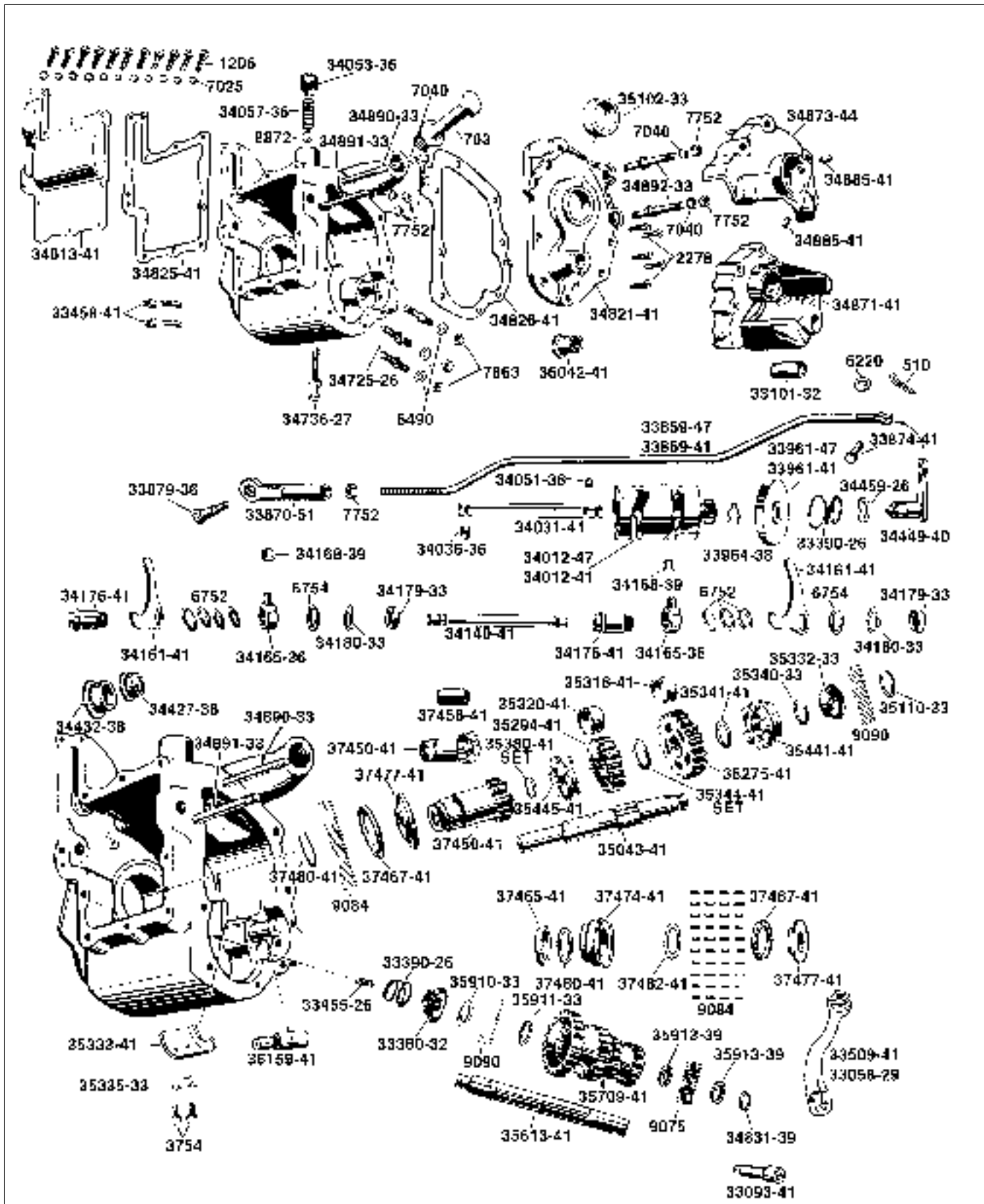

45 Transmission

45 Transmission Hardware

For 1938-73 3 Speed and 3 Speed with Reverse

PC#	OEM	Description	PC#	OEM	Description
3591	704	Fill plug, chrome up to 1940	19141	35275-41	Gear, mainshaft 1st
5282	704	Fill plug, cadmium up to 1940	19142	35284-41	Gear, reverse
5284	703	Fill plug, cadmium 1941-73	19143	35294-41	Gear, 2nd
5298	703	Fill plug, chrome 1941-73	18559	35316-41	Bushing, low gear
9719	703	Fill plug, parkerized 1941-73	18560	35320-41	Bushing, 2nd gear
9411	1206	Top & side cover screw kit 41-73, cad	19691	35326-33	Reverse gear bushing
9410	1206	As above, chrome	19144	35332-33	Spacer collar
9666	1206	As above, parkerized	19145	35340-33	Thrust washer, reverse gear (5 pk)
9300	2278	Cover screw, chrome (set)	19146	35341-41	Thrust washer, low gear (5 pk)
9301	2278	Cover screw, cadmium (set)	19147	35344-41	Thrust set, low & 2nd gear .040-.075
9687	2278	Cover screw, parkerized (set)	19692	33349-41	Low & second gear .050 washer
79700	33030-41	Gasket kit	19148	35380-41	Spacer set, mainshaft .075 to .115
19117	33058-29	Kick arm, Servi, black	19149	35441-41	Shift clutch, 45" low gear
13084	33084-41	Kick spring, black	19150	35442-41	Shift clutch, left and right (ea)
13167	33084-41	Kick spring, chrome	19151	35445-41	Shift clutch, 2nd and 3rd (ea)
9754	33088-41	Kick stud, chrome	19152	35612-64	Countershaft, electric start 1964-73
9755	33088-41	Kick stud, cad	19131	35613-41	Trans countershaft / kicker shaft
9756	33088-41	Kick stud, parkerized	19127	35709-41	Cluster gear, 45" trans 1941-63
19128	33093-42	Kick shaft	19154	35710-64	Electric start 1964-73
18540	33101-32	Bushing, starter gear	19155	35910-33	Outer thrust (5 pk)
19129	33380-32	Starter clutch	19156	35911-33	Inner thrust (5 pk)
13176	33455-26	Countershaft spring	19157	35913-39	End washer (5 pk)
19130	33456-26	Kick starter Tripper Screw (pr)	18627	36035-26	Left countershaft bushing
9761	33456-26	Tripper screw and nuts (4 pc)	18566	36042-41	Bushing, c/shaft side cov. 41-73
8628	33458-41	Nut (6 pk)	19158	36141-41	Reverse idler gear
19062	33059-41	Arm, black	3584	37077-44	Clutch arm rebuild, chr. 44-52 solo
19063	33059-41C	Arm, chrome	5243	37077-44	Clutch arm rebuild, cad 44-52 solo
19685	33874-41	Clevis pin	19061	37076-41	Clutch arm rebuild, cad 1941-43 solo
16527	34031-41	Shifter shaft cam	8903	37076-41	Clutch arm rebuild, chr. 1941-43 solo
19686	34051-38	Lock screw	2332	37287-41	Throw out bearing assembly 41-73
19132	34140-41	Shift fork shaft	19355	37335-41	Seal kit, clutch pushrod 1941-up
19126	34161-41	Shift fork	19160	37450-41	Transmission clutch gear
2481	34165-36	Shifter finger	18568	37458-41	Clutch gear bushing
1543	34168-39	Rollers, shifter finger (pr)	12556	37460-41	Clutch hub nut
19134	34176-41	Bushing, shifter finger	9533	37460-41	Clutch hub nut
18551	34427-38	Bushing, shifter shaft small	19021	37462-41	45" Clutch hub locktab
18553	34432-38	Bushing, shifter shaft large	14051	37465-41A	Seal, clutch gear (5 pk)
19687	34449-40	Inner shift lever	15729	37467-71	Thrust bearing
14083	34459-26	Seal, shift leather (10 pk)	19162	37474-41	Roller bearing race
19810	34702-41	45 Transmission case NOS	19163	37477-41	Clutch gear bearing race
931	34725-26	Aligning stud set (4 pk)	19164	37480-41	Clutch gear thrust washer, left side
9837	Kit	Trans mount kit, chrome	19165	37482-41	Countershaft washer (5 pk)
9838	Kit	Trans mount kit, cad			
9839	Kit	Trans mount kit, parkerized			
8625	34736-27	Adjusting screw, gear box cadmium			
9693	34736-27	Adjusting screw, gear box, parkerized			
9729	34736-27	Adjusting screw, gear box, chrome			
19135	34813-41	Cover, 45 trans access			
19136	34821-41	Cover, gear box			
14040	34831-39	Seal, case rubber (5 pk)			
19688	34873-41	Sprocket cover 1941-43 WL			
19137	34873-44	Sprocket cover 1944-53 WL			
19689	34873-44	Sprocket cover 1944-53			
8621	34892-33	Stud kit, sprocket cover, chrome			
8622	34892-33	Stud kit, sprocket cover, cad			
9686	34892-33	Stud kit, sprocket cover, parkerized			
19597	2272-33	Mainshaft 1933-40			
19138	35043-41	Transmission main shaft			
19139	35102-33	Outer race, main shaft			
19690	35102-33A	As above +.005			
19140	35110-33	Thrust washer, main shaft (5 pk)			
10313	35195-26	Trans sprocket key			
19101	35204-41	Sprocket, countershaft 17T			
13738	35216-26	Lock tab, sprocket (5 pk)			
14043	35221-36	Seal, mainshaft sprocket			

45" Mainshaft transmission rollers

Size	24 set	100pk	OEM
Std	2699	15300	9075
.0004	2700	15301	9076
.0008	2701	15302	9077

45" Countershaft and mainshaft rollers

Size	21 set	100pk	OEM
Std	2696	15303	9090
.0004	2697	15304	9091
.0008	2698	15305	9092

45" Mainshaft rollers

Size	44 set	100pk	OEM
Std	1119	15306	9084
.0004	1120	15307	9085
.0006		15308	9086
.0008	1121		
.0010	1122	15309	

45 Transmission



Side Valve Transmission Mainshaft

PCP	Application	Length
19597	1930-40 45 (2272-33)	10.655
19138	1941-73 45 (35043-41)	

Clutch Components 1936-40 BT

12656 Clutch hub nut kit (3 pc) (2275-38, 2548-36, 2471-36)

Clutch Spring Sets

13137 1937-40 UL, EL, FL, 1936-40 BT (2511-36A)
13142 1941-48 UL, 1941-73 45 SV (38077-41)

Colony 45 Trans Case Mount Studs 1929-on

9919 3 pack

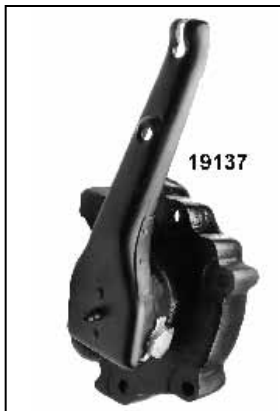

19137



19688



19689

Transmission Sprocket Covers 1941-53

PCP	OEM	Application
19688	34873-41	Sprocket cover 1941-43 WL
19137	34873-44	Sprocket cover 1944-53 WL
19689	34873-44	Sprocket cover 1944-53



Transmission Top and Side Cover Screw Kit

For 1937-73 45 models.

PCP	Finish
9410	Chrome
9411	Cad
9666	Parkerized

45 COUNTERSHAFT SPROCKET

Use on 1929-73 all models
 17 tooth, with seal, replaces 35204-41.
19101

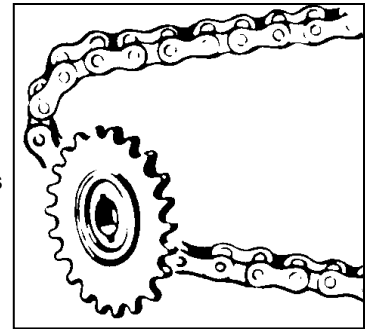

9837

Transmission Mounting Kit

PCP	Finish
9837	Chrome
9838	Cad
9839	Parkerized



Transmission Adjusting Bolt

Fits 1929-on 45's.

PCP	Finish
8625	Cad
9693	Parkerized
9729	Chrome

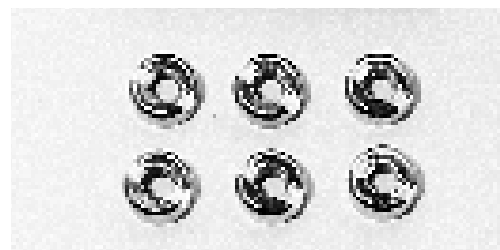

Slotted 1/4-24 Thread Nut Kit

8628 6 cad plated nuts



Sprocket Cover and Nut Kit

Reproduction of mounting hardware for 1935-73 45 models.

8621	Chrome
8622	Cad
9686	Parkerized

45 Clutch

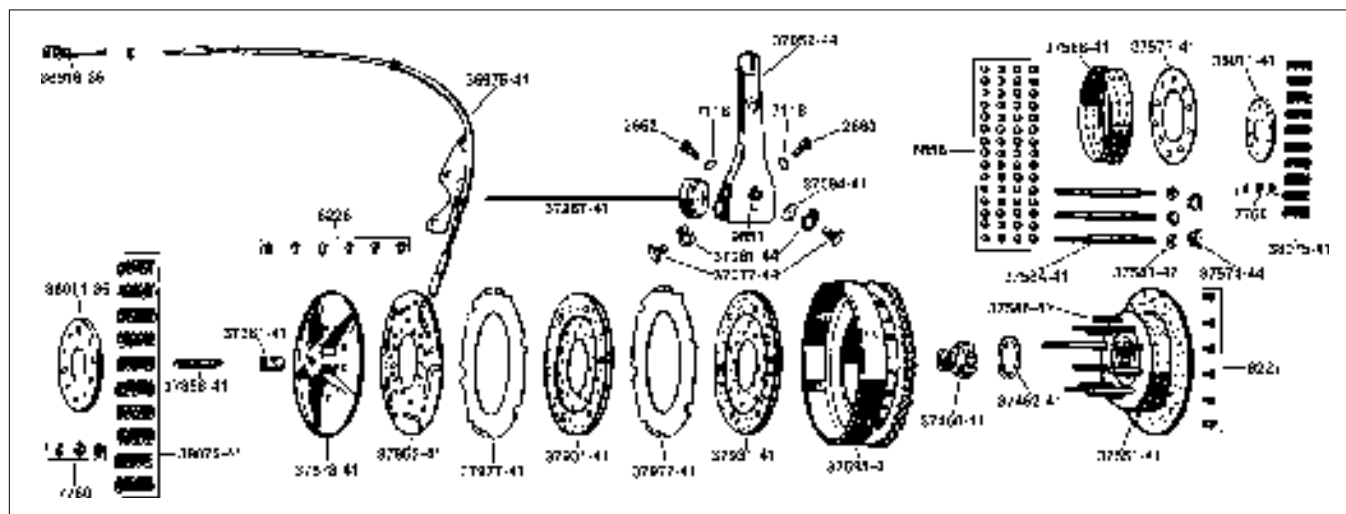

45 Clutch Hub and Related Parts 1941-73 Solo & Servi Car

PCP	OEM	Description	PCP	OEM	Description
10005	8227	Rivets (may be shortened for use on early drum). Chain wheel must be riveted to clutch shell (10 pk)	19021	37462-41	Lock tab
3639	36975-41	Cable assembly all 1941-73	9533		Hub nut with lock
19352		As above chrome	19800	37551-41	Hub (no cage or bearings)
19059	37052-44	Wide clutch arm all 1944-73	19133	37568-41	Ball retainer w. balls
8920		Fulcrum w/rivets all models	19185	37577-41	Bearing plate
19061	37076-41	Pivot arm bolt kit 1941-43 Solo, 1941-73 Servi, cad	19351	37584-41	Clutch stud set
8903		As above, chrome		37586-41	
3584	37077-44	Chrome pivot arm bolt kit 1944-52 Solo	19153	37590-41	Hub liner w. rivets
5243		As above, cad	19846	37695-41	Clutch drum
2332	37287-41	Throw out bearing assem. all 1941-73	19056	37713-69	Ring gear w/out rivets
19355	37335-41	Push rod seal kit all 1941-73	19187	37873-41	Releasing disc
19354	37358-41	Adjuster screw all 1941-73	38980	37931-41	Barnett clutch set
12555	37361-41	Adjuster nut all 1941-73 (5 pk)	19188		OEM type clutch set
12556	37460-41	Hub, nut	19350	37952-41	Outer spring disc
			3890	37977-41	Steel plate w. rattlers
			19186	38011-41	Pressure plate
			13191	38075-41	Clutch spring set all 1941-73



45 Pushrod Seal Kit

19355 Includes all parts pictured

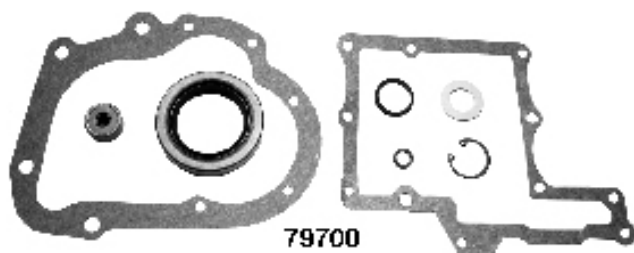

James Transmission Gasket and Seal

Set includes double lip main drive gear oil seal.

Replaces OEM# 33030-41.

79700 1941-73 W, WL, G, GE

25650 PCP kit, as above



Clutch Gear Nut

Fits 45 Solo and Servi-car 1941-on. Replaces 37460-41 clutch gear nut and 37462-41 lockwasher.

9533



Throwout Bearing Assembly

Replacement 45 clutch throwout bearing and pushrod for 1941-73 45's.

2332

45 CLUTCH

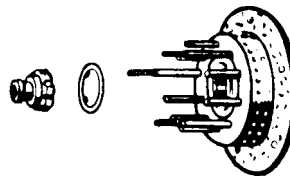

45 Clutch Hub 1941-73

Replaces 37586-41 on all Solo and Servi-Car models.

PC#	OEM	ITEM
19800	37551-41	Hub (no bearings or plate)
12556	37460-41	Hub Nut, 1929-73
19021	37462-41	Lock Tab

Harley's '45' Clutch Kit-Barnett

Consists of two full plates and one half plate. Made of aluminum alloy and bonded with our exclusive BarFlex 1 oil resistant friction material.

PCP	Description
38980	45's L1941-67
38914	Clutch springs (set of 10) (38077-41)

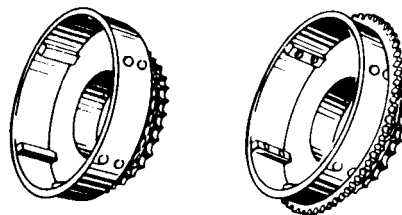

45 Clutch Drum

For 1941-73 models. Order ring gear separately.

PCP	OEM	ITEM
19846	37695-41	Clutch Drum
19056	37713-69	Ring Gear W/O Rivets 1969-73
10005	8227	Rivets (10)

Rivets may be shortened for use on early drums. Chain wheel must be riveted to clutch shell.



45 Clutch Hub Studs 1971-73

PCP	Size
19586	Long (37584-41) (3 pk)
19587	Short (37586-41) (7 pk)



Clutch & Brake Rivets

PC#	Type	Use
10002	Short 4 - 4-1/2	Brake (50 pk)
10003	Long 4-5	Brake (50 pk) (41871-31)
10004*	Short 7-4	Clutch (25 pk) (8226)
10005	Long 7-5	Clutch (10 pk) (8232)

* For Clutch Hub Friction Disc.

Steel Drive Plates

OEM type with anti-rattle balls riveted on. 45 type fits 1929-73.

3890 Each



45 Foot Clutch

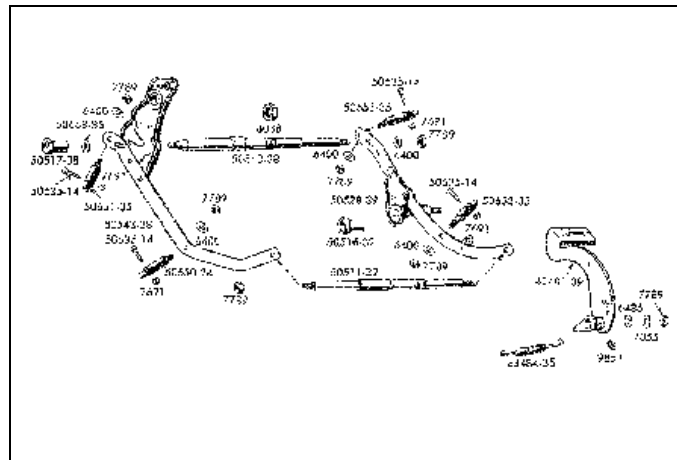
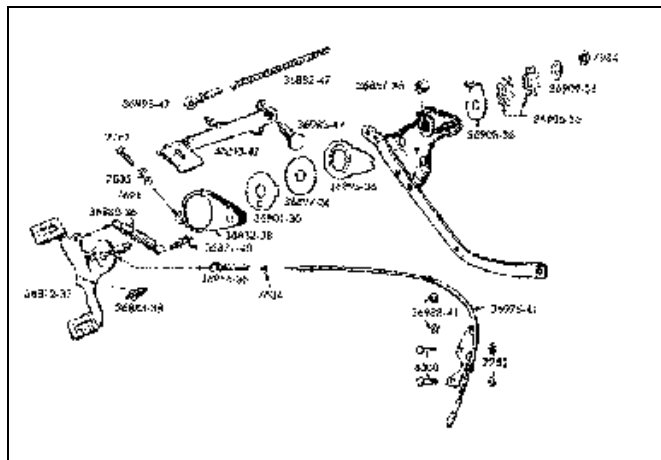

45 Clutch and Brake Lever & Parts Solo 41-52

PCP	OEM	Description
19568	36812-38	Rocker lever, chrome
19569	36812-38	Rocker lever, black
72351		Lever pivot shaft
19529	36832-38	Cover, chrome
19678	36832-38	Cover, black
18712	36857-36	Brass bushing for bracket
4335	36880-36	Spring, chrome
72353	36871-41	Spring stud
19679	36895-36	Bracket, friction disc (each)
19680	36897-36	Fibre washer (5 pack)
19681	36901-36	Steel disc (each)
11670	36906-36	Spider washer (5 pack)
19682	36908-36	Washer disc (each)
19683	36909-36	Lock plate (5 pack)
212	36916-36	Cable end
3639	36975-41	Cable assembly, parkerized
19352		As above, chrome
19646		8 Pc. Friction set/7984 nut

PCP	OEM	Description
19602	42401-39	Brake pedal, black
19603	42401-39	Brake pedal, chrome
13216	44484-35	Brake return spring (pair)
13234	44484-35	As above, chrome (each)
19654	50510-38	Front support rod, black
12654	50516-32	Rear rod nut (each)
12655	50517-38	C-Front rod end nut (5 pack)
9800		Rod end nut kit, chrome
9801		Rod end nut kit, cad
9802		Rod end nut kit, 32-73 parkerized
82109	50543-38	Chrome strap set (L&R)
	50528-39	
82110		As above, parkerized set
5500		Footboard supports, black
5364	50635-14	Footboard hinge bolt set
12657	7984	Rocker pedal nut (5 pack)

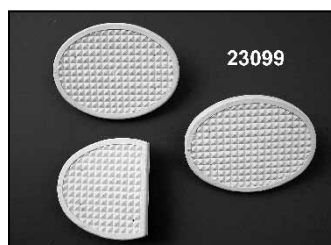
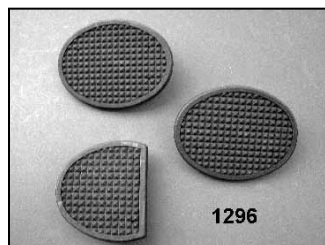

Clutch and Brake Rubber Pad Sets

3 Piece pad sets available in choice of white or black. Black oval pad #5453 sold as each. OEM replacement # 11791-45. Fits servi-car 1938-46 and Solo only 1947-50 (foot clutch models only).

PCP	Item
1296	Black 3 pc set
23099	White 3 pc set
5453	Black oval pad only

Shifter Lever Kit

Includes correct gate, rod, end, pivot bolt and shift lever in chrome for left side mounting. Note: pattern from front to rear.

PCP	Application	Type	Pattern
82111	1936-46 45 Servi	3 Speed & reverse	R1N23
82112	1936-46 45 Solo	3 Speed	1N23
82113	1947-73 45 Servi	3 Speed & reverse	32N1R
82114	1947-52 45 Solo	3 Speed	32N1
19693	1938-73 Lever	Chrome (33675-37A)	
19612	1938-73 Lever	Painted (33675-37A)	
2124	1938-73 Pivot bolt kit (33775-37)		

Hardware

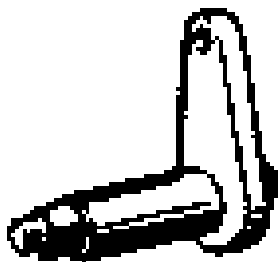

Inner Shifter Arms

Fits 3 and 4 speed hand shift transmission tops.

- 19275** 1937-50 (34448-36)
- 19278** 1951-65 5/16-24 thread (34448-51)

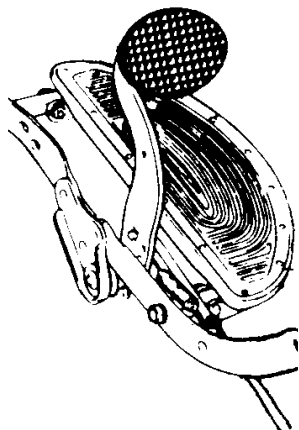

Oval Style Floorboard Rubbers

OEM replacement #50614-40. Fits FL, FLH 1940-65, and replacement type boards. Sold in pairs.

- 1363** Black

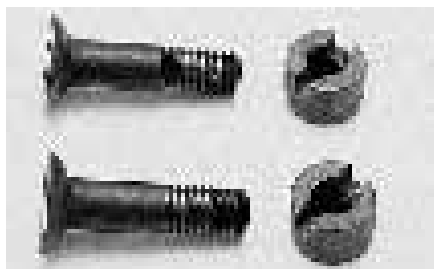

Kickstand Starter Tripper Bolt and Nut Kit

Parkerized, heat treated tripper bolt (33456-26) and slotted nut (33458-41) for use on 1941-63 45 models.

9761



SHIFT GATE CLAMP NUTS

Beautiful reproduction of the 2" hex nuts used to fasten shift gate to tank on 1916-35 all models and 1936 VL

OEM# 2210-16.

- 19016** Nickle Plated
- 19017** Chrome Plated



HAND SHIFT LEVER BALL

Black. Replaces OEM 33745-31. Use on all 1941-65 Big Twins. Sold each.

- | PCP | Description |
|--------------|--------------------------------|
| 19066 | 3/8 x 24 Stock H.D. small type |
| 19067 | 3/8 x 24 Stock H.D. large type |

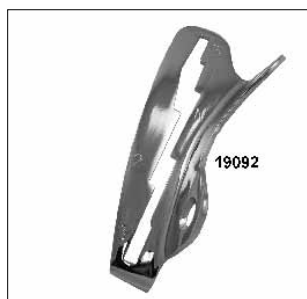

SHIFT GATE for 1940-46 Gas Tanks

Fits 45, 61, 74 and 80" models.

- | PC# | OEM | Description |
|--------------|----------|------------------------------|
| 19090 | 33785-40 | 3 Army, c/c 3 1/4 |
| 19091 | 33790-39 | 3 Chrome |
| 19092 | 33791-39 | 3 & R Chrome |
| 19093 | 33789-37 | 4 Chrome |
| 5207 | 33822-36 | 3 & R Chrome gate screws (3) |



SHIFT GATE for 1947-65 Gas Tanks

Late type for 74-80 & 45 models, fits 1947-65 tanks. 3 1/2" c/c mount holes

- | PC# | OEM | SPEEDS |
|--------------|----------|----------|
| 19094 | 33791-47 | 3 & R BT |
| 19095 | 33789-47 | 4 BT |
| 19096 | 33790-39 | 3 BT |
| 19534 | 33786-47 | 3 (45) |

