

# Section 13A

## Wheels

Axles and Hardware .....	17-22
Hub Parts & Caps .....	6-16
Rims .....	2-3
Spokes .....	4-5
Tubes .....	3
Wheels .....	7-11,14-15

# Chrome Rims



## 16" OEM Factory Style Chrome Rims "A"

16" Original drop centre rim design with deep indent for safety beads. Chrome rims have 40 spoke holes.

PCP	Width
6280	3.0 (as OEM w/large hole)
70735	As above, black powdercoat
70752	3.0 (as OEM w/small hole)
70753	4.0 (as OEM w/large hole)

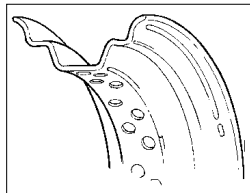
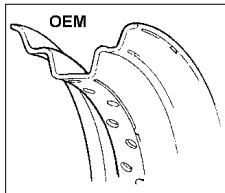

## Chrome Steel Wheel Rims

Drop centre style with rolled edges on 19" & 21" with high quality chrome plating. Features OEM style spoke dimple pattern and rim width for easy lacing and truing.

PCP	Size
70752	16"x 3.0" 1981-96 (43085-81)
70720	19" x 2.5" (DC) for 325-350 tire (43001-79)
70721	21" x 2.15" (43662-80B)

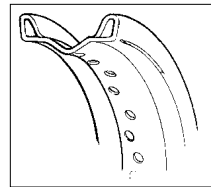

## Conventional Chrome Rims "B" style

This type is flat or English style. It will fit front tires only, available in the following sizes.

PCP	Diameter	Width (40 Spoke Holes)
6276	21"	1.85"
70765	19"	2.15" (for 3.50-4.00)
70740	19"	XL Front 1952-63 (replica)

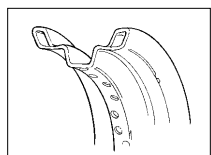

## Front Rims for Harley 19" "C"

Chromed drop center rim with rolled edge. Styled like the classic drop center, the rolled edge gives your front wheel additional strength. (Taiwan)

6282	2.50" x 19" (43018-73)
------	------------------------



## Topline Drop Centre Rims

Exact replacement, OEM quality and chrome plated.

PCP	Size
69800	16" small side hole 1981-96 (43085-81)
69801	21" small center hole 1980-on (43662-80B)

# Inner Tubes



## Rim Strips

Heavy, thick, rubber rim strips that offer maximum protection for any size inner tube.

PCP	OEM	Size	Stem Location	Qty.
3519	40575-77	16"	Side	10 Pack
3521	40576-77	18"	Centre	5 Pack
3523	40577-77	19"	Centre	5 Pack
3525	40578-80	21"	Centre	5 Pack
3527		16"	Centre	5 Pack



3491

3492

## Heavy Duty Tubes

Inner tubes are available for all types and sizes of tires. Butyl rubber for good air retention, carefully molded for uniformity and precision quality to provide for the finest service, long wear and security. Complete with metal valve.

PCP	Fits
3490	500/510 x 16MAG TR6—Metal Centre Valve
3491	500/510 x 16 HD TR15—Rubber Offset Valve
3492	500/510 x 16 HD TR6—Metal Offset Valve
3496	350/400 x 18 TR6
3497	400/450 x 18 TR6
3504	300/325 x 19 TR6
3505	325/350 x 19 TR6
3506	350/400 x 19 TR6
3507	275/300 x 21 TR6
3508	325/350 x 21 TR6



TR-6 VALVE  
STEM



TR-15 VALVE  
STEM



## Chrome Valve Stem Cover

Chrome cover for inner tube valve stems. Sold as 5 pack.

- 2452 Rubber valve stem type (flared)
- 2453 Steel valve stem type (bullet)

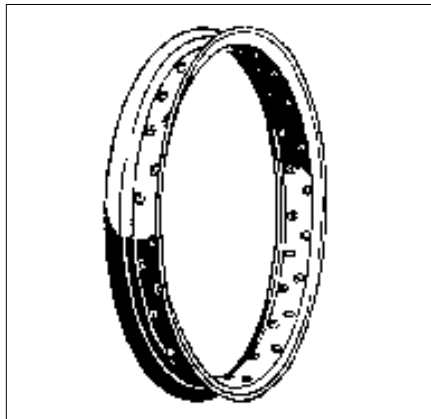

## 18" Steel Wheel Rim

PCP	OEM	Description
70736	43002-30	45 Front, black
70737	43003-30	45 Front, chrome
70738	43004-30	All rear, black
70739	43005-30	All rear, chrome

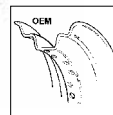

## OEM Factory Style Front Chrome Rim "D"

2.50" x 19" drop-centre 40 hole front rim with safety bead. OEM 43001-79 and 43018-73.  
6278 19" drop centre (Taiwan)



## 21" Drop Centre Rim "E"

Chrome plated rim with rolled edge as the H-D 21" wheel.  
6277 43662-80B

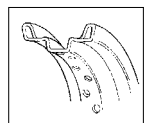

# Spokes

## Spoke Sets From Preston Cycle

We are able to offer a full selection of top quality chromed carbon-steel, polished or chromed stainless steel spoke sets. All our spoke sets feature 6/8 gauge construction, and our polished stainless steel sets have spokes and nipples made from different types of stainless material to minimize their seizing to each other. We do suggest the use of anti-seize compound on stainless steel spoke sets.

## Spoke Buying Guide

We show you the variety of stock and custom rims available from Preston Cycle for custom wheel building. Using our illustrations will help you determine which parts you have and then assist you to the spoke set you need. For example; if you have an aluminum 1978-83 FX model front hub, and you want to lace it with chrome steel spokes to the 21" drop centre rim from an FXWG (OEM 43662-80B or PC# 6277) which is shown in illustration "A", then you would need to use a PC# 925 spoke set. The rim illustration shows the basic rim shape, and the position of the spoke holes in relation to each other.



## Diamond and Twirled Spokes

Chrome Diamond	Chrome Twirled	Stainless Twisted	Use
3714	3710	43700	16 "DC (F & R) "A"
3716	3712	43702	21" DC/steel Wide Glide hub "B & E"



## Stainless Steel Twisted 16" Steel Spokes

A set of stainless steel spokes for 16" drop center rims. A new style of twist similar to our "Twirled" spokes.  
**43700** Set of 40 spokes and nipples



## 6/8 Gauge Nipple Set

Sold in packs of 40 to fit our spoke sets.

- 43096** Chrome standard
- 43097** As above stainless
- 43098** Chrome extended
- 43099** As above stainless

**Note:** When PC spoke kits are laced to 19" OEM #43001-79 rims PCP 43098 extended chrome spoke nipples must be used as the inside diameter of this rim is larger than others.



## Deluxe Spoke Wrench

Rowe spoke wrench to fit spoke nipples, sized one to six.  
**5849**

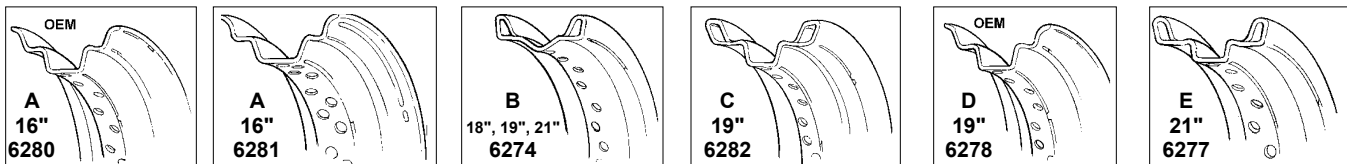

# Spokes



## Replacement Spoke Set

Heavy duty 6-8 wire gauge spoke set for all twins. Available in either chrome plated with chrome nipples or stainless with stainless nipples. Complete sets of 40 spokes and nipples.

**NOTE:** Use hub illustrations to select proper spoke sets. Note spokes available in chrome or full stainless.



## Stock Spoke Sets for DC Rim

- 43712 16" zinc spoke set 1936-on (43032-40C)
- 43717 16" cad plated set 1936-on
- 43711 18" cad plated set
- 43715 21" spoke set (43057-85B)

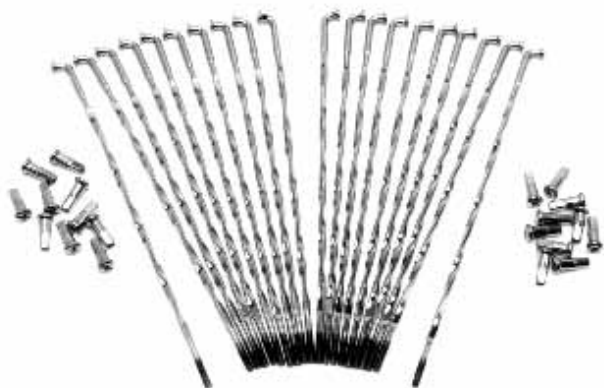

## Chromed Steel 16" Twisted Spokes

40 chromed steel spokes and nipples for 16" drop center rims. A new style of twist similar to our "Twirled" spokes.

- 43704 Set for 16" rims
- 43705 Set for 21" rims (Steel hubs)

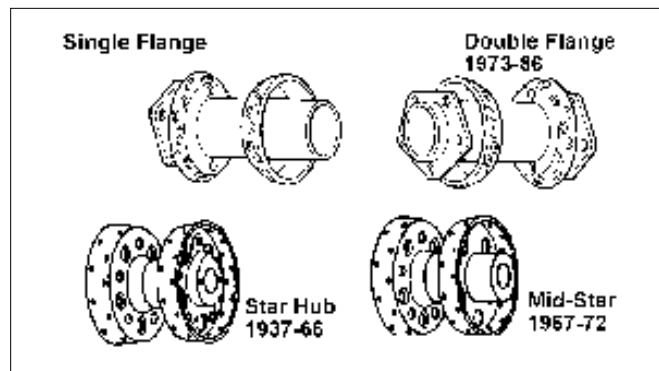

## Spokes for Spool Hub

Chrome	Stainless	Rim"	Rim Type
-	3604	15	A
916	3605	16	A
924	3606	18	B
919	3607	19	B
924	3606	19	C & D
920	3608	21	B & E

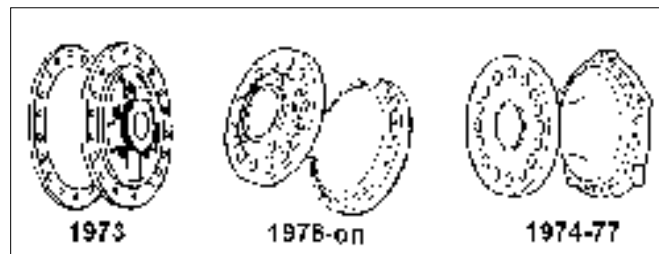

## Spokes for FX-XL Front Disc Brake Hub

Chrome	Stainless	Rim"	Rim Type
929	3609	19	C & D
926	3610	19	B
925	3611	21	B & E

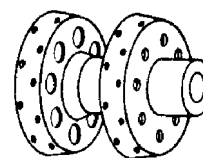

## Spokes for Sportster Rear Wheel Spool Hub

Chrome	Stainless	Rim"	Rim Type
-	3604	15	A
916	3605	16	A
930	3612	18	A
924	3606	18	B

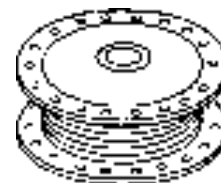

## FX-XL Front Drum Hub

Chrome	Stainless	Rim"	Rim Type
447	5797	19	C & D
927		19	B
928	5799	21	B

# 1936-66 Wire Wheels

## Star Hub Parts

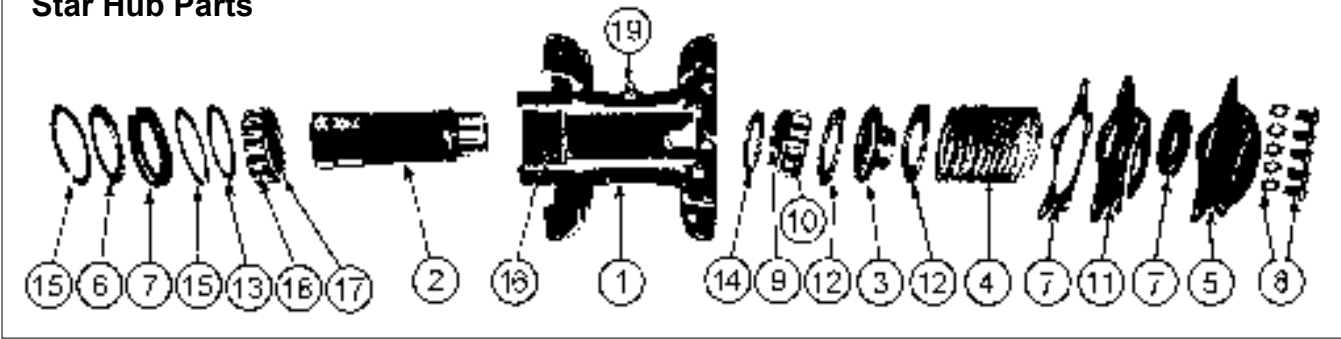

## BT Wheel Hub & Parts 1936-66

	PCP	OEM	Description		PCP	OEM	Description
1	<b>43075</b>	3958-36	Parkerized hub 1936-40, complete	10	<b>10729</b>	24721-30	Right Side Roller Retainer 1941-66
	<b>43073</b>	3958-36	Black hub 1936-40, complete	11	<b>3300</b>	43574-35	Inner Wheel Hub Cover 1936-66
	<b>2511</b>	43546-36B	Chrome hub 1941-66 complete	12	<b>3301</b>	43563-35	Thrust Washer 1941-66
	<b>43074</b>	43540-36	Black hub 1941-66, complete	13	<b>3302</b>	43558-39	Brake Side Washer 1936-66 (5 pk)
2	<b>1307</b>	43549-36	Rear Wheel Bearing Hub Sleeve 1936-66	14	<b>3303</b>	43552-39	Wheel Spacer 1936-66
3	<b>2338</b>	43556-36	Thrust Bearing Sleeve 1941-66	15	<b>11087</b>	43554-35	Wheel Thrust washer lock ring 1937-66 (10 pack)
4	<b>13581</b>	43560-35	Wheel Adjusting Shims 1941-66 10 Pack	16	<b>2346</b>	43561-39	Bearing Collar
5	<b>646</b>	43566-35	Chrome Star Wheel Cover 1937-66	17	<b>10732</b>	43578-35	Brake Side Roller Retainer 1941-66
6	<b>2512</b>	43564-35	Wheel Hub Dust Shield 1936-66	18	<b>2519</b>	9220	Left Rollers STD Set of 14
7	<b>2340</b>		Wheel Gasket Kit 1941-66		<b>2520</b>	9221	Left Rollers +.0002 Set of 14
	<b>79147</b>	43576-36	Wheel bearing cover 1935-66 (10)		<b>2521</b>	9222	Left Rollers +.0004 Set of 14
8	<b>1166</b>		Chrome Star Wheel Screws for wheel 1936-66		<b>2522</b>	9223	Left Rollers +.0006 Set of 14
	<b>1719</b>		Chrome Star Wheel Acorn Screws & Nuts for 1 wheel 1936-66		<b>2523</b>	9224	Left Rollers +.0008 Set of 14
					<b>2524</b>	9225	Left Rollers +.001 Set of 14
9	<b>2513</b>	9220	Right Rollers STD. Set of 12	19	<b>10511</b>	9851	Grease Fitting (10 pk)
	<b>2514</b>	9221	Right Rollers +.0002 Set of 12				
	<b>2515</b>	9222	Right Rollers +.0004 Set of 12				
	<b>2516</b>	9223	Right Rollers +.0006 Set of 12				
	<b>2517</b>	9224	Right Rollers +.0008 Set of 12				
	<b>2518</b>	9225	Right Rollers +.001 Set of 12				

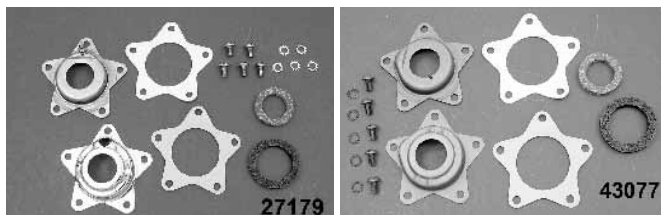

## Star Shaped Wheel Hub Outer Cover Screw Kit

Contains 5 head screws and 5 stainless steel lockwashers. Fits OHV Big Twin Harleys 1936-66.

- 1719** Acorn
- 3100** Cap
- 1166** Stock screws & lock washers (10 pcs) chrome
- 8201** Cad as above
- 9670** Parkerized as above

## Star Hub Cover Kit for 1936-66

This kit includes inner star, grease fitting, and outer chrome or parkerized star. Use as update on early star wheels 1936-66.

PCP	Finish
<b>27179</b>	Chrome
<b>43076</b>	Parkerized
<b>43077</b>	Parkerized (no fitting)
<b>25180</b>	Star gasket kit (10 pk) (43576-35)

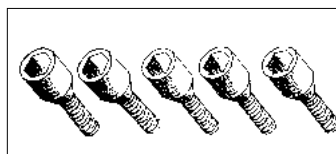

## Chrome Wheel Lugs

Fits all 61"-74"-80"-45" 1936-72 (43530-35A)

- 19227** Set of 5 (chrome)
- 19226** Set of 5 (black)

## Star Hub Cover With Hole

**44019** 1955-66 (chrome)



## Grease Fitting

Stock type grease fitting for all models 1941-up, use on swing arm wheel hubs, seat post, brake parts. Replaces 9851 zinc finish.

**10511** Grease fitting, Sold in 10 packs

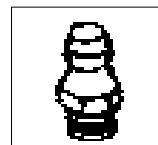

# Wheels and Hubs



## Internal Star Hub Component Kit

Includes internal rebuilding parts to assemble a bare hub. Includes standard rollers, order oversize rollers separately if needed. Does not include hub. Fits all interchangeable wheels 1941-66.

PCP	Model	Finish
43078	1955-66	Chrome
43079	1941-54	Parkerized



## Star Hub Wheel Assembly 1936-66

Wheel fits front and rear BT 1936-66. Stock replica wheel hub comes with loose type roller bearings and replaces 43540-36. Comes with chrome or stainless steel spokes.

Chrome	S.S.	Diam./Width	Description
70755	70756	16" x 3.00"	Chrome hub and rim
70757	70758	16" x 3.00"	Black hub, chrome rim
	70759	16" x 3.00"	Black hub and black rim
70778	70779	18" x 2.15"	Chrome hub and rim
70780	70781	18" x 2.15"	Black hub, chrome rim
	70789	18" x 2.15"	Black hub and rim



## Deluxe Star Hub Rebuild Kit 1936-66

Fits 1936-66 interchangeable hubs. Includes inner and outer stars, screws, gaskets, thrust washers, outer bearing sleeve, snap rings, cork retainer washer and standard rollers.

43080

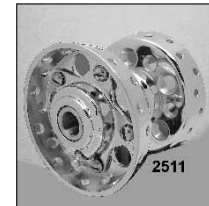

## Star Hubs

Completely assembled and includes all internal parts for front and rear.

PCP	Year	Finish
43075	1936-40	Parkerized (3958-36)
43073	1936-40	Black (3958-36)
2511	1941-66	Chrome (43540-36)
43074	1941-66	Black (43540-36)

# 1967-72 BT Wire Wheels

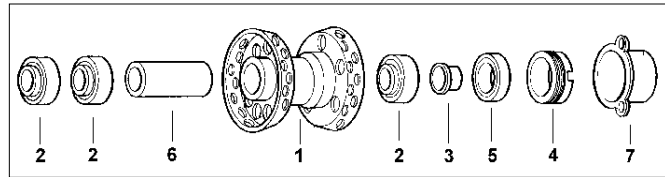

## 74 Wheel Parts 1967-72

PCP	Description
1 2335	Chrome 74 hub (complete) (43540-67A)
43071	Chrome hub (bare)
43072	Black hub (bare)
2 15733	Bearing (43577-67)
3 2525	Wheel hub spacer (41196-55)
4 12573	Wheel hub lock nut (43542-67)
5 14057	Wheel hub seal (41210-55) (5 pack)
6 2526	FX Axle wheel bearing spacer (43549-67)
7 3590	Chrome wheel bearing lock nut retainer cover. Fits FL, FX rear 1967-72; FL front 1967-71 (43592-70)
N/A 16277	Lock nut and seal kit



## Stock Style Wheel Assembly

1967-72 FL complete wheel assemblies. Each wheel is laced and trued with new components. Chrome plated.

### Without Internals

PCP	Diameter	Width
70760	16" Front & Rear	3.50"
6292	19" Front	1.85"



## BT 16" Wheel with Stainless Steel Spokes

Front or rear wheel fits BT 1967-72.

70761



## Internal Bearing & Hardware Kit BT 1967-72

For 1967-72 front and rear hubs. Includes all parts necessary to build or rebuild a bare hub. Includes 3 bearings, tube spacer, seal, seal sleeve & hub lock (LH thread).

5749 Kit



## Chromed Wheel Lugs

Fit all 61"-74"-80"-45" 1936-72. Replaces OEM 43530-35A.

19227	Set of 5 (chrome)
19226	Set of 5 (black)



## Full Hub Cap, Front 8"

Use to dress up glide forks with stock hubs 1947-72 FLH.

6640	1948-66 Hub cap
6641	1967-72 Hub cap



# BT Wheels



## Chrome Wheel Assembly BT 1973-84

16" x 3.0" Wheel assembly is laced and trued with bearing installed. Assembly includes a drilled steel rotor, chrome 51T sprocket and chrome mounting bolts for each.

PCP	Rotor Size
70820	10"
70821	11-1/2"



## BT Chrome Rear Wheel Kit with 10" Rotors

Kit includes pieces shown to fit BT 1973-85. Kits include a chrome 16"x3" wheel assembly, chrome caliper, chrome 51T sprocket with bolts, 10" rear drilled rotor with bolts, chrome caliper bracket, and a chrome stay bar with bolts.

90500

6642



6643



## Chrome FL Front Wheel Hubcaps

A stylish chrome reproduction of FL front wheel 'caps' for laced wheels. Measures a full 8" in diameter

PCP	Fits
6642	1973-80 (43304-73)
6643	1981-84 (44463-82)

# BT Wheels



## Stock Wire Wheel Assembly

1973-84-FX-FL type, chrome steel hub laced and trued with all new chrome components.

PCP	Diameter	Rim Width
6283	16" Front and rear with chrome spokes	3.0"
6284	As above with stainless steel spokes	3.0"
6285	19" Front	1.85"
6286	19: OEM Front drop centre rim	2.50"
6287	21" Front for 5/16" holes (43664-80B)	1.85"

## Stainless Spoke Front Wheels

Completely assembled and trued with chrome components.

PCP	Diameter	Rim Width
6806	16" Chrome	3.5 Std. Rim 1980-83 FXWG Front
6807	16" Stainless	As above, 5/16" motor mount holes
6808	21" Stainless	1.85 Rim 1973-85 FL

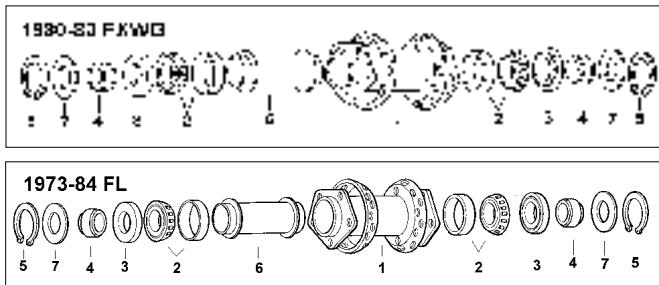

## FL Wheel Hub Parts 1973-84

PCP	Description
1 53001	Chrome comp. BT hub FL 1973-84 (43540-73)
5049	Chrome comp. hub FXWG 1980-83 2 Flange (5/16 brake holes) (43663-80A)
2 15504	Bearing and race 1973-99 (9052)
3 14067	Wheel seal 1973-82 (47519-58) (10 Pack)
14069	Wheel seal 1983-99 (47519-83A) (10 Pack)
4 2355	Wheel spacer FL's front & rear 1973-on FX's rear 1973-84 (41196-73)
5 11015	Wheel hub snap ring 1973-82 (11027) (10 pack)
6 2529	Wheel bearing spacer 1973-on orange 4.420 (43601-73)
2530	Wheel bearing spacer 1973-on yellow 4.434 (43602-73)
2531	Wheel bearing spacer 1973-on white 4.448 (43603-73)
7 3304	Wheel hub washer FX rear 1973-on (43559-73)

## Deluxe Rear Hub Rebuild Kit

For all FX-FL rear hubs 1973-82. Includes all internal parts, including longest length inner spacer (white 4.448"). Spacer may be cut down to shorten length for proper fitting on some applications. Genuine Timken Bearings supplied.

5745 Kit



## FLT 1980-81 Rear Wheel Needle Bearing

15612 Replaces 9116

# XL Rear Wheels



## Late XL Rear Wheel Assembly

16" type chrome rear wheel assembly for all 1979-on XL's. Laced and trued with new components. Assembly includes all internals.

PCP	OEM	YEARS
6125	43720-79	1979-81
6126	40951-82	1982-85

## XL Complete Stock Wheel Assembly

Replacement drum brake type XL rear wheel assembly. Laced and trued with new components. Use on all 1954-78 XL's. Chrome plated.

With Internals

PCP	Size
6127	16" x 3.0"



## XLCH-XLH Rear Hub Rebuild Kit

For use on all model steel hubs 1955-78, complete with all parts shown to install in a bare hub.

**59507**

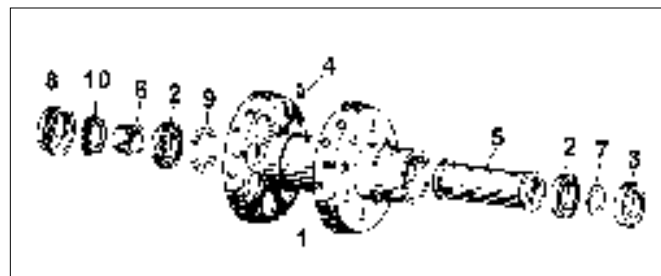

## Sportster Rear Wheel Hub Parts 1955-78

	PCP	Description
1	2336	Chrome hub only 1955-78 (41017-55C)
2	15712	Wheel bearing unshielded 55-78 (2 used) (9008)
3	15713	Wheel bearing shielded 1955-78 (9009)
4	10511	Grease fitting (9851) (10 pack)
5	3309	Wheel bearing spacer 1963-78 (41185-63)
6	2525	Hub spacer 1955-78 (41196-55)
7	3308	Small spacer washer, brake side 1963-78 (41195-63) (10 pack)
8	12570	Hub lock nut 1955-78 (41201-55)
9	3310	Large wheel bearing spacer washer 1954-78 (41205-52)
10	14057	Wheel hub seal 1955-78 (41210-55) (5 pack)

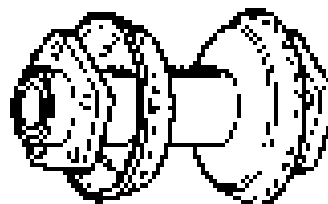

## Late XL Rear Hubs

1982-on Sportster rear hubs. Disc brake type. Chromed with all internals assembled.

**53013** XL 1982-85 (40952-82A)

# Wide Tire Related

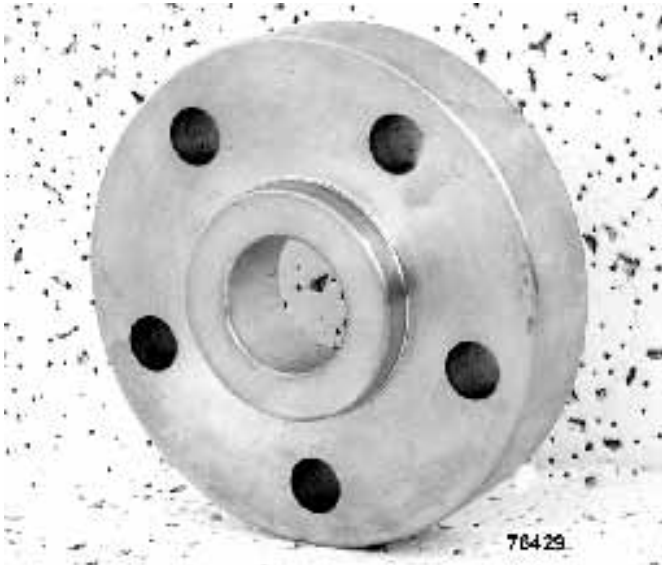

## Primary Spacer for Wide Tire Kit

Plain finished spacers fit between the engine and the inner primary when installing a wide tire. The appropriate transmission mounting plate and sprocket shaft extension are required.

## BT Rear Wheel Spacers (BDL)

PCP	Size	BDL
76427	.250"	RPS-0250
76428	.375"	RPS-0375
76429	.500"	RPS-0500
76430	.750"	RPS-0750
76431	.937"	RPS-0937 for use with BDL 1" pulley
76432	1.100"	RPS-1100 for use with CCI wheels
76433	1.250"	RPS-1250

PCP	Size
76456	.250"
76457	.500"
76458	.750"
76459	1.00"



## Spacer for BT Belt Drive Models 1980-85

This .200 thick spacer will allow the proper spacing between the rear belt pulley and the wheel. It can also be used to install custom wheels on BT and XL models 1983-85.

**11855** 40932-81



## Custom Wheel Covers

Polished aluminum covers provide a solid wheel look and install easily to any 16" spoke wheel with drop centre rim and disc or drum brake. 4-5/8" centre hole diameter. Not for use with mag wheels or narrow forks.

**45935**



## Speed Drive Adapter Kit 1973-84

Kit includes 2:1 ratio right side speedo drive, chrome hub cover and chrome axle with nuts. Fits single disc FL spoke hubs and cast wheels 1981-85 style. FXWG kit includes adapter flange, 2:1 ratio speedo drive and axle to fit 1980-83 FXWG dual disc spoke hubs.

PCP	Application
43300	FLH single disc
43301	FXWG dual disc

# Hub Parts



## Late Wheel Seal

Replaces OEM #47519-83A. Used on all 1983-99 models with cast or wire wheels. Sold in 10 packs.

**14069** .250"

## Wheel Seal

Fits wire wheel FX front 1973-78 except FXWG; XL front 1973-82 XL, rear 1979-82. Fits cast wheels FL front & rear 1973-79; FX front, all models 1974-82; XL front 1974-83; FX rear, all models 1973-82; XL rear 1979-82.

**14068** 47519-72 (10 packs)



**14067**

## Wheel Seals

Fits wire wheels, FL front & rear 1973-82; FXWG 1980-82; FXs rear 1973-82. Fits cast wheels FL front & rear 1980-82; FLT front & rear 1982; FXWG 1983. Repl. OEM #47519-58.

**14067** 10 Packs



## Front Wheel Bearing, Race and Seal Kit

Each kit contains two each, bearing, race and proper seals.

**PCP Fits:**

- 3510** 1980-on FXWG laced wheel  
1973-on FLH laced wheel  
1980-on FLH cast wheel
- 3511** 1973-79 FLH cast wheel  
1973-83 all FX-XL models cast or wire wheel  
1982-83 FXR's cast or wire wheel



## FX-FL Chrome Rear Hub 1973-84

OEM replacement 43540-73. Fits FL, FLH, FX, FXEF, FXEF-80, 1973-84. 3/8" hole disc side, 7/16" hole on brake side.

**6625** Chrome without internals

**53001** Chrome hub complete



## Flat Mini Hub Caps for Late Model Wheels

Measuring just over 2" in diameter, each one is held in place between the axle or swingarm and the wheel spacer.

**Sold each.**

**PCP Description**

- 45318** Fits the front of all FXWG 1980-83 and the rear of all 4-speed BT 1973-84

# Front Wheel

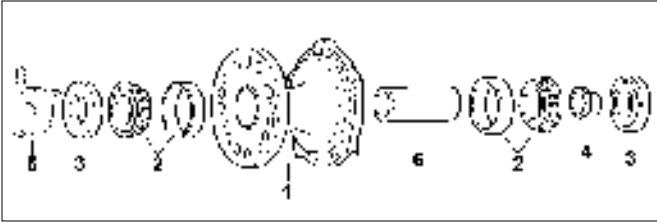

## FX & Sportster Front Wheel Parts 1974-77

- | PCP      | Description   |
|----------|---|
| 1. 3730  | Chrome hub assembly FX-XL 1974-77 (43600-74)        |
| 2. 15504 | Wheel bearing and race FX-XL 1973-on (9052)         |
| 3. 14068 | Wheel seal FX-XL 1973-82 (47519-72) (10 Pack)       |
| 4. 2353  | Wheel Spacer FX-XL 1974-77 (43548-74)               |
| 5. 2533  | Speedo drive unit XL 1973-79, FX 1973-79 (67127-73) |
| 6. 3737  | Wheel bearing spacer XL 1973-77 (43745-73)          |
| 3744     | Wheel bearing spacer FX 1973-77 (43634-74)          |



## Custom Wire Wheel Assembly 1974-77

OEM replacement #43600-74, clover type hub, wheels are laced then trued with new components. Internals and bearings are included. Fits FX, XL, XLCH 1974-77 only. 1 disc.

PCP	Diameter	Width	Hub
6139	19" Front	2.50" OEM	Chrome

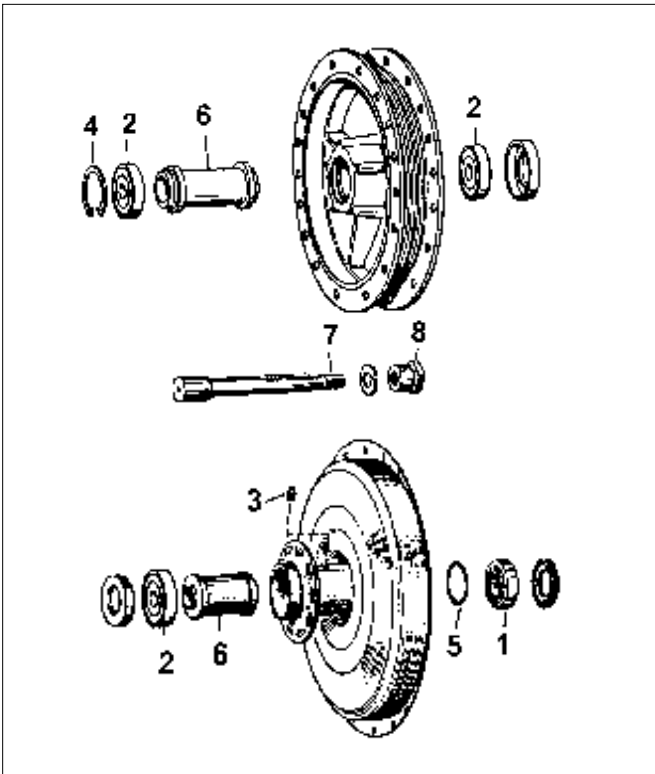

## Front Wheel - 1972 and Earlier, XL-FX

- | PCP      | Description                              |
|----------|--|
| 1. 15712 | 1954-63 Front bearing (9008)             |
| 2. 15713 | 1954-72 Ball bearing (shielded) (9009)   |
| 3. 10511 | 1954-63 Grease fitting (9851) (10 pack)  |
| 4. 11017 | 1964-72 Retaining ring (11035) (each)    |
| 5. 3310  | 1954-63 Bearing washer (41205-52)        |
| 6. 5076  | 1954-72 Wheel bearing spacer (43740-64)  |
| 7. 566   | 1952-72 Axle (chromed) (43871-52)        |
| 8. 565   | 1952-72, 1970-72 FXE Axle nut (43886-52) |



## 21" Chopper Style Wheels

Wheels come in spool or 3" wide mini brake design which includes anchor bar and cable. Both include 5/8" I.D. bearing.

- | PCP   | Description              |
|-------|--------------------------|
| 70776 | Mini-brake wheel         |
| 16099 | Shoes for above          |
| 70777 | Spool style wheel        |
| 15519 | Bearing for above (each) |

# Front Wheel



6142

## DD 1978-83 Custom Wire Wheel Assembly

Late dual disc type hub OEM #43600-78. Wheels are laced then trued, with new components. Bearings and internals are included. Fits FX, XL, XLS, FXEF, FXEF-80-82.

PCP	Diameter	Width	Hub
6142**	*19" Front	2.50" OEM	Chrome

\*NOTE: Includes bearings, seals and spacer. Pre-assembled.

\*\* To use on FXR late dual disc models where one piece spacer must be fitted



## Late FX-XL Front Wheel 1984-99

Complete front wheel assembly for all 1984-99 FX-XL-FXR's. Laced and trued with all new components. Chrome plated.

6143 19" OEM (drop centre rim) 2.50", 1 or 2 disc

6144 21" Custom with 2.15" rim

The 2.50" OEM rim is the stock factory type 43018-73.



16581



16580

## Rear Wheel Spacers

Fits BT 1982-99 models.

16580 4.308" Spacer for wide hub (43608-82)

16581 Spacer washer (43650-82)

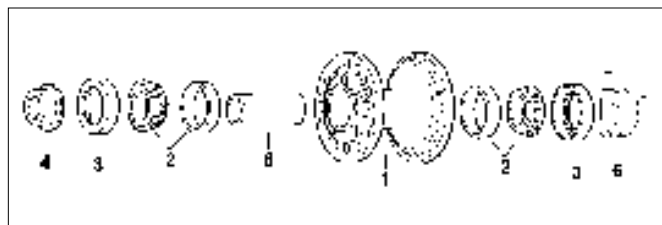

## FX & Sportster Front Hub & Parts 1978-on

	PCP	Description
1	2532	Chrome dual disc hub assembly FX, XL 1978-83 (43600-78)
2	15504	Bearing and race FX, XL, 1973-on (9052) (pair)
3	14068	Wheel seal FX-XL 1973-82 (47519-72) (10 pk)
	14069	Wheel seal FX-XL 1983-on (47519-83A) (10 pk)
4	2354	Wheel spacer dual disc FX-XL 1978-83 (43488-77)
	3733	Right side FXWG 1983 (41607-83)
5	2533	Speedo drive unit XL 1973-83, FX 1973-79, 1981-83 (67127-73)
	3306	Speedo drive unit FX models 1980 (not FXWG) (67124-80)
	3722	Speedo drive unit FXR, FXRT, FXSB, FXE-80, XL, XLS, XLX 1984-on (67127-84A)
6	3305	Wheel bearing spacer, violet 2.564" long, FX 1978-on (43623-78)
	3736	Wheel bearing spacer, pink 2.550" long, FX 1978-83 (43624-78)
	3740	Wheel bearing spacer, gold 2.536" long FX 1978-83 (43625-78)



## 21" Wheel Assemblies

21" wheels give Harleys the late FXST-FXWG look. Available for all years and models, laced and trued, complete with bearings. Ready to install. Rim is 1.85 x 21, not drop centre.

PCP	Application	Type
6287	1973-84 FL-FLH	1 or 2 Disc
6140	1978-82 FX-XL-FXR	2 Disc

# Hub Caps



## Chrome Hubcaps for 4-Speed FL Models

The perfect accessory for the front wheel of all FXWG from 1980-on, or 1981-84 speed FL models with cast wheels.

**45014** 4-1/2" diameter hub cap, fitting the cast wheels on FL models 1981-84 (OEM 44443-81).

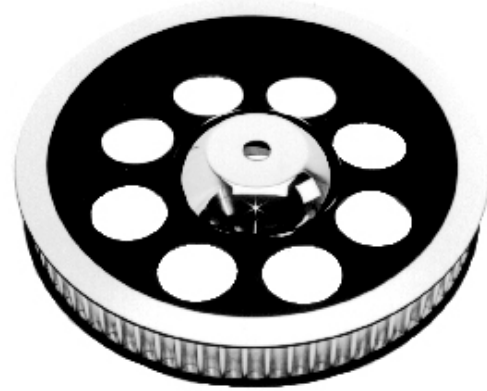

## Chrome Rear Hubcap for Belt Drive Models

A neat way to decorate the rear pulley area of all BT belt drive models while hiding the stock mounting hardware. The hub cap is held in place between the axle spacer and swingarm. This 4-1/2" hub cap looks great with stock pulleys but better yet when installed with PCP chrome inserts and belt guard.

**45015** Fits all BT models with rear belt drive 1980-on.



## Chrome Rear Die Cast Hubcaps 1980-on

Allen type, features counter bored holes with socket head screws. Front attaches by 2 screws on FXWG, rear attaches by 5 Pulley Allen Screws, included. Rear fits cast or solid wheel on 1980-on with belt drive.

**45017**



## Full Hub Cap, Front 8"

Use to dress up glide forks with stock hubs 1947-72 FLH.

**6640** 1948-66 Hub cap

**6641** 1967-72 Hub cap

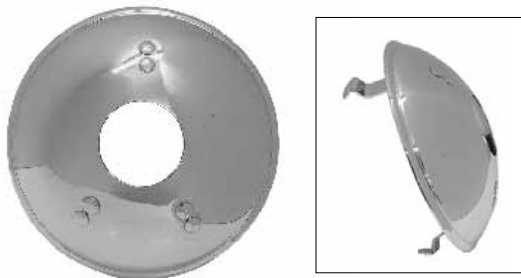

## Nostalgic Style Hub Caps

OEM replacement #11260-46. Fits all "74", "80" models. 1936-1973, front & rear. Chrome plated snaps on with three prong mounts. Excellent for restoration.

**2211**

## Chrome FL Front Wheel Hubcaps

A stylish chrome reproduction of FL front wheel 'caps' for laced wheels. Measures a full 8" in diameter

**PCP** **Fits**

**6642** 1973-80 (43304-73)

**6643** 1981-84 (44463-82)



# Front Axles



## Chrome Allen Cap Kits

Each kit contains the necessary number of chrome axle caps required for your application.

### Front

PCP	Description
44313	3 Pieces FL 1949-71
44311	2 Pieces FL 1972-88, FXWG 1980-94,
44310	1 Piece FL/FLT 1973-80, FX 4 speed (except FXWG) 1981-85, FXR 1982-87 (not FXLR or Sport Edition), XL 1973-87

### Rear

PCP	Description
44314	2 Piece FL/ FLT 1973-80, XL 1957-80, FX 4 speed 1973-80, FXWG 1980-81
44315	2 Piece FL 4 speed 1981-88, FX 4 speed 1981-85, FXR 1982-88, XL 1981-88, FXWG 1982-86, FLH/T 1980-88

## Ball Axle Cap Kits

Touch of class for FL-FLH 1972-on Glide forks, sold as pair.

426



## FLH Axle Nut

Cad plated stock type front axle nut. Replaces OEM # 7734W.

12507 Sold each



## Colony Chrome Front Axle Cover

Chrome plated covers add a smooth finished look and are easily installed with a set screw. Sold in sets of 2 to fit FL 1972, FL 4 speed 1973-84, FL, FLHT 1980-on and FXWG 1980-86. Fits most 1/2-20 threaded axles.

72120



## Chrome Front Axles

Size is measured from inside of head to start of threads

PCP	Fits
3675	EL, FL and UL 1932-47 (9") (43872-36)
567	EL and FL 1948-66 (8 3/16") (43875-48)
568	FL models 1967-71 (9 5/8") (43875-67)
569	4-speed FL 1973-80, and FXWG 1980-83 (9 5/8") (43875-73)
3677	FL 1981-84 (43346-83)
566	Sportster® and K models 1952-72, FX 1971-72 (5 1/8") (43871-52)
570	Sportster® and FX models with single disc brake 1973-77 (6 3/8") (43871-73)
571	Sportster®, FX and FXR models with dual disc brake 1977-83 (7") (43883-77)
3679	Sportster® and FXE with 35mm forks 1984-86 (6 1/2") (43883-84)



## Stock FL Front Axle

Cadmium plated axle replaces OEM #43875-73. Use on all 1973-80-FL, FLH and 1980-83 FXWG.

5069



## Front Axle Nut Kit FL 1949-72 Drum

Another quality hardware kit offered by Colony to make the older Harleys look better and stay together longer. Kit contains 1 each of the following: castle axle nut, sleeve nut, and cotter pin.

554 Chrome  
5198 Cad

## Front Axle Nut & Washer Kit

Chrome plated machined steel washer, hex nut, and stainless steel lockwasher fits Harley Wide Glide, FX, or Sportster.

2057 Fits FX, Sportster 1973-79  
5360 Fits Wide Glide 1972-on

# Front Axle

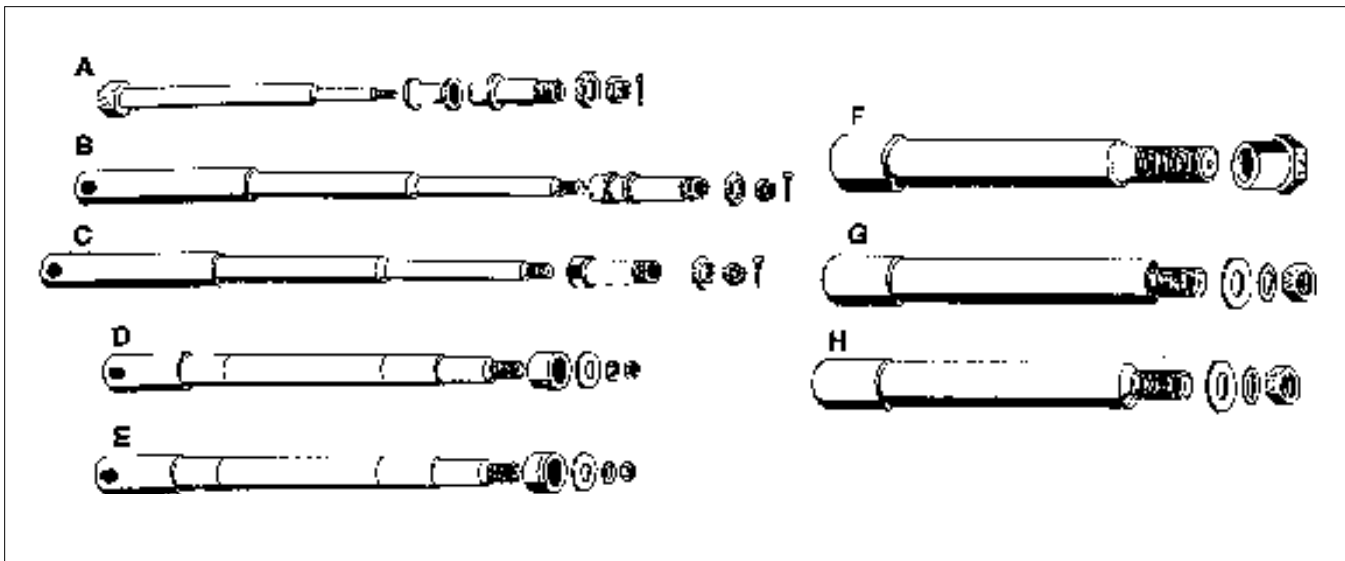

## Front Axle Kits

Contain plated axle, nut, spacer, and axle sleeve when required.

#	PCP Kit	Description	PCP Spacer	PCP Nut	PCP Axle	Axle OEM	Finish
A	43322	Springer BT 1936-48 with sleeve	19001	554	3675	43872-36	Chrome
	43323	Black axle as above	19192	9406	19044	(Black)	Black
B	43324	FL Glide 1948-66 with sleeve		554	567	43875-48	Chrome
	43325	Zinc axle as above		5198		43875-48	Zinc
C	43326	FL Glide 1967-71 with sleeve		554	568	43875-67	Chrome
D	43327	FL Glide 1973-80, FXWG 1980-83	2056	5360	569	43875-73	Chrome
E	43328	FLH 1981-85	2056	5360	43321	43867-81	Chrome
F	43330	XL 1952-72, FX 1970-72 (zinc)		565	566	43871-52	Chrome
G	43331	XL, FX 1973-77		2057	570	43871-73	Chrome
H	43332	XL 1978-83, FXE 1977-83		2057	571	43883-77	Chrome



## Front Axle Sleeve

564 Brake side EL, FL, FLH 1949-66 (43882-48)  
562 BT FL 1967-71 (43882-67)

## Front Axle Sleeve

Springer 1936-47 (43882-36).  
19000



## Front Axle Nut

Chrome plated front axle nut.  
Sportster 1952-72 FX, FXE 1970-72.  
Replaces 43886-52.  
565



## Speedo Drive Spacer

Replaces speedo drive on all 1973-on FX-XL-FXR when front wheel drive is omitted.

5068 FX, XL 1973-on



## Front Axle Spacers (sold Each)

PCP Right Side Application  
19001 BT 1932-47 chrome (43884-36)  
3733 FXWG 1983 zinc (41607-83)

PCP Left Side Application  
2056 FL, FLH, FLH-80 1973-86, FXWG Classic 1980-82 left zinc (41594-73)

# Rear Axles



## Chrome Rear Axles

Size is measured from inside head to start of threads

PCP	Fitment
3681	45" 1935-52 <b>Black</b> (9 1/4") (41551-41)
576	EL, FL, UL 1936-57 (9 5/8") (41552-36)
575	FL 1958-66 (10") (41552-58A)
574	FL, 1967-72, FX 1971-72 (10 1/8") (41552-67)
2052	FL, FLH, FX 1973-85 (10 7/8") with rear chain drive (41552-73)
3683	FL, FX, with belt 1980-86 (11 1/4") (41580-79)
5071	FXR models 1982-on (except 83-84 FXRT), FLT 1980-on (11 3/8") (41110-79A)
577	Sportster 1952-78 (41551-52)
5072	Sportster 1979-87 (10 1/4") (41563-77)



## Rear Axle Nut and Lock Kit

Rear axle kit contains 1 each of the following: sleeve nut, sleeve collar, axle nut, and axle nut lockwasher.

555	BT 1936-72 chrome
5197	As above, cad
19008	45 Solo 1941-52 chrome
19009	As above, cad
9688	As above, parkerized
9610	VL 1930-36 chrome
9611	As above, parkerized

## Rear Axle Nut & Washer Kit

Chrome plated heavy duty machined steel washers prevent distortion of square swingarms on all Big Twins 1973-on and Sportster 1979-on.

5306 Kit



## Rigid Frame Disc Brake Rear Axle

For use when 1973-on rear disc brake units are installed on rigid frames. Kit includes .750 diameter axle, nut, special spacer and washers. Other axles sold separately. Spacers may have to be cut to length. Length of axle includes threads.

PCP	Item	Length	Type
3687	Kit	10.5"	BT rigid chain, XL
43318	Axle	12"	Rigid with belt
3689	Axle	11.5"	Rigid chain
43313	Axle	12.5"	Rigid frame w. disc brake
43317	Axle	12.5"	As above for Swingarm
5073	Collar	1-5/16"	Long (pair)
43104	Collar	1-13/16"	Long (each)
43106	Collar	2 3/4"	Long (each)



## Rear Axle Parts

Chrome plated Harley rear axle nut and washers. Harley FL, FLH 1972-79, FX, FXE, FXS 1973-79. Replaces 7986, 7022, 6653 Sportster 1952-79.

2057	Kit
5074	Chrome nut 5/8-18 (5 pack)



## Colony Rear Axle Nut Kits

Mounting kits for the rear axle on Big Twin models 1973-88, and Sportster® models 1979-88. Available in acorn or custom cap-nut style.

5278	Acorn style
5279	Cap-nut style

# Rear Axle

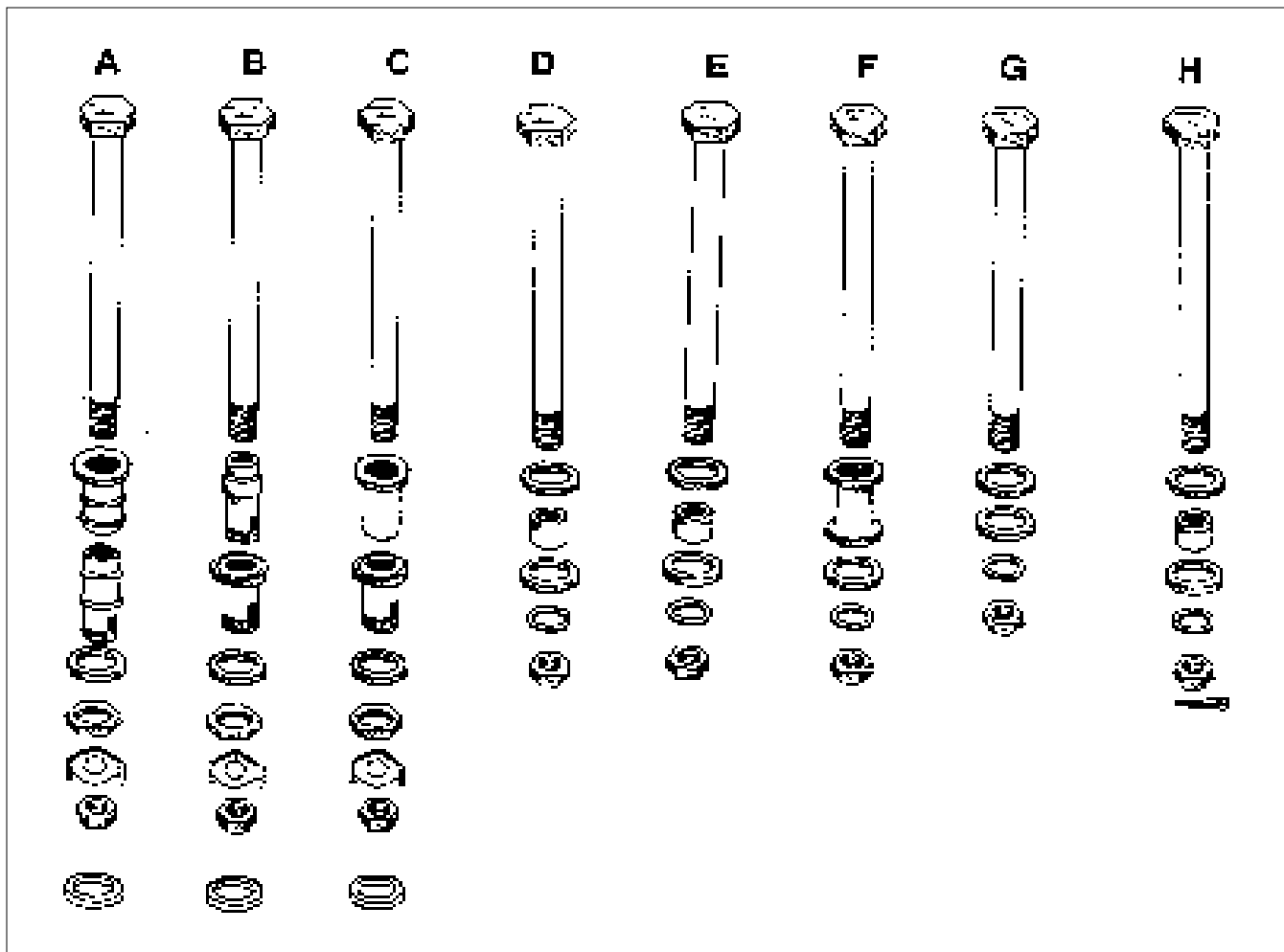

## Rear Axle Kits

Kits contain: chrome axle, nuts, sleeves, and spacers for each application. Nut kit includes chrome axle nuts and outer sleeve. Sleeve is included in items A, B, and C.

#	Compl. Kit	Spacer	Sleeve	Nut Kit	Axle	Axle OEM#	Description
A	43340	559	550	555	576	41552-36	Rigid BT 1936-57
A	43341	16577	550		43213	41552-36	As above, Parkerized
A	43342	16578	19023	9688	3681	41551-41	45" Solo 1941-52, black
A	43343	19057	19023	19008	43214	41551-41	As above, chrome
B	43344	560	551	555	575	41552-58A	FL, BT 1958-62
B	43345	560	552	555	575	41552-58A	FL, BT 1963-66
C	43346	561	553	555	574	41552-67	FX-FL 1967-72
D	43347			5306	2052	41552-73	FX-FL 1973-85, FXWG 1980-83
E	43348	16571		5306	3683	41580-79	FL1982-84, FX 1980-86 4 speed w/rear belt
F	43349	563		2057	577	41551-52	XL 1952-78
G	43350			5306	5072	41563-77	XL 1979-87
H	43352	16572		5306	5071	41110-79A	FXR 1982-94

**Note:** 43345 45 Kit has OEM finish axle with parkerized nuts and black spacer  
 43344 Includes side plate spacer # 556 (41596-58)  
 43345 Includes side plate spacer # 557 (41596-63)  
 43346 Includes side plate spacer # 557 (41596-63)

# Axle Sleeves



## Collar, Axle Sleeve

Chrome plated Harley rear axle sleeve collar.

PCP	Fits
558	61", 74", 80" 1936-72, FX 1971-72 (41596-30)
2054	Sportster 1952-77 (41598-52)



## Rear Axle Sleeve

For mechanical and hydraulic rear brake backing plate. Plain finish.

PCP	Fits
550	61", 74", 80" 1936-57 (41600-36)
551	FL, FLH 1958-62 (41600-58)
552	FL, FLH 1963-66 (41600-63)
553	FL, FLH 1967-72, FX 1971-72 (41600-67)
19023	45", 1941-52. 45 Solo (41718-41)



## Rear Axle Spacer (Outer)

PCP	Fits
19057	All 45's left 1935-52 parkerized (41593-38)
563	Sportster left side 1952-78 chrome (41600-55)
559	61, 74, 80 BT 1936-57 chrome (41595-36)
560	All BT 1958-66 chrome (41595-58)
561	FL 1967-72, FX 1971-72 zinc (41595-67)
2053	All FL left cast/wire 1973-82, FX, FXE, FXEF/-80, FXWG left wire wheel 1973-83, FXE-80 wire 1981-86, FX cast 1973-86 zinc (41595-73)
16571	1982 Classic only, FLH-80 1982-84 cast or wire, FXB, FXSB 1980-86 cast wheel zinc (41592-79)
16572	FXR 1981-91 left side cast or wire wheel (41591-81)



## Brake Drum Side Plate Spacer

Axle sleeve side spacer. Left side of swing arm

PCP	Fits
556	FL, FLH 1958-62 (41596-58) chrome
557	FL, FLH 1963-72, FX 1971-72 (41596-63) zinc



## Grease Fittings 5/16 x 32 Thread

PCP	Description
10511	Zinc 1938-on (9851) (10 pack)
10513	Zinc, angle 1938-on (9852) (5 pack)
10515	Zinc 1979-84 (25715-47) (10 pack)



## Wheel Hub Inner Bearing Spacer Tube

Available for all 1935-up Twins.

PCP	Fits
1307	1936-66 front & rear FL (43549-36)
2526	1967-72 front & rear FL 1971-72 FX rear only (43549-67)
5076	1971-72 FX, 1954-72 XL front (43740-64)
3744	1973-77 FX, XL 2.177" long, front only (43634-74)
3305	1978-on FX, XL front only 2.564" long (43623-78)
2531	1973-on FL front & rear 1973-on rear all FX models 1980-on FXWG front 1982-on XL rear (43603-73)
3309	1963-78 XL rear only (41185-63)

# Axle Spacers

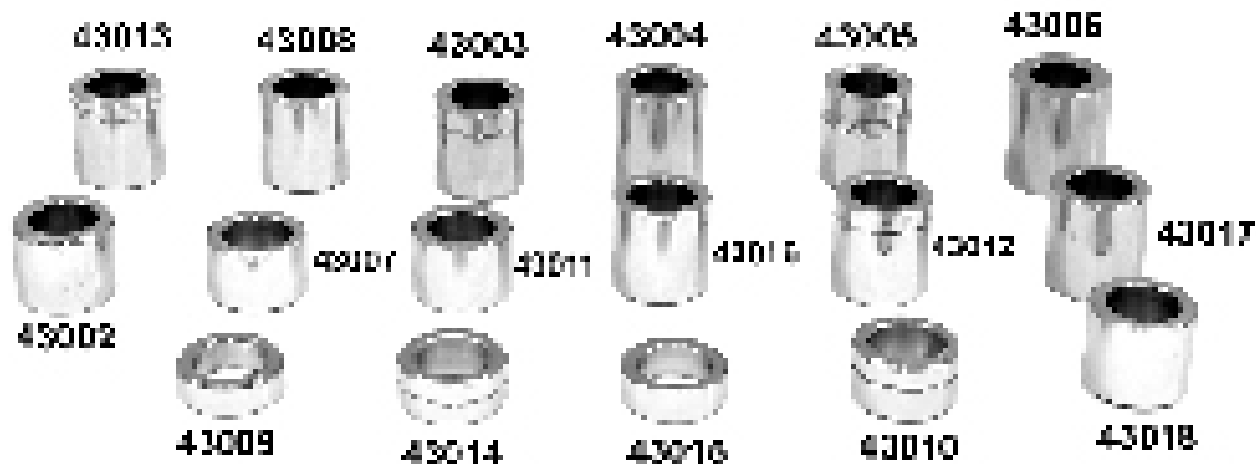

## Chrome Axle Spacers

Sold each.

PCP	OEM	ID	Length
43002	43617-95	.750	.930
43003	40915-94	.720	1.253
43004	43674-95	.725	1.412
43005	43683-97	.730	1.350
43006	41591-90	.740	1.435
43007	43654-86A	.750	.750
43008	40910-84A	.750	1.255
43009	43358-83A	.750	.480
43010	41594-73	.745	.655
43011	41595-73	.750	.830
43012	41592-79	.745	1.210
43013	41595-86	.730	.1225
43014	41607-83	.735	.510
43015	47517-58	.745	1.210
43016	41591-81	.710	1.265
43017	43648-86	.735	1.370
43018	43657-89	.725	1.050

PCP	OEM	ID	Length
43019	(40910-00)	.740	.900
43020	(41595-00)	.750	1.980
43021	(43683-00)	.740	.990
43022	(43654-00)	.750	.580
43023	(43617-00)	.750	.520
43026	(43613-00)	.755	3.040
43025	(43608-00)	.745	4.810
43024	(43517-00)	1.00	4.810

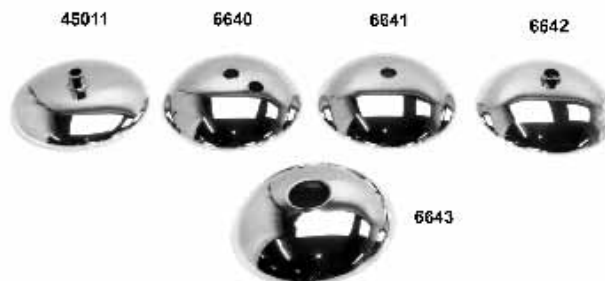

## Chrome FL Front Wheel Hubcaps 8"

Full 8" dresser hub cap for wire wheels on 1949-on wide glide type forks.

PCP	Fits
45011	Front springer hub cap FL 1936-47 (43300-48)
6640	Hub cap w/grease hole, FL 1949-66 (43303-49)
6641	Hub cap w/o grease hole, FL 1967-72 (43304-67)
6642	Hub cap for laced wheels. FL 1973-80 (43304-73)
6643	Hub cap for laced wheels. FL 1981-84 (44463-82)



## Rear Axle Seal Spacers 1973-on (Sold Each)

PCP	Application
2355	1979-81 XL Right side only cast or wire wheel, 1973-82 FX, FXE FXEF, FXEF-80, FXE-80, FLH cast wire wheel (41196-73) (pair)
5063	1982-86 FXR cast or wire wheel, 1982-85 XL left side only cast or wire wheel, 1982-86 FXWG wire wheel, 1982-only FXS-80, wire wheel 1982-86 FXB, FXSB cast wheel (40906-82)
5064	1979-81 Left side only cast/wire wheel (41202-79)
3517	1983-86 FLH-80 wire wheel (41196-83)
5066	E1979 XL, XLCH, XLS outer right cast wheel 1-1/2" (41203-79)